

## ST ALBANS HOMESTEAD



ST ALBANS HOMESTEAD  
SOHE 2008



ST ALBANS HOMESTEAD  
SOHE 2008



ST ALBANS HOMESTEAD  
SOHE 2008



ST ALBANS HOMESTEAD  
SOHE 2008



ST ALBANS HOMESTEAD  
SOHE 2008



ST ALBANS HOMESTEAD  
SOHE 2008



1 st albans homestead  
whittington front view apr1997

EXTENT OF DESIGNATION  
(SUMMARY)

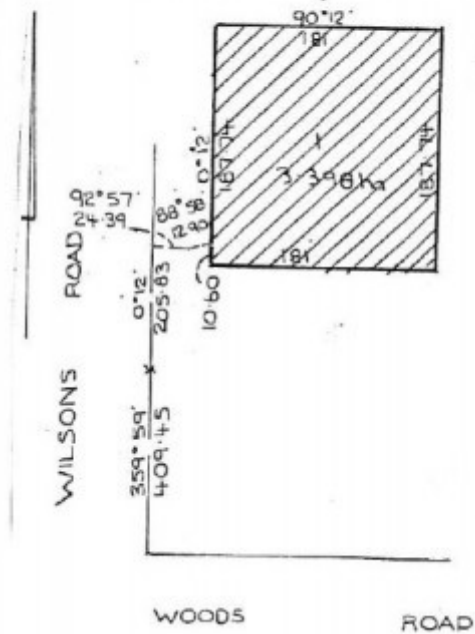

H0741 H0741 plan

**Location**

6-30 HOMESTEAD DRIVE ST ALBANS PARK, GREATER GEELONG CITY

**Municipality**

GREATER GEELONG CITY

**Level of significance**

Registered

**Victorian Heritage Register (VHR) Number**

H0741

**Heritage Overlay Numbers**

HO378

**VHR Registration**

October 25, 1989

**Heritage Listing**

## Statement of Significance

Last updated on - June 28, 1999

St Albans Homestead at Whittington, a single storey 30-roomed brick mansion, was erected in 1873 for the noted race horse breeder and trainer James Wilson. The Melbourne architect James T Conlan designed the extensive homestead in the fashionable polychromatic mode with an elaborate cast iron verandah by Geelong foundry men Humble & Co.

There were additions to the homestead in 1875 designed by Conlan and, in 1878, alterations and additions designed by Conlan and Salway. The homestead was identified as a significant building in the Geelong Regional Commission Study and has been recorded by the National Trust. The integrity of the property is high. St Albans has both historical and architectural significance for the following reasons:

- (1) it is a most distinctive work of the architect JT Conlan.
- (2) it is of significance as one of the leading horse racing studs in Australia in the late 19th century.
- (3) many Melbourne cup runners were trained on the St Albans track. The legendary Phar Lap stayed briefly at St Albans stud in 1930 on the eve of his celebrated Melbourne Cup victory.

[Source: Historic Buildings Council]

## Permit Exemptions

### General Exemptions:

General exemptions apply to all places and objects included in the Victorian Heritage Register (VHR). General exemptions have been designed to allow everyday activities, maintenance and changes to your property, which don't harm its cultural heritage significance, to proceed without the need to obtain approvals under the Heritage Act 2017.

**Places of worship:** In some circumstances, you can alter a place of worship to accommodate religious practices without a permit, but you must [notify](#) the Executive Director of Heritage Victoria before you start the works or activities at least 20 business days before the works or activities are to commence.

**Subdivision/consolidation:** Permit exemptions exist for some subdivisions and consolidations. If the subdivision or consolidation is in accordance with a planning permit granted under Part 4 of the *Planning and Environment Act 1987* and the application for the planning permit was referred to the Executive Director of Heritage Victoria as a determining referral authority, a permit is not required.

Specific exemptions may also apply to your registered place or object. If applicable, these are listed below. Specific exemptions are tailored to the conservation and management needs of an individual registered place or object and set out works and activities that are exempt from the requirements of a permit. Specific exemptions prevail if they conflict with general exemptions.

Find out more about heritage permit exemptions [here](#).

Construction dates	1873,
Architect/Designer	Conlan, James T,
Heritage Act Categories	Registered place,
Hermes Number	1213
Property Number	

---

## History

Associated People:

## Extent of Registration

### AMENDMENT OF REGISTER OF HISTORIC BUILDINGS

Historic Building No. 741-

St Albans Homestead Complex, Whittington

To the extent of: All of the buildings and the land shown hatched which is included in the Register Book

Certificate of Title Volume 9366, Folio 159.

[Victoria Government Gazette No. G42 25 October 1989 p. 2741]

*This place/object may be included in the Victorian Heritage Register pursuant to the Heritage Act 2017. Check the Victorian Heritage Database, selecting 'Heritage Victoria' as the place source.*

*For further details about Heritage Overlay places, contact the relevant local council or go to Planning Schemes Online <http://planningschemes.dpcd.vic.gov.au/>*