

MIHARO



MIHARO SOHE 2008



MIHARO SOHE 2008



1 miharo noble street
newtown front view sep1995

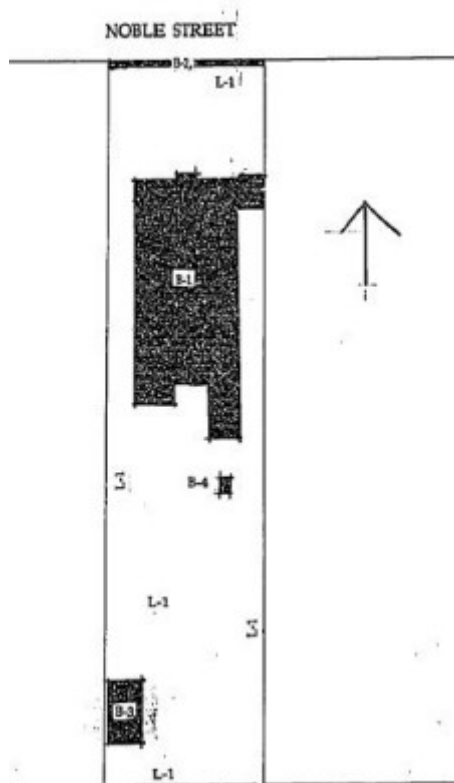

h01137 plan h1137

Location

145 NOBLE STREET NEWTOWN, GREATER GEELONG CITY

Municipality

GREATER GEELONG CITY

Level of significance

Registered

Victorian Heritage Register (VHR) Number

H1137

Heritage Overlay Numbers

HO201

VHR Registration

December 14, 1995

Heritage Listing

Victorian Heritage Register

Statement of Significance

Last updated on - May 5, 1999

Miharo is a single storey elaborately decorated stuccoed brick villa of Victorian filigree style. Miharo was constructed in stages, and grew from being a brick house of two rooms in 1855-56 to its current form of ten rooms which dates from 1890-91. The decorative verandah, facade and conservatory which give the Miharo its present appearance, date from additions of 1890 for soap manufacturer John MacLeod designed by Melbourne architects Beswicke and Coote.

Miharo is of aesthetic, architectural and historical significance to the State of Victoria.

Miharo is of aesthetic importance for the outstanding jewel-like decoration of the leaded and coloured glass domed roof conservatory, for the filigree facade with its paired cast iron columns, lace brackets, valance and handrail brackets, and the central decorative timber gable to the verandah, and for the fine display of pressed metal ceilings. Miharo is important as an extraordinary example of the work of Melbourne architects, Beswicke and Coote, and is the only known Geelong example of their work.

Miharo is important for its association with the Australian industrialist John MacLeod, who established a soap factory on the Barwon River at Marnock Vale in 1886. The factory was well known for its "Magic Soap" brand, and also produced "Heart and Arrow", "Pink Borax" and "Blanketta" soaps. The head office and warehouse were located in Market Street, Melbourne and there was a branch factory at Glebe Point in Sydney. The soap was also exported to China and Ceylon. Miharo was transformed to its present form during John MacLeod's period of occupancy.

Permit Exemptions

General Exemptions:

General exemptions apply to all places and objects included in the Victorian Heritage Register (VHR). General exemptions have been designed to allow everyday activities, maintenance and changes to your property, which don't harm its cultural heritage significance, to proceed without the need to obtain approvals under the Heritage Act 2017.

Places of worship: In some circumstances, you can alter a place of worship to accommodate religious practices without a permit, but you must **notify** the Executive Director of Heritage Victoria before you start the works or activities at least 20 business days before the works or activities are to commence.

Subdivision/consolidation: Permit exemptions exist for some subdivisions and consolidations. If the subdivision or consolidation is in accordance with a planning permit granted under Part 4 of the *Planning and Environment Act 1987* and the application for the planning permit was referred to the Executive Director of Heritage Victoria as a determining referral authority, a permit is not required.

Specific exemptions may also apply to your registered place or object. If applicable, these are listed below. Specific exemptions are tailored to the conservation and management needs of an individual registered place or object and set out works and activities that are exempt from the requirements of a permit. Specific exemptions prevail if they conflict with general exemptions.

Find out more about heritage permit exemptions [here](#).

Construction dates	1890,
Architect/Designer	Beswicke & Coote,
Heritage Act Categories	Registered place,
Hermes Number	2012
Property Number	

Extent of Registration

AMENDMENT OF REGISTER OF HISTORIC BUILDINGS

Historic Building No. 1137.

Miharo, 145 Noble Street, Newtown, City of Greater Geelong.

Extent:

To the extent of:

1. All the buildings known as Miharo comprising the main house marked B-1, the fence and gate to Noble Street marked B-2, the former stables marked B-3, and the garden shed marked B-4 on Plan 601129 endorsed by the Chair, Historic Buildings Council and held by the Director, Historic Buildings Council.
2. All of the land described in Certificate of Title Volume 2338 Folio 555, marked L-1 on Plan 601129 endorsed by the Chair, Historic Buildings Council and held by the Director, Historic Buildings Council.

[*Victoria Government Gazette* No. G49 14 December 1995 p.3548]

This place/object may be included in the Victorian Heritage Register pursuant to the Heritage Act 2017. Check the Victorian Heritage Database, selecting 'Heritage Victoria' as the place source.

For further details about Heritage Overlay places, contact the relevant local council or go to Planning Schemes Online <http://planningschemes.dpcd.vic.gov.au/>