

BALLARAT MUNICIPAL OBSERVATORY



BALLARAT MUNICIPAL
OBSERVATORY SOHE 2008



BALLARAT MUNICIPAL
OBSERVATORY SOHE 2008



BALLARAT MUNICIPAL
OBSERVATORY SOHE 2008



BALLARAT MUNICIPAL
OBSERVATORY SOHE 2008



BALLARAT MUNICIPAL
OBSERVATORY SOHE 2008



BALLARAT MUNICIPAL
OBSERVATORY SOHE 2008



BALLARAT MUNICIPAL
OBSERVATORY SOHE 2008



ballarat municipal observatory
front view

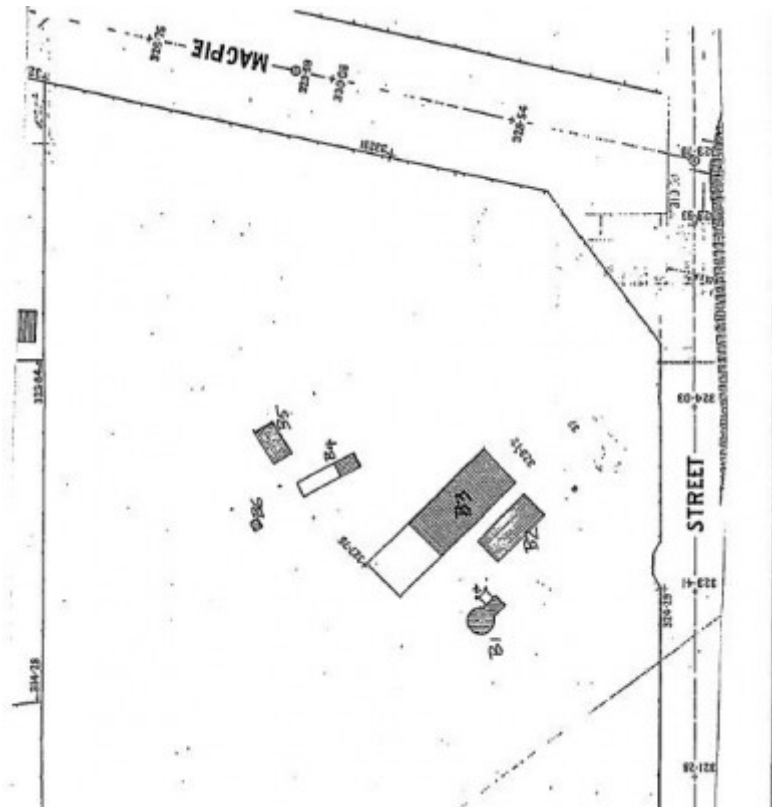

h00936 plan h0936

Location

439 COBDEN STREET MOUNT PLEASANT, BALLARAT CITY

Municipality

BALLARAT CITY

Level of significance

Registered

Victorian Heritage Register (VHR) Number

H0936

Heritage Overlay Numbers

HO88

VHR Registration

August 19, 1992

Heritage Listing

Statement of Significance

Last updated on - February 1, 2000

The Ballaarat Observatory, founded in 1884, is the oldest known, most intact municipal observatory extant in Victoria. The Ballaarat Observatory demonstrates the influence, wealth and talent operating in an important city like Ballaarat over a period of many decades. It demonstrates the level of support and enthusiasm of the local community, evident not only in the donations and expertise which brought about the equipping and construction of the observatory, but also, perhaps more particularly, identified in the stained glass windows which are a feature of the Jelbart, Oddie and Baker buildings. In this way it reveals a commitment of the many groups in the local community to sciences, and in particular to astronomy.

The Ballaarat Observatory is also indicative of the interest in the sciences, specifically astronomy, which existed in the late nineteenth and early twentieth centuries in Victoria. The Ballaarat Observatory is significant as a complex comprising a collection of uncommon building types, the Jelbart Observatory in particular being an early functionalist building. The run off building, radio hut and weather station have been altered.

Permit Exemptions

General Exemptions:

General exemptions apply to all places and objects included in the Victorian Heritage Register (VHR). General exemptions have been designed to allow everyday activities, maintenance and changes to your property, which don't harm its cultural heritage significance, to proceed without the need to obtain approvals under the Heritage Act 2017.

Places of worship: In some circumstances, you can alter a place of worship to accommodate religious practices without a permit, but you must **notify** the Executive Director of Heritage Victoria before you start the works or activities at least 20 business days before the works or activities are to commence.

Subdivision/consolidation: Permit exemptions exist for some subdivisions and consolidations. If the subdivision or consolidation is in accordance with a planning permit granted under Part 4 of the *Planning and Environment Act 1987* and the application for the planning permit was referred to the Executive Director of Heritage Victoria as a determining referral authority, a permit is not required.

Specific exemptions may also apply to your registered place or object. If applicable, these are listed below. Specific exemptions are tailored to the conservation and management needs of an individual registered place or object and set out works and activities that are exempt from the requirements of a permit. Specific exemptions prevail if they conflict with general exemptions.

Find out more about heritage permit exemptions [here](#).

Construction dates	1918,
Architect/Designer	Finch, FH,
Heritage Act Categories	Registered place,

Other Names	Observatory, Ballarat Observatory, Ballaarat Observatory,
Hermes Number	80
Property Number	

Extent of Registration

AMENDMENT OF REGISTER OF HISTORIC BUILDINGS

Historic Building No. 936.

Ballaarat Municipal Observatory, Magpie Street, Ballaarat.

To the extent of:

1. All of those buildings, works and structures known as Ballaarat Municipal Observatory including the Jelbart Observatory, the Oddie Observatory, the Baker Observatory, the Run-off Building and rails, the Radio Hut, the Weather Station marked B-1 to B-6 inclusive on Plan 6003369(B) endorsed by the Chairperson, Historic Buildings Council and held by the Director, Historic Buildings Council.
2. All the land marked L-1 on Plan 6003369(A), being Crown Land Reserve RS1504 Gazettal 84.3129 with extension Gazettal 44.2169 endorsed by the Chairperson, Historic Buildings Council and held by the Director, Historic Buildings Council.

[Victoria Government Gazette No. G32 19 August 1992 p.2357]

This place/object may be included in the Victorian Heritage Register pursuant to the Heritage Act 2017. Check the Victorian Heritage Database, selecting 'Heritage Victoria' as the place source.

For further details about Heritage Overlay places, contact the relevant local council or go to Planning Schemes Online <http://planningschemes.dpcd.vic.gov.au/>