

TINTERN



TINTERN SOHE 2008



TINTERN SOHE 2008



1 tintern tintern avenue toorak front view

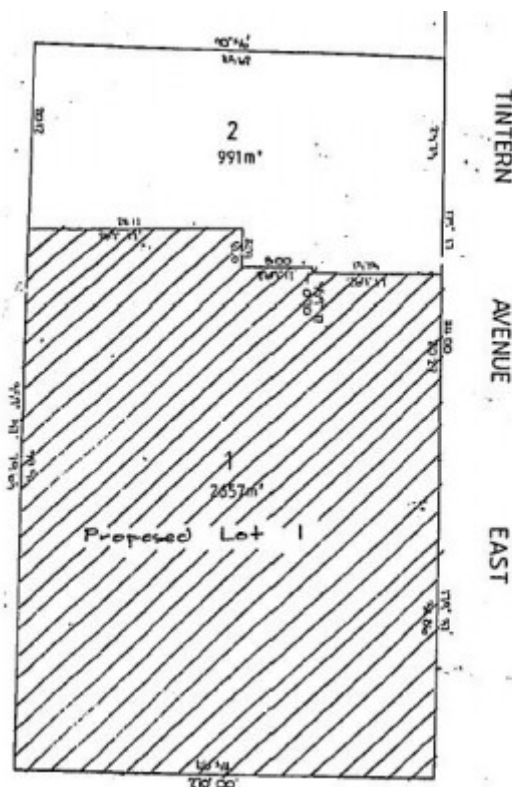

h00208 plan h00208

Location

10 TINTERN AVENUE TOORAK, STONNINGTON CITY

Municipality

STONNINGTON CITY

Level of significance

Registered

Victorian Heritage Register (VHR) Number

H0208

Heritage Overlay Numbers

HO105

VHR Registration

October 9, 1974

Amendment to Registration

January 22, 1992

Heritage Listing

Victorian Heritage Register

Statement of Significance

Last updated on - September 15, 1999

What is significant?

Tintern is a single storey mansion erected in 1855 for William Westgarth. The oldest part of the house is a ten room portable iron dwelling, manufactured by W. and P. McLellan of Glasgow and erected in 1855. Between 1870 and 1894 the house was dramatically extended, before some demolition of the eastern section in the late 19th century. There have been some largely undated alterations in subsequent years.

How is it significant?

Tintern is of scientific, historical and architectural significance to the State of Victoria.

Why is it significant?

Tintern is of scientific (technical) significance as a very rare surviving example of a 19th century pre-fabricated iron dwelling. Manufactured by W. and P. McLellan of Glasgow, the earliest part of the house illustrates the application of 19th century industrial techniques to housing construction and provides some idea of the nature of colonial development in the middle of the 19th century. The importation of portable houses to Australia reflected both the shortage of materials and workers in gold rush Victoria and the economic reliance of the colonies on Britain. While a large number of pre-fabricated dwellings were imported to Victoria during the gold rushes to cope with Melbourne's rapidly growing population, very few now remain here, or, indeed, in the world. The use of decorative cast iron to simulate traditional rendered finishes, including brackets and scrolls, is a notable feature of the house.

Tintern is of historical significance for its association with William Westgarth (1815-1889), eminent pioneer colonist, author, politician, merchant and historian who was responsible for the construction of the building, although he owned it for only a short period.

Tintern is of architectural significance for the two 20th century fireplaces which are the work of the noted architect Harold Desbrowe Annear.

Permit Exemptions

General Exemptions:

General exemptions apply to all places and objects included in the Victorian Heritage Register (VHR). General exemptions have been designed to allow everyday activities, maintenance and changes to your property, which don't harm its cultural heritage significance, to proceed without the need to obtain approvals under the Heritage Act 2017.

Places of worship: In some circumstances, you can alter a place of worship to accommodate religious practices without a permit, but you must **notify** the Executive Director of Heritage Victoria before you start the works or activities at least 20 business days before the works or activities are to commence.

Subdivision/consolidation: Permit exemptions exist for some subdivisions and consolidations. If the subdivision or consolidation is in accordance with a planning permit granted under Part 4 of the *Planning and Environment Act 1987* and the application for the planning permit was referred to the Executive Director of Heritage Victoria as a determining referral authority, a permit is not required.

Specific exemptions may also apply to your registered place or object. If applicable, these are listed below. Specific exemptions are tailored to the conservation and management needs of an individual registered place or object and set out works and activities that are exempt from the requirements of a permit. Specific exemptions prevail if they conflict with general exemptions.

Find out more about heritage permit exemptions [here](#).

Construction dates	1855,
Heritage Act Categories	Registered place,
Hermes Number	1079
Property Number	

History

Contextual History:History of Place:

The crown grantee of the land on which Tintern stands was T. Colclough, who obtained the property in 1845. William Westgarth acquired the 105 acre property around 1853, at around the same time he resigned his seat in the Victorian Legislative Assembly to return to England. It would appear that while in Britain he ordered a pre-fabricated structure for erection back in Melbourne. Westgarth sold the house in 1857 and the property passed through several hands before being acquired by the noted architect William Butler late in the 19th century. Major additions which are generally sympathetic to the Italianate style of the original iron house were made between the 1870s and 1894. In 1902 much of the estate was subdivided and sold. The property is now (1999) owned by descendants of William Westgarth.

Associated People: AL Smith (probably the supervising architect for the erection of the pre-fab)

William Butler (lived there in late 19th century)

Harold Desbrowe-Annear (responsible for 2 20th century chimneys)

Extent of Registration

AMENDMENT OF REGISTER OF HISTORIC BUILDINGS

Historic Building No. 208:

Tintern, 10 Tintern Avenue, Toorak.

To the extent of:

1. All of the buildings, works and objects on the registered land known as Tintern, 10 Tintern Avenue Toorak.
2. The land designated in Proposed Lot 1, Plan of Subdivision PS 314216B as shown on attached Plan 604125G(A) endorsed by the Chairperson, Historic Buildings Council and held by the Director, Historic Buildings Council, being part of the land as described in Certificate of Title Volume 5561 Folio 088.

[*Victoria Government Gazette* No. G3 22 January 1992 p.151]

This place/object may be included in the Victorian Heritage Register pursuant to the Heritage Act 2017. Check the Victorian Heritage Database, selecting 'Heritage Victoria' as the place source.

For further details about Heritage Overlay places, contact the relevant local council or go to Planning Schemes Online <http://planningschemes.dpcd.vic.gov.au/>