

HEATHERLIE (MT DIFFICULT) QUARRY



HEATHERLIE (MT DIFFICULT) QUARRY SOHE 2008



HEATHERLIE (MT DIFFICULT) QUARRY SOHE 2008



HEATHERLIE (MT DIFFICULT) QUARRY SOHE 2008

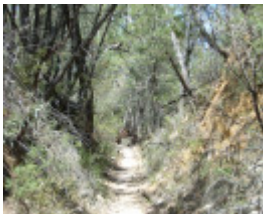

HEATHERLIE (MT DIFFICULT) QUARRY SOHE 2008



HEATHERLIE (MT DIFFICULT) QUARRY SOHE 2008

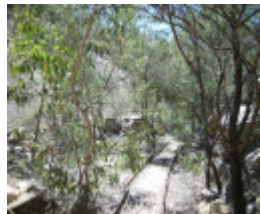

HEATHERLIE (MT DIFFICULT) QUARRY SOHE 2008



HEATHERLIE (MT DIFFICULT) QUARRY SOHE 2008



HEATHERLIE (MT DIFFICULT) QUARRY SOHE 2008



1 heatherlie quarry roses gap stawell building shell



h01556 heatherlie quarry grampians national park halls gapp bailer she project 2004



h01556 heatherlie quarry grampians national park halls gapp boilers chimney compressor she project 2004



h01556 heatherlie quarry grampians national park halls gapp drilled main rock face she project 2004



h01556 heatherlie quarry
grampians national park halls
gapp dry stone wall she
project 2004



h01556 heatherlie quarry
grampians national park halls
gapp hut 2 she project 2004



h01556 heatherlie quarry
grampians national park halls
gapp large jib crane she
project 2004



h01556 heatherlie quarry
grampians national park halls
gapp rock and concrete crane
base she project 2004



h01556 heatherlie quarry
grampians national park halls
gapp small jib crane she
project 2004



h01556 heatherlie quarry
grampians national park halls
gapp stone powder magazine
she project 2004



h01556 heatherlie quarry
grampians national park halls
gapp timber supports she
project 2004

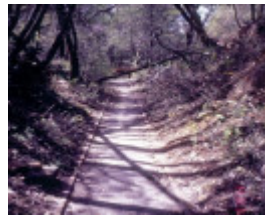

h01556 heatherlie quarry
grampians national park halls
gapp tramway siding she
project 2004



h01556 heatherlie quarry
grampians national park halls
gapp tramway wagon in
sliding she project 2004

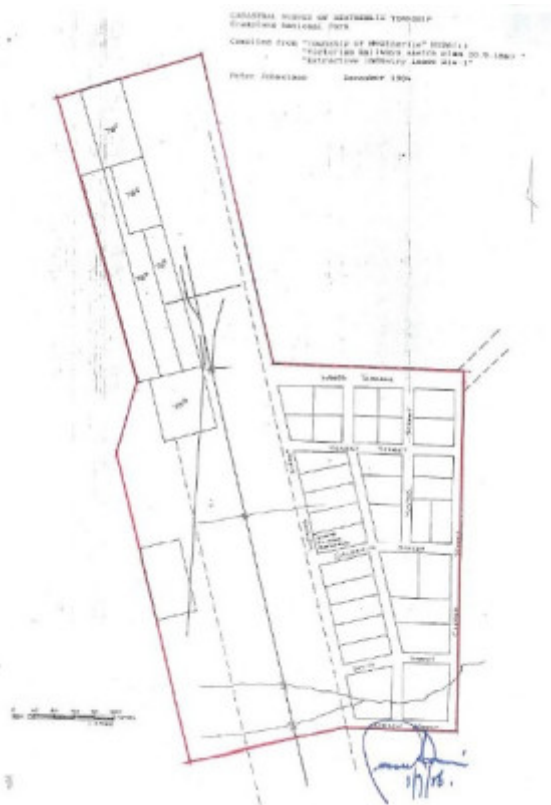

H1556 H1556 plan

Location

GRAMPIANS NATIONAL PARK, GRAMPIANS ROAD, BELLFIELD, NORTHERN GRAMPIANS SHIRE

Municipality

NORTHERN GRAMPIANS SHIRE

Level of significance

Registered

Victorian Heritage Register (VHR) Number

H1556

Heritage Overlay Numbers

HO26

VHR Registration

December 17, 1986

Amendment to Registration

May 23, 1998

Heritage Listing

Victorian Heritage Register

Statement of Significance

Last updated on - May 21, 1999

In 1861 or 1862, Francis Walkins, stonemason of Stawell discovered an outcrop of freestone in the Mount Difficult range while on a shooting trip and realised that the stone was extremely durable. By the 1870s the stone was being quarried for use in Stawell. But, such was the potential of the quarry that a tramway was built to link it to the main railway at Stawell, and a township was gazetted adjacent to the quarry. In 1879, the Stawell freestone was unanimously recommended for the construction of Parliament House. The stone was also used for the Melbourne town hall and various other important buildings. The construction of the tramway link from Stawell to the quarry had facilitated the use of the stone in areas other than just locally.

The quarry is significant because of its association with several important Melbourne buildings. It is also of local importance in that the stone from the quarry was extensively used in the rebuilding of Main Street in Stawell after a major fire in the 1870s. The quarry is also important because there remains a fund of tangible evidence of the operations of the quarry in the form of buildings, machinery and worked rock faces.

Permit Exemptions

General Exemptions:

General exemptions apply to all places and objects included in the Victorian Heritage Register (VHR). General exemptions have been designed to allow everyday activities, maintenance and changes to your property, which don't harm its cultural heritage significance, to proceed without the need to obtain approvals under the Heritage Act 2017.

Places of worship: In some circumstances, you can alter a place of worship to accommodate religious practices without a permit, but you must [notify](#) the Executive Director of Heritage Victoria before you start the works or activities at least 20 business days before the works or activities are to commence.

Subdivision/consolidation: Permit exemptions exist for some subdivisions and consolidations. If the subdivision or consolidation is in accordance with a planning permit granted under Part 4 of the *Planning and Environment Act 1987* and the application for the planning permit was referred to the Executive Director of Heritage Victoria as a determining referral authority, a permit is not required.

Specific exemptions may also apply to your registered place or object. If applicable, these are listed below. Specific exemptions are tailored to the conservation and management needs of an individual registered place or object and set out works and activities that are exempt from the requirements of a permit. Specific exemptions prevail if they conflict with general exemptions.

Find out more about heritage permit exemptions [here](#).

Construction dates 1860,
Heritage Act Categories Registered place,
Other Names HEATHERLIE QUARRY,
Hermes Number 1126
Property Number

History

Associated People: Assoc.People FRANCIS WATKINS

Extent of Registration

Amendment of Register of Government Buildings

Stawell Shire

Heatherlie Quarry, Roses Gap.

[*Victoria Government Gazette* No. G39 12 October 1988 p.3094]

Transferred to the Victorian Heritage Register 23 May 1998 (2 years after the proclamation of the Heritage Act 1995 pursuant to the transitional provisions of the Act)

This place/object may be included in the Victorian Heritage Register pursuant to the Heritage Act 2017. Check the Victorian Heritage Database, selecting 'Heritage Victoria' as the place source.

For further details about Heritage Overlay places, contact the relevant local council or go to Planning Schemes Online <http://planningschemes.dpcd.vic.gov.au/>