

Hotel (Court House Hotel)

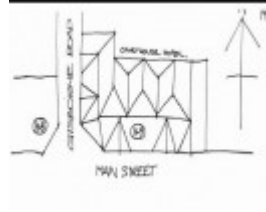

Court House Hotel



Court House Hotel

Location

116 Main Street BACCHUS MARSH, MOORABOOL SHIRE

Municipality

MOORABOOL SHIRE

Level of significance

Included in Heritage Overlay

Heritage Overlay Numbers

HO106

Heritage Listing

Moorabool Shire

Statement of Significance

Last updated on - June 1, 1995

An Edwardian two-storey corner brick hotel designed by the architect J.B. Grut, with some characteristics of the Old English style and built in 1911. It was altered in 1928 to Rupert Taylor's design. There was continuity in the Purday family's ownership from c 1857 until 1949.

It is of local historical significance for its association with developments in the community life of the town, as a business on the route to the goldfields, for its hospitality since the 1850s and as a representative embodiment of the community's life for over eighty years.

It is of local architectural significance as a representative and relatively intact example of an Edwardian style hotel, and social significance as traditional focus and meeting place for the community and for travellers.

Heritage Study/Consultant	Moorabool - Bacchus Marsh Heritage Study 1995, Richard Peterson and Daniel Catrice, 1995;
Architect/Designer	Rawlinson, TE, Grut, John B. & Rupert Taylor,
Other Names	Purday & Smith Saddlery,
Hermes Number	117214
Property Number	

Physical Conditions

Reasonable. Road widening?

Intactness

Good above ground floor level. Verandah is demolished. Brickwork is painted.

SIGNIFICANT INTACT ELEMENTS:

FORM. FACADE. ROOF FORM. USE.

EAVES DECORATION. ROOF DECORATION.

CHIMNEYS. ? WINDOWS. CONTEXT 148, 147.

Physical Description 1

An Edwardian, two-storey brick corner hotel with some Old English characteristics. It has a Marseilles terra-cotta unglazed terra-cotta tile roof; with cresting and finials. There are three bays to Gisborne Road, and four bays to Main Street. Each bay, (except two to Main Street and one to Gisborne Road) has a jettied upper gable, timbered on joists and brackets, with pendant bargeboards with discs. There is apron decoration beneath first floor windows.

Historical Australian Themes

Township, Community life, Transport.

Usage/Former Usage

USE: Hotel

PREVIOUS USE: Saddlery, (1857-64).

This place/object may be included in the Victorian Heritage Register pursuant to the Heritage Act 2017. Check the Victorian Heritage Database, selecting 'Heritage Victoria' as the place source.

For further details about Heritage Overlay places, contact the relevant local council or go to Planning Schemes Online <http://planningschemes.dpcd.vic.gov.au/>