

Police Station (residence), 119 Main Street

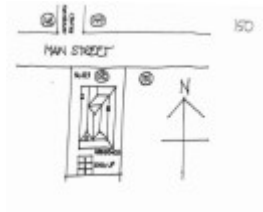

Police residence, 121 Main Street



Police residence, 121 Main Street



Police residence, 121 Main Street

Location

119 Main Street BACCHUS MARSH, MOORABOOL SHIRE

Municipality

MOORABOOL SHIRE

Level of significance

Included in Heritage Overlay

Heritage Overlay Numbers

HO6

Heritage Listing

Moorabool Shire

Statement of Significance

Last updated on - December 19, 1993

A polychromatic brick eclectic late Victorian police residence (probably) designed by the important architect S.E. Bindley, of the Public Works Department, built in 1890 and closed in 1930. A sandstone lock-up survives at the rear, built in 1858, possibly with materials used earlier at Maddingley.

It is of local historical significance for its association with the development of law and order in Bacchus Marsh and in demonstrating the imposition of government action on the community.

| | |
|---------------------------|---|
| Heritage Study/Consultant | Moorabool - Bacchus Marsh Heritage Study 1995, Richard Peterson and Daniel Catrice, 1995; |
| Other Names | Police residence, |
| Hermes Number | 117218 |
| Property Number | |

Physical Conditions

Good. Rising damp, efflorescence and exfoliation affect brickwork, the lock-up is in poor condition. The site is now privately owned.

Intactness

Very good. Bricks have been panted charcoal grey and the finial has been truncated. The chain-link fence is sympathetic.

SIGNIFICANT INTACT ELEMENTS:

MATERIALS. FORM. FACADE. VERANDAH. ROOF FORM. PLAN/LAYOUT. USE.

ROOFDECORATION. VERANDAH DECORATION.

CHIMNEYS. WALLDECORATION. DOORS. WINDOWS.

UNPAINTED FINISH. OUTBUILDINGS.

Physical Description 1

A double-fronted polychromatic brick house, characteristic of residences for government officials, designed by the Public Works Department of Victoria in the late nineteenth century, but with the details inimitable to the important architect S.E. Bindley. It has a hip roof in slate with the right-hand bay set forward as a gable. Over this the eaves project supported on exposed purlins with diamond roofline ends. There is a rail and finial infilled with a fretwork chrysanthemum motif. Below is a pair of segmental head windows. In the angle and continuing on the left hand side and rear is a timber skillion verandah. It has decorative fretwork brackets in the form of one chrysanthemum petal. Brickwork is red body bricks with cream and black dyed dressings. There are boards at cill and window-head height and deeply moulded chimney tops. One the rear boundary is a rectangular gable roofed stone lock-up with a skillion verandah.

Historical Australian Themes

Governing

This place/object may be included in the Victorian Heritage Register pursuant to the Heritage Act 2017. Check the Victorian Heritage Database, selecting 'Heritage Victoria' as the place source.

For further details about Heritage Overlay places, contact the relevant local council or go to Planning Schemes Online <http://planningschemes.dpcd.vic.gov.au/>