

FORMER MINING EXCHANGE



Mining Exchange - Film 1 / Frame 22 - Ballarat Conservation Study, 1978



Mining Exchange02 - Ballarat Conservation Study, 1978

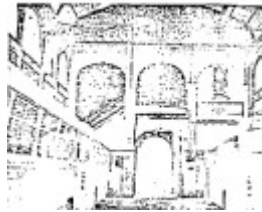

Mining Exchange03 - Ballarat Conservation Study, 1978



Mining Exchange04 - Mining Exchange interior shortly after opening (the date '1887' has been written on the original photo; obviously erroneous) This view clearly show the layout of the booths and their original joinery - Ballarat Conservation Study, 1978



Mining Exchange05 - Lydiard Street elevation c.1900. Apart from the clear view of the verandah, the photo also shows the single storey verandah of the Old Colonist's Hall to the north - Ballarat Conservation Study, 1978



Mining Exchange_1976 Source: Private collection



Mining Exchange_1_c1901 Source: Private collection



Mining Exchange_3 Source: Private collection



Mining Exchange_4 Source: Private collection



Mining Exchange_5 Source: Private collection



Mining Exchange_Evening Echo_1904 Source: Private collection



Mining Exchange_Iron works Source: Private collection



Mining Exchange_Iron works_1 Source: Private collection



Mining Exchange_Iron works_2 Source: Private collection



Mining Exchange_Roof_1976 Source: Private collection



Mining Exchange_Roof_2_1976 Source: Private collection



Mining Exchange_Streetscape Source: Private collection



Mining Exchange_Streetscape_1 Source: Private collection



Mining Exchange_Streetscape_3 Source: Private collection



Mining Exchange_Streetscape_4 Source: Private collection



Mining Exchange_Streetscape_5 Source: Private collection



Mining Exchange_Streetscape_6 Source: Private collection

Location

8-14 LYDIARD STREET NORTH, BALLARAT CENTRAL - PROPERTY NUMBERS 2043551, 2020935, 2020934, 2020933, 2020932, 2020931, BALLARAT CITY

Municipality

BALLARAT CITY

Level of significance

Included in Heritage Overlay

Victorian Heritage Register (VHR) Number

H0391

Heritage Overlay Numbers

HO65

Heritage Listing

Ballarat City

Statement of Significance

Last updated on - February 29, 2024

What is significant?

How is it significant?

Why is it significant?

Part of Recommended Area A1.1.

No SoS provided in this citation. Please refer to descriptions, history, construction, loc govt, listings and images sections in this place record for further information.

Heritage Study/Consultant Ballarat - Ballarat Conservation Study, Jacobs Lewis Vines Architects, 1978;

Construction dates 1887, 1964,

Architect/Designer Figgis, Charles Douglas,

Hermes Number 120866

Property Number

Physical Description 1

This building was opened in 1889; the architect was C.D. Figgis and the builder W. Robertson. It has an elaborate front facade with an interesting arcade at ground level with unusual cement render detailing, particularly

the front domical entrance reveal. At first floor the three bays employ a Palladian 3 window motif. The facade is capped with a bracketed cornice with central pediment and a balustraded parapet on either side carrying garlanded urns. Internally the large central hall of the former Exchange comprises arcaded brick booths along both sides and surmounted by similarly arched clerestory windows at first floor level. The most interesting and unusual features of the building are the light tension rod roof trusses and the bull nose profile roof which returns across the rear in a hipped form.

This building is basically intact other than the street verandah and shop fronts. It is in generally sound condition in spite of the lack of maintenance.

This building is important historically and architecturally. It has direct links with the gold mining era when Ballarat was a city of world prominence and is one of the few physical manifestations remaining of this activity. The only other Exchange remaining is in Charters Towers in Queensland. It is also of major significance architecturally. The roof structure in particular, and the central hall have no other precedents in this state.

Integrity

VERANDAH REMOVED

This place/object may be included in the Victorian Heritage Register pursuant to the Heritage Act 2017. Check the Victorian Heritage Database, selecting 'Heritage Victoria' as the place source.

For further details about Heritage Overlay places, contact the relevant local council or go to Planning Schemes Online <http://planningschemes.dpcd.vic.gov.au/>