

# PRATTS WAREHOUSE



PRATTS WAREHOUSE  
SOHE 2008



h00955 1 pratts warehouse  
mair and camp st ballarat  
east elevation she project  
2003



h00955 pratts warehouse  
mair and camp st ballarat  
front view she project 2003



h00955 pratts warehouse  
mair and camp st ballarat  
stairs she project 2003



h00955 pratts warehouse  
camp street ballarat front  
view aug1985

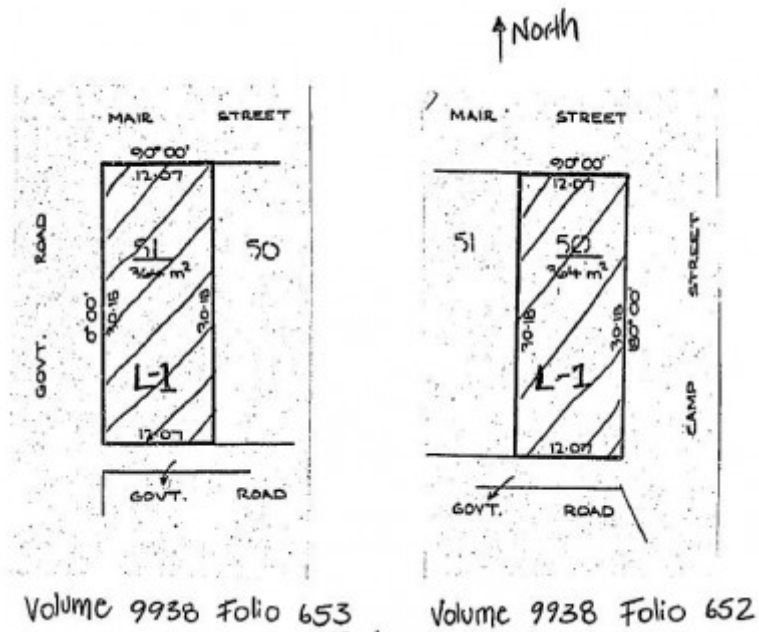

h00955 plan h0955

**Location**

101-103 MAIR STREET BALLARAT CENTRAL, BALLARAT CITY

**Municipality**

BALLARAT CITY

**Level of significance**

Registered

**Victorian Heritage Register (VHR) Number**

H0955

**Heritage Overlay Numbers**

HO89

**VHR Registration**

February 19, 1993

**Heritage Listing**

Victorian Heritage Register

---

**Statement of Significance**

Last updated on - February 16, 2000

Pratt's Warehouse (originally McDowall and Gray's warehouse) in the city of Ballarat is historically significant in its ability to provide a rare example of a two-storey masonry warehouse of the mid-19th century. In its original form, with pulleys, hooks, and hoists, it exhibits the type of warehouse structure of the day.

Designed by prominent local architect JA Doane in 1869, it is representative of Victorian functional architecture. Pratt's Warehouse is one of the remaining examples of a rough-faced masonry warehouse in Victoria. It is structurally a credit to its architect, because it has stood intact for over 103 years, despite its various uses.

Pratt's Warehouse is also interesting because it is a free-standing corner structure with a double facade. The facade is also notable for its unusual false and real chimneys, used to establish the symmetry on the Mair Street side.

It is also a superb example of the fine railway-area warehouses of the century past.

**Permit Exemptions****General Exemptions:**

General exemptions apply to all places and objects included in the Victorian Heritage Register (VHR). General exemptions have been designed to allow everyday activities, maintenance and changes to your property, which don't harm its cultural heritage significance, to proceed without the need to obtain approvals under the Heritage

Act 2017.

Places of worship: In some circumstances, you can alter a place of worship to accommodate religious practices without a permit, but you must **notify** the Executive Director of Heritage Victoria before you start the works or activities at least 20 business days before the works or activities are to commence.

Subdivision/consolidation: Permit exemptions exist for some subdivisions and consolidations. If the subdivision or consolidation is in accordance with a planning permit granted under Part 4 of the *Planning and Environment Act 1987* and the application for the planning permit was referred to the Executive Director of Heritage Victoria as a determining referral authority, a permit is not required.

Specific exemptions may also apply to your registered place or object. If applicable, these are listed below. Specific exemptions are tailored to the conservation and management needs of an individual registered place or object and set out works and activities that are exempt from the requirements of a permit. Specific exemptions prevail if they conflict with general exemptions.

Find out more about heritage permit exemptions [here](#).

Construction dates	1869,
Architect/Designer	Doane, JA,
Heritage Act Categories	Registered place,
Other Names	McDOWALL AND GRAY'S WAREHOUSE,
Hermes Number	1347
Property Number	

---

## Extent of Registration

### AMENDMENT OF REGISTER OF HISTORIC BUILDINGS

Historic Building No. 955.

Pratt's Warehouse, corner Camp and Mair Streets, Ballarat.

(To the extent of:

1. All the building known as Pratt's Warehouse.
2. All of the land contained in Certificate of Title Volume Folio, shown marked on Plan 6001705 endorsed by the Chairperson, Historic Buildings Council and held by the Director, Historic Buildings Council.)  
[*Victoria Government Gazette* No. G6 11 February 1993 p.292]

*This place/object may be included in the Victorian Heritage Register pursuant to the Heritage Act 2017. Check the Victorian Heritage Database, selecting 'Heritage Victoria' as the place source.*

For further details about Heritage Overlay places, contact the relevant local council or go to Planning Schemes Online <http://planningschemes.dpcd.vic.gov.au/>