

FORMER STANDARD BRICKWORKS



FORMER STANDARD
BRICKWORKS SOHE 2008



FORMER STANDARD
BRICKWORKS SOHE 2008



FORMER STANDARD
BRICKWORKS SOHE 2008



former standard brickworks
federation street box hill end
view kiln dec1987



former standard brickworks
federation street box hill red
corrugated iron building



former standard brickworks
federation street box hill side
view kiln dec1987



former standard brickworks
federation street box hill vault
dec1987

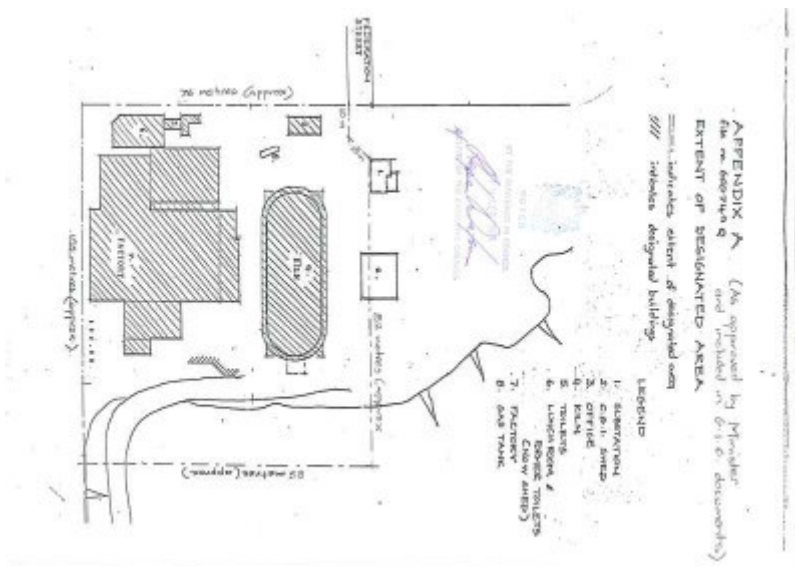

H0720 plan

Location

14 FEDERATION STREET BOX HILL, WHITEHORSE CITY

Municipality

WHITEHORSE CITY

Level of significance

Registered

Victorian Heritage Register (VHR) Number

H0720

Heritage Overlay Numbers

HO3

VHR Registration

September 20, 1989

Heritage Listing

Victorian Heritage Register

Statement of Significance

The Box Hill Brickworks had their origins in the boom years of the 1880s. In 1884 a prospectus was issued for the Haughton Park Brick Company Ltd., Box Hill, proposing to produce machine and hand made bricks, tiles, earthenware and porcelain on 30 acres at the corner of Elgar and Canterbury Roads. One of the directors was Peter Behrendt, a civil engineer and architect, an agent for continental clay products and said to be adept in the manufacture of Dresden and other high class terracotta and porcelain works. In 1886 the company changed its name to the Box Hill Brick Co Ltd. The year 1889 was a peak year for brickmaking in Melbourne and in 1890 the company declared its first dividend. These works were among a number of like industries in the region. With the industry in decline in the 1890s the company did not pay a dividend in 1891 and in 1892 it suspended production. Following a change of ownership and a lease by the rival Co-operative Brick Company the site was sold in 1905 and the quarry became the "surrey dive" swimming hole. In about 1911 brick production again started on this site near the dive and in 1913 this became the Standard Brick and Tile Co. Ltd. In 1913 the company was attending its plant, building an 18 chamber Hoffman patent kiln and planning to install four brick presses and employ 40 men. Over the years the Box Hill brickworks has experienced changing fortunes and even closures. One reason for this has been the comparative isolation of the works. In 1938 the works were taken over by the Co-operative Brick Company. They were closed in the war years of 1942-46 and in 1952 the plant was converted to electricity. The Brick and Pipe Company took over the company in 1966 and in August 1988 the box hill works were closed.

The Former Standard Brick Works at Box Hill are of historic and architectural importance for the following reasons:

- * the former standard brickworks site in Federation street, Box Hill comprises a rare and unusually intact brickmaking plant of the early twentieth century. The site retains material evidence of all the stages of the brick production process from clay extraction to dispatch.
- * the distinctive form and internal fittings of the clay mill building provide evidence of superseded brickmaking processes and ancillary trades, in particular the tramway system for hauling clay and the blacksmith's shop. The grinding pans and brick press machinery on site exhibit the same fundamental technology which was introduced with the industrialization of brickmaking in Victoria in the latter half of the nineteenth century.
- * for containing on site one of the last operative Hoffman patent brickmaking kilns in Victoria.
- * the significance of the site is enhanced by its location adjacent to the former "Surrey Dive" with which it has some historical associations. Box Hill is also the last historic remnant of a series of brick and tile producing works which were established between Hawthorn and Mitcham from the 1880s to the 1939-45 war.

Permit Exemptions

General Exemptions:

General exemptions apply to all places and objects included in the Victorian Heritage Register (VHR). General exemptions have been designed to allow everyday activities, maintenance and changes to your property, which don't harm its cultural heritage significance, to proceed without the need to obtain approvals under the Heritage Act 2017.

Places of worship: In some circumstances, you can alter a place of worship to accommodate religious practices without a permit, but you must **notify** the Executive Director of Heritage Victoria before you start the works or activities at least 20 business days before the works or activities are to commence.

Subdivision/consolidation: Permit exemptions exist for some subdivisions and consolidations. If the subdivision or consolidation is in accordance with a planning permit granted under Part 4 of the *Planning and Environment Act 1987* and the application for the planning permit was referred to the Executive Director of Heritage Victoria as a determining referral authority, a permit is not required.

Specific exemptions may also apply to your registered place or object. If applicable, these are listed below. Specific exemptions are tailored to the conservation and management needs of an individual registered place or

object and set out works and activities that are exempt from the requirements of a permit. Specific exemptions prevail if they conflict with general exemptions.

Find out more about heritage permit exemptions [here](#).

Construction dates	1884,
Heritage Act Categories	Registered place,
Other Names	QUARRY,
Hermes Number	154
Property Number	

Extent of Registration

Former Standard Brickworks, Federation Street, Box Hill to the extent of all the buildings and the land shown hatched (Appendix A) which is included in the Register Book Certificate of Title Volume 6520 Folio 1303967. [Victoria Government Gazette No G37 20 September 1989 p.2427]

This place/object may be included in the Victorian Heritage Register pursuant to the Heritage Act 2017. Check the Victorian Heritage Database, selecting 'Heritage Victoria' as the place source.

For further details about Heritage Overlay places, contact the relevant local council or go to Planning Schemes Online <http://planningschemes.dpcd.vic.gov.au/>