

NOBLE STREET UNITING CHURCH, HALL AND KINDERGARTEN



NOBLE STREET UNITING CHURCH, HALL AND KINDERGARTEN SOHE 2008



NOBLE STREET UNITING CHURCH, HALL AND KINDERGARTEN SOHE 2008



NOBLE STREET UNITING CHURCH, HALL AND KINDERGARTEN SOHE 2008



1 noble street uniting church hall & kindergarten noble street newtown kindergarten

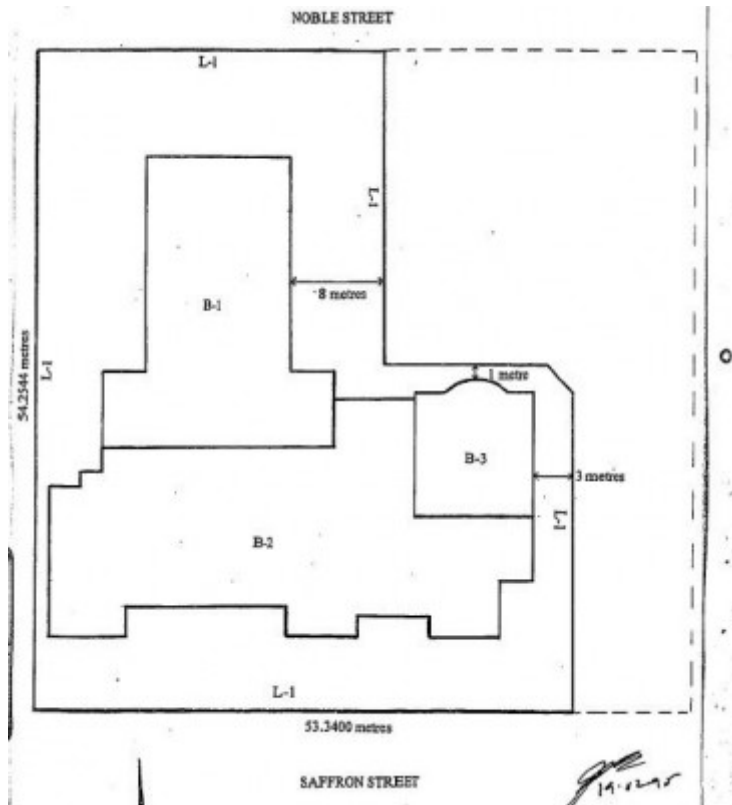

h01158 plan h1158

Location

35 NOBLE STREET NEWTOWN, GREATER GEELONG CITY

Municipality

GREATER GEELONG CITY

Level of significance

Registered

Victorian Heritage Register (VHR) Number

H1158

Heritage Overlay Numbers

HO198

VHR Registration

April 18, 1996

Heritage Listing

Statement of Significance

Last updated on - May 6, 1999

The Noble Street Uniting Church, Newtown was built in 1854 by Pile and Brimblecombe to replace an earlier structure. The church, built of bluestone in a purportedly Norman style but exhibiting the proportions of a classical temple, was extended in 1876 by the addition of transepts. The Fincham pipe organ and choir gallery were also added at this time. The Gothic style single storey Sunday School/hall was built in 1890 and the kindergarten in 1915.

The Noble Street Uniting Church is of historical and architectural significance to Victoria.

The Noble Street Uniting Church is important for its historical associations with the Wesleyan Methodist Church in Victoria. Amongst the earliest of the churches built by the Wesleyan Church in the state, it demonstrates the simple and more classicising nature of Wesleyan architecture during the period prior to their acceptance of the Gothic style with the construction of the Wesley Church, Lonsdale Street, Melbourne in 1857.

The church is significant as an extraordinary example of an architectural style. Despite its classical temple form, typical of early nonconformist churches, the building also incorporates elements derived from Romanesque architecture, including a wheel window. The hall is an extraordinarily late example of the Picturesque Gothic style complete with pseudo Georgian glazing bars. The sequence of styles exhibited by the complex exemplifies the changing attitudes to architectural expression by the Wesleyan Church in the nineteenth century. The classical/Romanesque expression demonstrates the earlier nonconformist aversion to the "papist" associations of the Gothic.

This contrasts markedly with the (by then) extremely old fashioned Gothic expression of the 1890 Sunday School/hall.

Permit Exemptions

General Exemptions:

General exemptions apply to all places and objects included in the Victorian Heritage Register (VHR). General exemptions have been designed to allow everyday activities, maintenance and changes to your property, which don't harm its cultural heritage significance, to proceed without the need to obtain approvals under the Heritage Act 2017.

Places of worship: In some circumstances, you can alter a place of worship to accommodate religious practices without a permit, but you must [notify](#) the Executive Director of Heritage Victoria before you start the works or activities at least 20 business days before the works or activities are to commence.

Subdivision/consolidation: Permit exemptions exist for some subdivisions and consolidations. If the subdivision or consolidation is in accordance with a planning permit granted under Part 4 of the *Planning and Environment Act 1987* and the application for the planning permit was referred to the Executive Director of Heritage Victoria as a determining referral authority, a permit is not required.

Specific exemptions may also apply to your registered place or object. If applicable, these are listed below. Specific exemptions are tailored to the conservation and management needs of an individual registered place or object and set out works and activities that are exempt from the requirements of a permit. Specific exemptions prevail if they conflict with general exemptions.

Find out more about heritage permit exemptions [here](#).

Construction dates 1854,
Heritage Act Categories Registered place,
Hermes Number 2014
Property Number

Extent of Registration

AMENDMENT OF REGISTER OF HISTORIC BUILDINGS

Historic Building No. 1158:

Noble Street, Uniting Church, Hall and Kindergarten, 31 Noble Street, Newtown, City of Greater Geelong.

Extent:

To the extent of:

1. All of the buildings known as the Noble Street Uniting Church (B-1), Hall (B-2) and Kindergarten (B-3) shown on Plan 601131 endorsed by the Chairperson, Historic Buildings Council and held by the Director, Historic Buildings Council.
2. All of the land marked L-1 on Plan 601131 being all of the land described in Memorial No. 774 Book 167, Memorial No. 678 Book 8, Memorial No. 907 Book 113, Memorial No. 778 Book 167, Memorial No. 684 Book 2 and part of the land described in Memorial No. 747 Book 142 endorsed by the Chairperson, Historic Buildings Council and held by the Director, Historic Buildings Council.
[Victoria Government Gazette No. G15 18 April 1996 p.955]

This place/object may be included in the Victorian Heritage Register pursuant to the Heritage Act 2017. Check the Victorian Heritage Database, selecting 'Heritage Victoria' as the place source.

For further details about Heritage Overlay places, contact the relevant local council or go to Planning Schemes Online <http://planningschemes.dpcd.vic.gov.au/>