

NILJA

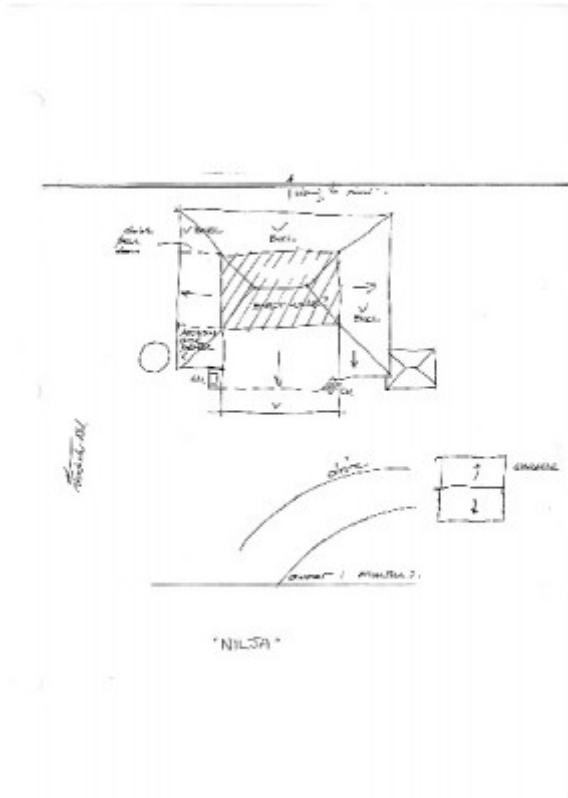

22625 Nilja - Alexander Road, Warrandyte



22625 Locational Map of Nilja -Alexander Road, Warrandyte

Location

Alexander Road WARRANDYTE, Manningham City

Municipality

MANNINGHAM CITY

Level of significance

Included in Heritage Overlay

Heritage Overlay Numbers

HO2

Heritage Listing

Manningham City

Statement of Significance

Last updated on -

Of local significance for its historical associations with Angela Booth; and architecturally as a particularly intact, simple, Edwardian timber house in a spectacularly beautiful setting, perhaps surrounding an earlier cottage, with residual plantings of the same period.

Heritage Study/Consultant	Manningham - Manningham Heritage Study Review, Context Pty Ltd, 2006; Manningham - Doncaster & Templestowe Heritage Study Additional Sites Recommendations, Richard Peterson, 1993; Manningham - Doncaster & Templestowe Heritage Study Additional Historical Research, Carlotta Kellaway, 1994;
Hermes Number	22625
Property Number	

Historical Australian Themes

Local Themes

7.04 - Edwardian houses

Physical Description 1

"Nilja" is a single-storey timber house, perched high above the Yarra River at Warrandyte. It is a hip-roofed timber house surrounded by an enclosed verandah which is very wide. This has walls in some places and flyscreens in others. The weatherboards are creosoted. The windows are casements as triples or French doors. The sashes are painted cream in green frames. Presumably these are all colours original to the 1920s.

The house has a high elevation in the front (north) and faces the spectacular view over the Yarra valley towards Eltham. A rear (south) verandah has turned Edwardian posts. There are red brick chimneys and the roof is painted red. There is a double garage, contemporary with the house.

The fences are post and wire with metal droppers. The drive is lined with eucalypts and the garden has other residual plantings from the 1920s. The central hip-roofed section seems earlier in form, but there is no physical

evidence of this.

Physical Conditions

Condition Good

Integrity

Integrity Minor Modifications

Physical Description 2

Associations

Dr & Angela E.J. Booth; Rutledge family

This place/object may be included in the Victorian Heritage Register pursuant to the Heritage Act 2017. Check the Victorian Heritage Database, selecting 'Heritage Victoria' as the place source.

For further details about Heritage Overlay places, contact the relevant local council or go to Planning Schemes Online <http://planningschemes.dpcd.vic.gov.au/>