

# ST ELMO



ST ELMO SOHE 2008



1 st elmo elizabeth street  
geelong front view apr1995

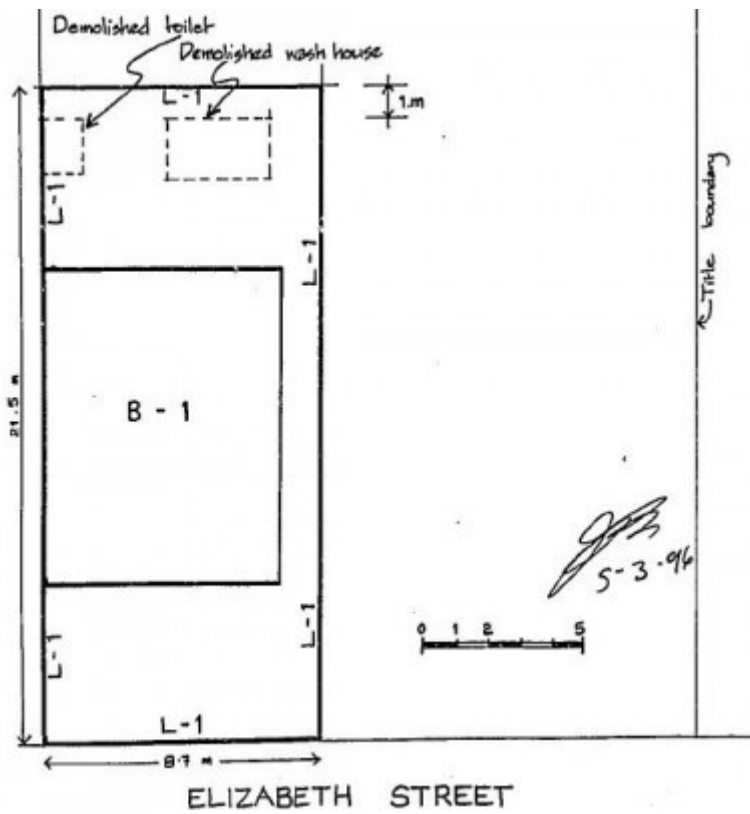

h01180 plan h1180

## Location

127 ELIZABETH STREET GEELONG WEST, GREATER GEELONG CITY

## Municipality

GREATER GEELONG CITY

## Level of significance

Registered

## Victorian Heritage Register (VHR) Number

H1180

## Heritage Overlay Numbers

HO667

## VHR Registration

April 18, 1996

## Heritage Listing

Victorian Heritage Register

---

## Statement of Significance

Last updated on - May 7, 1999

St. Elmo, erected between 1860 and 1862, was built by its original owner George Arnott, a skilled bricklayer and father of 12 children, who occupied the property for over 60 years. The small six roomed cottage, constructed of locally produced bricks, originally consisted of four rooms but was extended in the early 1880's. The building features an ornate timber verandah and unusual chimneys: four in number, of which two are square, one is octagonal and the other circular, with a square base.

St. Elmo is of architectural and historical significance to Victoria

St. Elmo is of architectural significance for its demonstration of excellent brick workmanship, using handmade bricks in a variety of forms and colours which have been laid in such a manner to create unusual chimney forms, decorative patterning and bi-chromatic designs. The building is important as a very intact example of an early 1860's worker's cottage containing much of its original typically simple joinery and fixtures including fireplaces, doors, architraves, skirtings and built-in furniture. Although extended, the building's original layout remains unaltered. The ornate timber verandah, with its infilled ends, is of interest as an unusual picturesque element.

St. Elmo is of historical significance as an example of a way of life for a skilled bricklayer during the mid 19th century where an effective form of advertisement for his trade was an example of his skill. This cottage is important as a surviving and intact example of a once common practice of trade persons demonstrating their skills.

## Permit Exemptions

### General Exemptions:

General exemptions apply to all places and objects included in the Victorian Heritage Register (VHR). General exemptions have been designed to allow everyday activities, maintenance and changes to your property, which don't harm its cultural heritage significance, to proceed without the need to obtain approvals under the Heritage Act 2017.

Places of worship: In some circumstances, you can alter a place of worship to accommodate religious practices

without a permit, but you must [notify](#) the Executive Director of Heritage Victoria before you start the works or activities at least 20 business days before the works or activities are to commence.

Subdivision/consolidation: Permit exemptions exist for some subdivisions and consolidations. If the subdivision or consolidation is in accordance with a planning permit granted under Part 4 of the *Planning and Environment Act 1987* and the application for the planning permit was referred to the Executive Director of Heritage Victoria as a determining referral authority, a permit is not required.

Specific exemptions may also apply to your registered place or object. If applicable, these are listed below. Specific exemptions are tailored to the conservation and management needs of an individual registered place or object and set out works and activities that are exempt from the requirements of a permit. Specific exemptions prevail if they conflict with general exemptions.

Find out more about heritage permit exemptions [here](#).

Construction dates        1860,  
Heritage Act Categories   Registered place,  
Hermes Number            3102  
Property Number

---

## History

Associated People: Owner ARNOTT, GEORGE;

## Extent of Registration

### AMENDMENT OF REGISTER OF HISTORIC BUILDINGS

Historic Building No. 1180:

St Elmo, 127 Elizabeth Street, West Geelong, City of Greater Geelong.

Extent:

To the extent of:

1. All of the building known as St Elmo, 127 Elizabeth Street, West Geelong marked B-1 on Plan 603921 endorsed by the Chairperson, Historic Buildings Council and held by the Director, Historic Buildings Council.
2. Part of the land described in Memorial No. 819 Book No. 441 marked L-1 on Plan 603921 endorsed by the Chairperson, Historic Buildings Council and held by the Director, Historic Buildings Council.

[*Victoria Government Gazette* No. G15 18 April 1996 pp.958-959]

*This place/object may be included in the Victorian Heritage Register pursuant to the Heritage Act 2017. Check the Victorian Heritage Database, selecting 'Heritage Victoria' as the place source.*

*For further details about Heritage Overlay places, contact the relevant local council or go to Planning Schemes Online <http://planningschemes.dpcd.vic.gov.au/>*