

PHOLIOTA

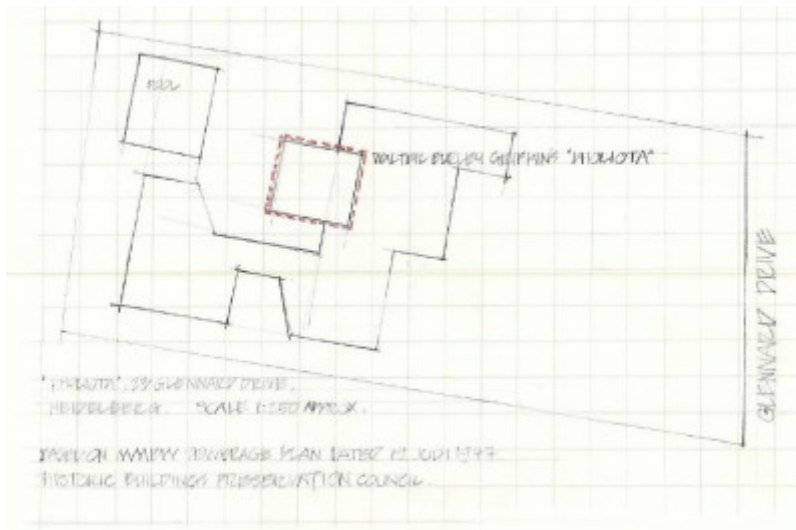

h00479 pholiota glenard drive
eaglemont west wall she
project 2003



H0479 pholiota plan

Location

23 GLENARD DRIVE EAGLEMONT, BANYULE CITY

Municipality

BANYULE CITY

Level of significance

Registered

Victorian Heritage Register (VHR) Number

H0479

Heritage Overlay Numbers

HO27

VHR Registration

October 29, 1980

Heritage Listing

Victorian Heritage Register

Statement of Significance

Last updated on - June 26, 2007

What is significant?

Pholiota was built as the home of architects Walter and Marion Griffin in 1920 on an allotment in the Glenard Estate, Eaglemont, which had been laid out by Griffin in 1915. Built using Knitlock concrete blocks, the small house was designed with a highly innovative plan. Subsequent additions, particularly in 1938, have concealed the original building from the street, however the original dwelling can still be recognised.

Arriving in Australia permanently in 1914, American architects, Walter Burley Griffin (1876-1937) and Marion Mahony (1871-1961) moved to Melbourne in 1915. In 1919 their first experiment with minimalist dwelling design was a pair of cottages, Gumnuts and Marnham, Frankston, designed for their use as a weekend retreat. These prototype Knitlock cottages employed a construction system of concrete wall tile units that Griffin had patented in 1917. This system was developed as an economical, flexible and quick do-it-yourself construction system, with machine produced standard concrete tiles, or segments, which were fitted together on site. Machines and timber moulds were used to cast the concrete tiles, which were basically of two types; the vertebral, quadrant shaped block, that formed the framework and the distinctive vertical piers; and the tesseral block that provided the wall infill. The former blocks formed columns and corners and the latter were interlocked back to back with staggered joints, resulting in smooth surfaces both externally and internally, and the facility to incorporate steel reinforcing rods in the core between blocks.

The Griffins utilised the same Knitlock construction system in the design of their first home, Pholiota, on land they owned on the Glenard Estate, adjacent to that of architect, Roy Lippincott and his wife, Walter's sister. A very small house of innovative design and novel construction system, Pholiota was controversial in terms of building regulations at the time of construction.

Pholiota is a small, single storeyed house with square plan, laid out using modules, defined by the vertical piers of the Knitlock system, and an overall dimension of 21 feet (6.4 metres). It was designed as a cross within a square, containing a central, square room with a pyramidal ceiling, surrounded by a series of eight small alcoves with flat ceilings. These alcoves originally contained the entrance and service areas in the corners and a piano, fireplace and two bedroom alcoves on the sides. Curtains were used to partition the corner alcoves, and bedroom spaces when required. Casement windows, with decorative diagonal glazing bars, extend to the ceiling line, and were designed to open inwards using a simple nail pivot. The floor was originally of red brick laid directly on the ground using a herringbone pattern, and this is evident in the former kitchen and bathroom areas. The roof was clad in terracotta tiles, rather than matching Knitlock roof tiles as used at Gumnuts and Marnham, patented in 1918.

Pholiota was sold in 1925 after Walter left Melbourne to join his wife in Sydney and the house then had a series of owners. In 1938 extensive additions were made along its eastern frontage, doubling the size of the house and obscuring it from the street. The original kitchen and bathroom were removed at this stage. Pholiota was again extended in 1975 with the addition of a brick wing along the southern boundary and a second storey was added

to part of this in the 1990s. As a result only the western elevation of the original building remains entirely unobstructed. Much of the original fabric and finishes of the interior have been altered, including the floor and ceiling, however the Knitlock wall tiles are still evident on all sides of the room.

How is it significant?

Pholiota, Eaglemont is of architectural, historical and scientific (technical) significance to the State of Victoria.

Why is it significant?

Pholiota is of architectural significance as a rare surviving example of the minimalist house planning developed by Griffin. Its internal planning, with central open plan living space and surrounding alcoves, was a highly distinctive example of a one roomed house; one of only three realised by Griffin. The others were adjacent cottages in Frankston, Gumnuts (VHR H1328) and Markham (demolished 1983). Although altered, the original plan form at Pholiota can still be seen.

Pholiota, Eaglemont is of historical significance for its association with internationally renowned American architects, Walter and Marion Griffin. Located in one of Walter's own subdivisions, it is important as a rare example of a house the Griffin's designed for their own use. Marion's high regard for Pholiota is evident in her memoirs, where she refers to it as 'one of the most perfect buildings ever built'.

Pholiota, Eaglemont is of scientific (technical) significance as an example of the use of the innovative Knitlock system. Few Knitlock buildings were constructed and fewer remain extant, and Pholiota is one of a small number that survive in Victoria designed by Griffin. Although in an altered state, the original construction is still evident. Other surviving examples include the earliest known example, Gumnuts, Frankston, 1919 (VHR H1328) and the Jefferies House, Surrey Hills, 1924 (VHR H0461).

[Online Data Upgrade Project 2007]

Permit Exemptions

General Exemptions:

General exemptions apply to all places and objects included in the Victorian Heritage Register (VHR). General exemptions have been designed to allow everyday activities, maintenance and changes to your property, which don't harm its cultural heritage significance, to proceed without the need to obtain approvals under the Heritage Act 2017.

Places of worship: In some circumstances, you can alter a place of worship to accommodate religious practices without a permit, but you must [notify](#) the Executive Director of Heritage Victoria before you start the works or activities at least 20 business days before the works or activities are to commence.

Subdivision/consolidation: Permit exemptions exist for some subdivisions and consolidations. If the subdivision or consolidation is in accordance with a planning permit granted under Part 4 of the *Planning and Environment Act 1987* and the application for the planning permit was referred to the Executive Director of Heritage Victoria as a determining referral authority, a permit is not required.

Specific exemptions may also apply to your registered place or object. If applicable, these are listed below. Specific exemptions are tailored to the conservation and management needs of an individual registered place or object and set out works and activities that are exempt from the requirements of a permit. Specific exemptions prevail if they conflict with general exemptions.

Find out more about heritage permit exemptions [here](#).

Specific Exemptions:

General Conditions: 1. All exempted alterations are to be planned and carried out in a manner which prevents

damage to the fabric of the registered place or object. General Conditions: 2. Should it become apparent during further inspection or the carrying out of works that original or previously hidden or inaccessible details of the place or object are revealed which relate to the significance of the place or object, then the exemption covering such works shall cease and Heritage Victoria shall be notified as soon as possible. Note: All archaeological places have the potential to contain significant sub-surface artefacts and other remains. In most cases it will be necessary to obtain approval from the Executive Director, Heritage Victoria before the undertaking any works that have a significant sub-surface component.

General Conditions: 3. If there is a conservation policy and plan all works shall be in accordance with it. Note: A Conservation Management Plan or a Heritage Action Plan provides guidance for the management of the heritage values associated with the site. It may not be necessary to obtain a heritage permit for certain works specified in the management plan.

General Conditions: 4. Nothing in this determination prevents the Executive Director from amending or rescinding all or any of the permit exemptions. General Conditions: 5. Nothing in this determination exempts owners or their agents from the responsibility to seek relevant planning or building permits from the responsible authorities where applicable. Minor Works : Note: Any Minor Works that in the opinion of the Executive Director will not adversely affect the heritage significance of the place may be exempt from the permit requirements of the Heritage Act. A person proposing to undertake minor works must submit a proposal to the Executive Director. If the Executive Director is satisfied that the proposed works will not adversely affect the heritage values of the site, the applicant may be exempted from the requirement to obtain a heritage permit. If an applicant is uncertain whether a heritage permit is required, it is recommended that the permits co-ordinator be contacted.

Construction dates	1920,
Architect/Designer	Griffin, Walter Burley,
Heritage Act Categories	Registered place,
Hermes Number	348
Property Number	

History

Pholiota was built as the home of architects Walter and Marion Griffin in 1920 on an allotment in the Glenard Estate, Eaglemont, which had been laid out by Griffin in 1915. Built using Knitlock concrete blocks, the small house was designed with a highly innovative plan. Subsequent additions, particularly in 1938, have concealed the original building from the street, however the original dwelling can still be recognised.

Arriving in Australia permanently in 1914, American architects, Walter Burley Griffin (1876-1937) and Marion Mahony (1871-1961) moved to Melbourne in 1915. In 1919 their first experiment with minimalist dwelling design was a pair of cottages, Gumnuts and Marnham, Frankston, designed for their use as a weekend retreat. These prototype Knitlock cottages employed a construction system of concrete wall tile units that Griffin had patented in 1917. This system was developed as an economical, flexible and quick do-it-yourself construction system, with machine produced standard concrete tiles, or segments, which were fitted together on site. Machines and timber moulds were used to cast the concrete tiles, which were basically of two types; the vertebral, quadrant shaped block, that formed the framework and the distinctive vertical piers; and the tesseral block that provided the wall infill. The former blocks formed columns and corners and the latter were interlocked back to back with staggered joints, resulting in smooth surfaces both externally and internally, and the facility to incorporate steel reinforcing rods in the core between blocks.

The Griffins utilised the same Knitlock construction system in the design of their first home, Pholiota, on land they owned on the Glenard Estate, adjacent to that of architect, Roy Lippincott and his wife, Walter's sister. A very small house of innovative design and novel construction system, Pholiota was controversial in terms of building regulations at the time of construction.

The draft statement of significance and the above history were produced as part of an Online Data Upgrade Project 2007. Sources were as follows:

Heritage Alliance, Conservation Architects and Heritage Consultants. *'Pholiota' Walter and Marion Griffin Residence, 23 Glenard Drive, Eaglemont. Melbourne 2004*

Extent of Registration

Historic Building No. 479: 'Pholiota', 23 Glennard Drive, Eaglemont.
[Victoria Government Gazette No. 93 - 29 October 1980 p.3664]

This place/object may be included in the Victorian Heritage Register pursuant to the Heritage Act 2017. Check the Victorian Heritage Database, selecting 'Heritage Victoria' as the place source.

For further details about Heritage Overlay places, contact the relevant local council or go to Planning Schemes Online <http://planningschemes.dpcd.vic.gov.au/>