

MYRNIONG



H01178 1 myrniong front
feb2003



H01178 myrniong hensley
park road hamilton front view
aug1994



H01178 myrniong back2
feb2003



H01178 myrniong feb2003



H01178 myrniong front2
feb2003



H01178 myrniong side
feb2003



H01178 myrniong side2
feb2003



H01178 myrniong back
feb2003



h01178 myrniong cnr kent
and macarthur st hamilton
front view lshe project 2003



h01178 myrniong cnr kent
and macarthur st hamilton
rear roof line she project 2003

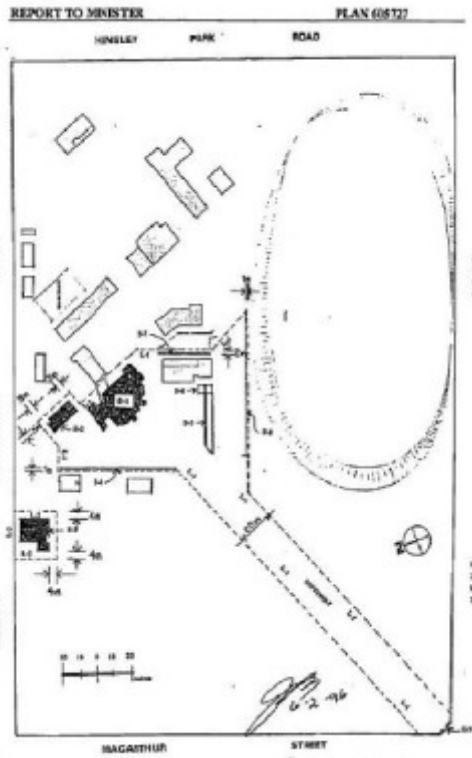

h01178 plan h1178

Location

KENT ROAD AND MCARTHUR STREET HAMILTON, SOUTHERN GRAMPIANS SHIRE

Municipality

SOUTHERN GRAMPIANS SHIRE

Level of significance

Registered

Victorian Heritage Register (VHR) Number

H1178

Heritage Overlay Numbers

HO299

VHR Registration

April 18, 1996

Heritage Listing

Statement of Significance

Last updated on - May 7, 1999

What is significant?

Myrniong, built in 1906-07 as a country residence for wealthy Melbourne businessman Leslie Jenner, consists of a large house, manager's residence and stables. The main house, which is constructed of tuck pointed red brick, half timbering and rough cast, is dominated by a complex roof of asymmetrical composition, consisting of hips, gables, tower-like elements, dormers and tall chimneys. The grounds, inspired by the 'gardenesque' style of garden design, contain several remnant elements such as brick fences, brick and stone walls and a cast iron arbour.

How is it significant?

Myrniong is of architectural and social significance to Victoria.

Why is it significant?

Myrniong is of architectural significance as an essentially intact, large domestic complex designed in the 'Queen Anne' style and situated on the outskirts of a wealthy provincial centre. The interiors, which are influenced by the Arts and Crafts movement, are important for the fine Art Nouveau-inspired elements such as leadlights, door furniture, stair balustrading and light fittings. The outstanding and extensive use of stained and carved timbers fittings and finishes throughout the house, particularly for wall panelling, ceiling linings, fire surrounds and built-in furniture, is also of interest.

Myrniong is socially significant as an example of the quality of life experienced by financially successful settlers of the Western district, many of whom relocated from Melbourne around the turn of the century.

Permit Exemptions

General Exemptions:

General exemptions apply to all places and objects included in the Victorian Heritage Register (VHR). General exemptions have been designed to allow everyday activities, maintenance and changes to your property, which don't harm its cultural heritage significance, to proceed without the need to obtain approvals under the Heritage Act 2017.

Places of worship: In some circumstances, you can alter a place of worship to accommodate religious practices without a permit, but you must [notify](#) the Executive Director of Heritage Victoria before you start the works or activities at least 20 business days before the works or activities are to commence.

Subdivision/consolidation: Permit exemptions exist for some subdivisions and consolidations. If the subdivision or consolidation is in accordance with a planning permit granted under Part 4 of the *Planning and Environment Act 1987* and the application for the planning permit was referred to the Executive Director of Heritage Victoria as a determining referral authority, a permit is not required.

Specific exemptions may also apply to your registered place or object. If applicable, these are listed below. Specific exemptions are tailored to the conservation and management needs of an individual registered place or object and set out works and activities that are exempt from the requirements of a permit. Specific exemptions prevail if they conflict with general exemptions.

Find out more about heritage permit exemptions [here](#).

Construction dates 1906,
Heritage Act Categories Registered place,
Other Names HAMILTON COLLEGE JUNIOR SCHOOL,
Hermes Number 4661
Property Number

History

Associated People: Owner LESLIE JENNER;

Extent of Registration

AMENDMENT OF REGISTER OF HISTORIC BUILDINGS

Historic Building No. 1178:

Myrniong, Hensley Park Road, Hamilton, Southern Grampians Shire.

Extent:

To the extent of:

1. All of the building known as Myrniong (B-1), the former manager's residence (B-2), stables (B-3), brick fence (B-4), garden edging (B-5), arbour (B-6), brick retaining wall (B-7), stone wall (B-8), and gate posts (B-9); marked on Plan 605727 endorsed by the Chairperson, Historic Buildings Council and held by the Director, Historic Buildings Council.
- 2 Parts of the land described in Memorial Book No. 835 No. 342 marked L-1 and L-2 on Plan 605727 endorsed by the Chairperson, Historic Buildings Council and held by the Director, Historic Buildings Council.
[Victoria Government Gazette No. G15 18 April 1996 p.960]

This place/object may be included in the Victorian Heritage Register pursuant to the Heritage Act 2017. Check the Victorian Heritage Database, selecting 'Heritage Victoria' as the place source.

For further details about Heritage Overlay places, contact the relevant local council or go to Planning Schemes Online <http://planningschemes.dpcd.vic.gov.au/>