

FORMER GEELONG POST OFFICE



FORMER GEELONG POST
OFFICE SOHE 2008



1 former geelong post office
geelong clock tower apr1997

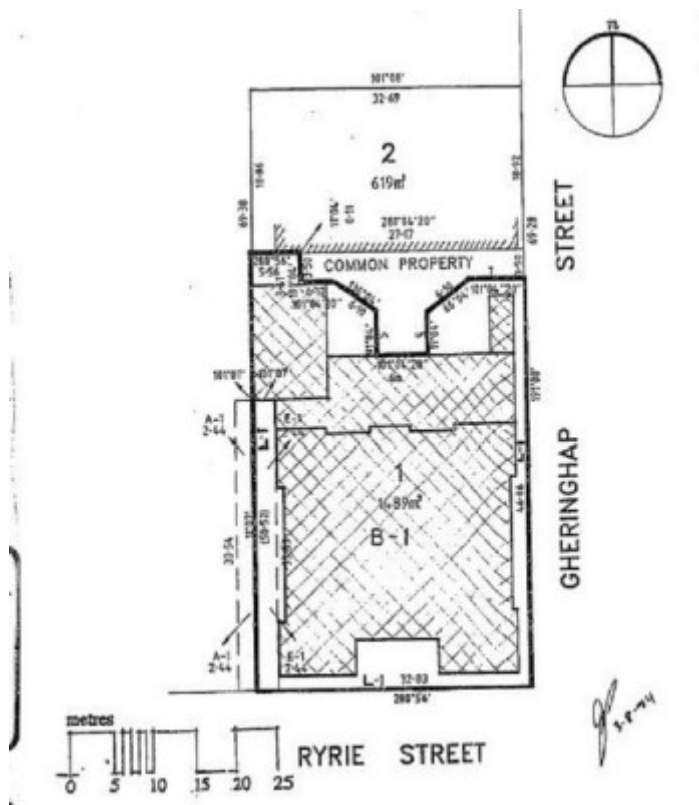

h01046 plan h1046

Location

83 RYRIE STREET GEELONG, GREATER GEELONG CITY

Municipality

GREATER GEELONG CITY

Level of significance

Registered

Victorian Heritage Register (VHR) Number

H1046

Heritage Overlay Numbers

HO213

VHR Registration

September 22, 1994

Heritage Listing

Victorian Heritage Register

Statement of Significance

Last updated on - May 4, 1999

The former Geelong Post Office, designed by JH Marsden, assisted by JH Brabin, of the Public Works Department, was built in 1889-90 by David Kinnaird. The two storey rendered brick building with an ornamental tower is prominently sited at the intersection of Ryrie and Gheringhap Streets. The clock and bell chimes were installed in the tower in 1911.

The former Post Office is a notable example of the architects JH Marsden and JH Brabin, who also designed the facade of the Collingwood Post Office. One of the largest regional post offices in Victoria, the building demonstrates the architectural flamboyance evident in designs by the Public Works Department following the appointment of Henry Bastow as senior architect. The substantial two storey loggia surmounted by dormers and multiple pediments, is a particularly fine example of a late Victorian boom style public building with a French Second Empire influence.

The building represents the important function played by the post office in a large regional centre. It was the centre of the communications network for Geelong, and in 1912 was the location for the first automatic telephone exchange in the southern hemisphere, pioneering the development of this technology in Australia.

The clock and chimes of the Post Office's tower, which were installed in 1910 as a result of a public subscription to commemorate King Edward VII, have social significance as an expression of the community's strong sentiments regarding the late King and demonstrates the close ties which existed at that time between Australia and Britain.

Permit Exemptions

General Exemptions:

General exemptions apply to all places and objects included in the Victorian Heritage Register (VHR). General exemptions have been designed to allow everyday activities, maintenance and changes to your property, which don't harm its cultural heritage significance, to proceed without the need to obtain approvals under the Heritage Act 2017.

Places of worship: In some circumstances, you can alter a place of worship to accommodate religious practices without a permit, but you must **notify** the Executive Director of Heritage Victoria before you start the works or activities at least 20 business days before the works or activities are to commence.

Subdivision/consolidation: Permit exemptions exist for some subdivisions and consolidations. If the subdivision or consolidation is in accordance with a planning permit granted under Part 4 of the *Planning and Environment Act 1987* and the application for the planning permit was referred to the Executive Director of Heritage Victoria as a determining referral authority, a permit is not required.

Specific exemptions may also apply to your registered place or object. If applicable, these are listed below. Specific exemptions are tailored to the conservation and management needs of an individual registered place or object and set out works and activities that are exempt from the requirements of a permit. Specific exemptions prevail if they conflict with general exemptions.

Find out more about heritage permit exemptions [here](#).

Construction dates	1889,
Architect/Designer	Marsden, John Hudson,
Heritage Act Categories	Registered place,
Hermes Number	4699
Property Number	

History

Associated People:

Extent of Registration

AMENDMENT OF REGISTER OF HISTORIC BUILDINGS

Historic Building No. 1046.

Former Geelong Post Office, corner Ryrie and Gheringhap Streets, Geelong

(To the extent of:

1. All the building known as the former Geelong Post Office, marked B-1 on Plan 605788 endorsed by the Chairperson, Historic Buildings Council and held by the Director, Historic Buildings Council.
2. All of the land described in Certificate of Title Volume 5758 Folio 1151442 marked L-1, excluding the land marked Common Property on Plan 605788, endorsed by the Chairperson, Historic Buildings Council and held by the Director, Historic Buildings Council.)

[*Victoria Government Gazette* No. G38 22 September 1994 pp.2290-2291]

This place/object may be included in the Victorian Heritage Register pursuant to the Heritage Act 2017. Check the Victorian Heritage Database, selecting 'Heritage Victoria' as the place source.

For further details about Heritage Overlay places, contact the relevant local council or go to Planning Schemes Online <http://planningschemes.dpcd.vic.gov.au/>