

DOROTHY TERRACE



DOROTHY TERRACE SOHE
2008

H1037 1 dorothy terrace 36
lulie street abbotsford front
view

REPORT TO MINISTER PLAN N° 695702/4

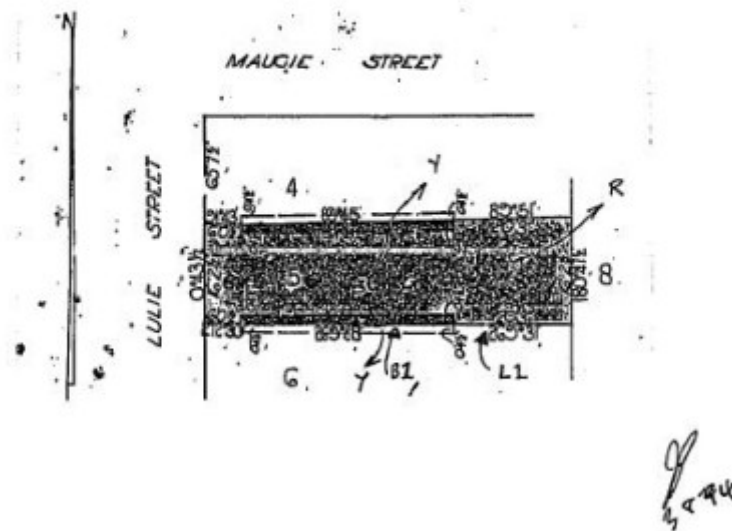

H1037 plan

Location

40 LULIE STREET ABBOTSFORD, YARRA CITY

Municipality

YARRA CITY

Level of significance

Registered

Victorian Heritage Register (VHR) Number

H1037

Heritage Overlay Numbers

HO29

VHR Registration

September 22, 1994

Heritage Listing

Victorian Heritage Register

Statement of Significance

Last updated on - July 21, 1999

What is significant?

Dorothy Terrace, Abbotsford, was built in 1888 on land owned by W. T. Chidzey, and comprises two commercial and six residential buildings. Situated opposite the railway line, the terrace represents classic 1880s boom speculative development near transport nodes.

How is it significant?

Dorothy Terrace is of historical and architectural significance to the State of Victoria.

Why is it Significant?

Dorothy Terrace is of historical significance through the incorporation of corner shops into a residential development, which is reflective of the dynamics of daily urban life prior to the development of effective refrigeration and the later development of large shopping centres. The location of the terrace near a railway line shows the impact of railway expansion in the latter decades of the 19th century on speculative suburban growth.

Dorothy Terrace is of architectural significance as a rare example of a residential two-storey building type which incorporates six single-fronted terraced dwellings flanked by corner shops. It occupies the frontage of one whole block, and is a representative example of a polychrome boom style terrace.

Permit Exemptions

General Exemptions:

General exemptions apply to all places and objects included in the Victorian Heritage Register (VHR). General exemptions have been designed to allow everyday activities, maintenance and changes to your property, which don't harm its cultural heritage significance, to proceed without the need to obtain approvals under the Heritage Act 2017.

Places of worship: In some circumstances, you can alter a place of worship to accommodate religious practices without a permit, but you must [notify](#) the Executive Director of Heritage Victoria before you start the works or

activities at least 20 business days before the works or activities are to commence.

Subdivision/consolidation: Permit exemptions exist for some subdivisions and consolidations. If the subdivision or consolidation is in accordance with a planning permit granted under Part 4 of the *Planning and Environment Act 1987* and the application for the planning permit was referred to the Executive Director of Heritage Victoria as a determining referral authority, a permit is not required.

Specific exemptions may also apply to your registered place or object. If applicable, these are listed below. Specific exemptions are tailored to the conservation and management needs of an individual registered place or object and set out works and activities that are exempt from the requirements of a permit. Specific exemptions prevail if they conflict with general exemptions.

Find out more about heritage permit exemptions [here](#).

Construction dates 1888,
Heritage Act Categories Registered place,
Hermes Number 4830
Property Number

History

Associated People: Owner W T CHIDZEY;

Extent of Registration

AMENDMENT OF REGISTER OF HISTORIC BUILDINGS

Historic Building No. 1037.

Dorothy Terrace, 40 Lulie Street, Abbotsford, City of Collingwood

(To the extent of:

1. All of the building marked B1 on Plan No. 605702/4 by the Chairperson, Historic Buildings Council and held by the Director, Historic Buildings Council; and
2. All of the land marked L1 on Plan No. 605702/4 signed by the Chairperson, Historic Buildings Council and held by the Director, Historic Buildings Council, being part of the land described in Certificate of Title Volume 8024 Folio 193.)

[*Victoria Government Gazette* No. G38 22 September 1994 pp.2291-2292]

This place/object may be included in the Victorian Heritage Register pursuant to the Heritage Act 2017. Check the Victorian Heritage Database, selecting 'Heritage Victoria' as the place source.

For further details about Heritage Overlay places, contact the relevant local council or go to Planning Schemes Online <http://planningschemes.dpcd.vic.gov.au/>