

# FORMER ARARAT LOCOMOTIVE DEPOT AND TURNTABLE



h01093 locodepot ararat  
march95



h01093 turntable ararat  
march95

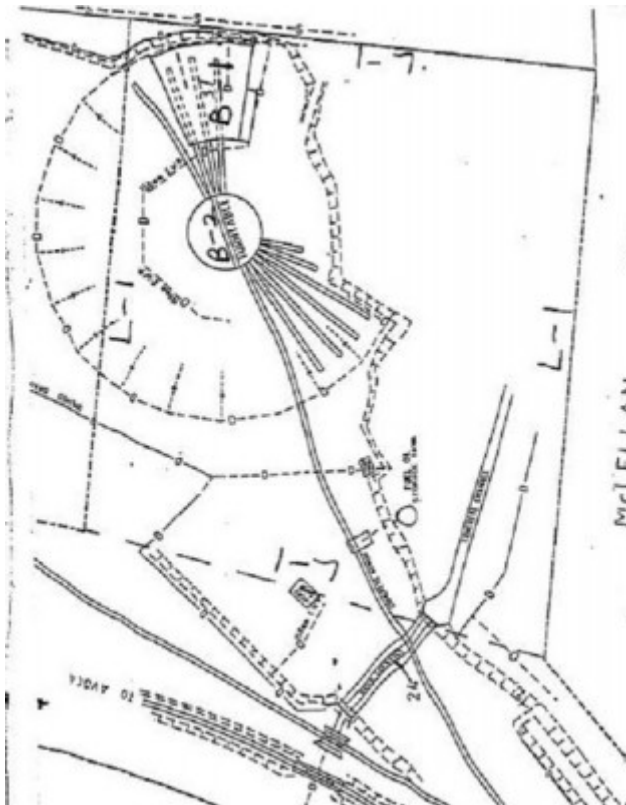

h01093 plan h1093

## Location

ARARAT RAILWAY COMPLEX, HIGH STREET ARARAT, ARARAT RURAL CITY

## Municipality

ARARAT RURAL CITY

## Level of significance

Registered

## Victorian Heritage Register (VHR) Number

H1093

## Heritage Overlay Numbers

HO2

HO67

## VHR Registration

September 14, 1995

## Heritage Listing

Victorian Heritage Register

---

## Statement of Significance

Last updated on - May 5, 1999

What is significant?

Ararat Railway Station was opened on 7 April 1875 and the main station buildings were completed by July 1875. In 1928 a new corrugated iron locomotive shed was built, replacing the original structure. The new shed was originally a 24 road round house of which only 3 bays now remain. A 15 tonne crane and 3 work pits still survive in the building. An 85 feet turntable was built at the same time. The turntable is set within a concrete lined pit and located at what was formerly the centre of the round locomotive shed. It is operated by an electric motor with a manually operated lever. The water towers were also erected in the late 1920s.

How is it significant?

The Former Ararat Locomotive Depot is of architectural and historic significance to Victoria.

The Former Ararat Locomotive Depot has an association with the important role played by the railway in the economic growth of Victoria. The Ararat line was one of the lines built during the 1870s which connected the major rural towns with Melbourne. Ararat was included on the main western route and as the railway continued to expand it was included on the main line to South Australia. Ararat became an important junction in the interstate and port-hinterland rail systems with the construction of the Portland line (1877), Avoca (1890) and Gheringhap (1913). The substantial locomotive depot, constructed to house and maintain large numbers of locomotives and rolling stock, recalls the period when the Ararat yards were the busiest in rural Victoria.

The former locomotive shed is a rare example of a building type. The Ararat structure and similar shed at Traralgon are the last known remnants of the round house type of locomotive shed to survive in Victoria.

The turntable, constructed in 1928, is an extraordinary example of a building type, being the longest turntable in the state and the first to be electrically operated.

## Permit Exemptions

### General Exemptions:

General exemptions apply to all places and objects included in the Victorian Heritage Register (VHR). General exemptions have been designed to allow everyday activities, maintenance and changes to your property, which don't harm its cultural heritage significance, to proceed without the need to obtain approvals under the Heritage Act 2017.

**Places of worship:** In some circumstances, you can alter a place of worship to accommodate religious practices without a permit, but you must **notify** the Executive Director of Heritage Victoria before you start the works or activities at least 20 business days before the works or activities are to commence.

**Subdivision/consolidation:** Permit exemptions exist for some subdivisions and consolidations. If the subdivision or consolidation is in accordance with a planning permit granted under Part 4 of the *Planning and Environment Act 1987* and the application for the planning permit was referred to the Executive Director of Heritage Victoria as a determining referral authority, a permit is not required.

Specific exemptions may also apply to your registered place or object. If applicable, these are listed below. Specific exemptions are tailored to the conservation and management needs of an individual registered place or object and set out works and activities that are exempt from the requirements of a permit. Specific exemptions prevail if they conflict with general exemptions.

Find out more about heritage permit exemptions [here](#).

Construction dates	1928,
Heritage Act Categories	Registered place,
Other Names	TURNTABLE,
Hermes Number	4848
Property Number	

---

## History

Associated People: Owner PUBLIC TRANSPORT CORPORATION;

## Extent of Registration

### AMENDMENT OF REGISTER OF HISTORIC BUILDINGS

Historic Building No. 1093:

Former Locomotive Depot, Ararat Railway Complex, Ararat, Rural City of Ararat.

Extent:

1. All of the building known as the former locomotive shed and all of the structures known as the turntable and the water towers marked B-1, B-2, B-3 and B-4 respectively on Plan 607105 endorsed by the Chairperson, Historic Buildings Council and held by the Director, Historic Buildings Council.
2. All of the land marked L-1 on Plan 607105 and all of the land to an area of 5 metres curtilage around the water towers marked L-2 on Plan 605933 being part of the land reserved for railway purposes in Book 315 Memorial 366, endorsed by the Chairperson, Historic Buildings Council and held by the Director, Historic Buildings Council. [*Victoria Government Gazette* No. G36 14 September 1995 p.2535]

*This place/object may be included in the Victorian Heritage Register pursuant to the Heritage Act 2017. Check the Victorian Heritage Database, selecting 'Heritage Victoria' as the place source.*

*For further details about Heritage Overlay places, contact the relevant local council or go to Planning Schemes Online <http://planningschemes.dpcd.vic.gov.au/>*