

# HOLY TRINITY ANGLICAN CHURCH AND SUNDAY SCHOOL HALL



HOLY TRINITY ANGLICAN CHURCH AND SUNDAY SCHOOL HALL SOHE 2008



1 holy trinity anglican church and sunday school davy street taradale front view



h01350 holy trinity anglican church and sunday school davy street taradale inside church she project 2003



h01350 holy trinity anglican church and sunday school davy street taradale north face she project 2003

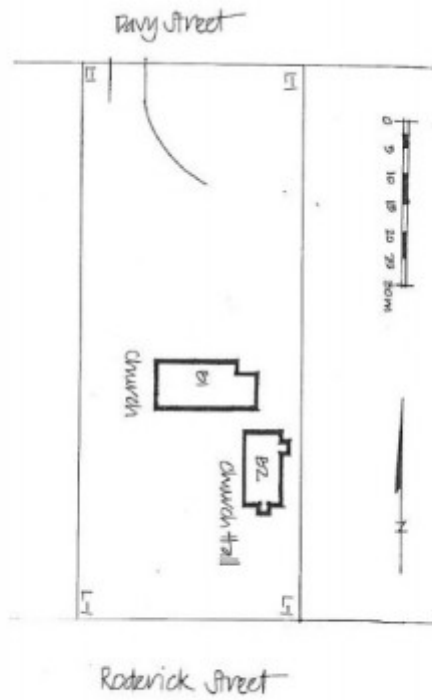

H1350 H1350 plan

---

### Location

DAVY STREET TARADALE, MOUNT ALEXANDER SHIRE

### Municipality

MOUNT ALEXANDER SHIRE

### Level of significance

Registered

### Victorian Heritage Register (VHR) Number

H1350

### Heritage Overlay Numbers

HO851

### VHR Registration

September 18, 1997

### Heritage Listing

## Statement of Significance

Last updated on - May 13, 1999

The Holy Trinity Anglican Church, a rendered brick building situated in Davy Street, Taradale, was constructed in 1859 and replaced an earlier, 1856, timber church which became used as the Sunday School and Church Hall, a function which it has retained to this day. The current church was constructed to the design of architect and surveyor, Thomas Turner in an early Gothic revival style, popular for church design during the nineteenth century and styled after English parish churches.

The Holy Trinity Anglican Church and Sunday School Hall at Taradale is of historical and architectural importance to the state of Victoria.

The church and hall are an important element of the early development of the Taradale area as a result of the goldfields in central Victoria. The buildings illustrate the growth of the town, like many other goldmining centres, from a temporary settlement of timber buildings, to an established centre of population and with the construction of permanent structures. The Taradale Church of England site illustrates both phases of the town's early development.

The Holy Trinity Anglican Church is of architectural merit as a well designed example of the picturesque Gothic. Picturesqueness, an essential characteristic of successful Gothic buildings, is a guiding concern of the design of the Taradale Anglican Church, which employs its elevated site and surrounding vegetation to emphasise the vertical aspects of the building, its importance in the town and its spiritual associations. The composition of the building is interesting with an unusual treatment of the west front. The building contains many features of significance including early timber pews, early coloured and stained glazing, moveable lectern, pulpit, an honour board and a marble memorial tablet.

## Permit Exemptions

### General Exemptions:

General exemptions apply to all places and objects included in the Victorian Heritage Register (VHR). General exemptions have been designed to allow everyday activities, maintenance and changes to your property, which don't harm its cultural heritage significance, to proceed without the need to obtain approvals under the Heritage Act 2017.

**Places of worship:** In some circumstances, you can alter a place of worship to accommodate religious practices without a permit, but you must [notify](#) the Executive Director of Heritage Victoria before you start the works or activities at least 20 business days before the works or activities are to commence.

**Subdivision/consolidation:** Permit exemptions exist for some subdivisions and consolidations. If the subdivision or consolidation is in accordance with a planning permit granted under Part 4 of the *Planning and Environment Act 1987* and the application for the planning permit was referred to the Executive Director of Heritage Victoria as a determining referral authority, a permit is not required.

Specific exemptions may also apply to your registered place or object. If applicable, these are listed below. Specific exemptions are tailored to the conservation and management needs of an individual registered place or object and set out works and activities that are exempt from the requirements of a permit. Specific exemptions prevail if they conflict with general exemptions.

Find out more about heritage permit exemptions [here](#).

## Specific Exemptions:

### EXEMPTIONS FROM PERMITS:

(Classes of works or activities which may be undertaken without a permit under Part 4 of the Heritage Act 1995)

#### Church

Installation of carpet floor coverings is permit exempt except over tiled and marbled areas. Carpet must be in heritage theme.

#### Hall

Installation/removal of floor coverings is permit exempt

Interior painting, wall papering to walls and ceilings is exempt providing painting/papering does not remove evidence of the building's original paint and other existing decorative surfaces.

Installation of curtain tracks, rods blinds and other window dressings is permit exempt

Refurbishment of bathrooms and toilets including removal of existing sanitary fixtures and associated piping, mirrors, and installation of new fixtures is permit exempt provided new plumbing is not externally exposed..

Removal/installation of kitchen benches and fixtures (stoves, dishwashers etc.) , including associated plumbing and wiring is permit exempt provided new plumbing is not externally exposed.

#### Both Buildings

Installation of hydronic, or concealed radiant (Ceiling Foil Radiant Heating or under carpet heating) type heating, is permit exempt provided that the installation does not damage existing skirtings, architraves and the location heating unit (boiler etc) is concealed from view.

Re-wiring is permit exempt provided that all new wiring is fully concealed and any original light switches, pull cords or GPO's are retained in-situ.

Installation of hooks, nails and other devices for hanging of paintings, mirrors, and other wall-mounted works of art are permit exempt.

Installation of bulk insulation to the roof space is permit exempt.

Installation of smoke detectors is permit exempt.

Removal of extraneous wiring and aerials is permit exempt

### NOTE:

#### Conservation Plans

Ideally all buildings/objects/trees/complexes on the Register should have a Conservation Plan prepared by a suitably qualified practitioner and to the standards of the Burra Charter.

Consultants preparing a conservation plan are encouraged to address the possibility of permits exemptions

Construction dates	1859,
Architect/Designer	Turner, Thomas,
Heritage Act Categories	Registered place,
Hermes Number	5257
Property Number	

---

## History

Associated People:

## Extent of Registration

1. All the buildings known as the Holy Trinity Anglican Church and Sunday School Hall and marked B1 and B2 on Diagram 607945.
2. All the land marked L1 on Diagram 607945 held by the Executive Director, being all the land described in Certificate of Title Vol. 9704 Folio 987 and Vol. 9704 Folio 988.

*This place/object may be included in the Victorian Heritage Register pursuant to the Heritage Act 2017. Check the Victorian Heritage Database, selecting 'Heritage Victoria' as the place source.*

*For further details about Heritage Overlay places, contact the relevant local council or go to Planning Schemes Online <http://planningschemes.dpcd.vic.gov.au/>*