CENTRAL PARK CONSERVATORY



CENTRAL PARK
CONSERVATORY SOHE
2008



1 central park conservatory
wattletree road malvern front
view



central park conservatory
wattletree road malvern rear
view



central park conservatory
wattletree road malvern side
view

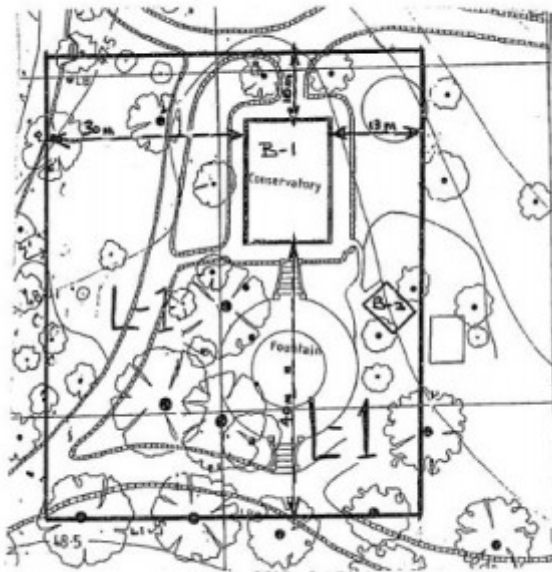

H0908 plan

Location

83-141 BURKE ROAD MALVERN EAST, STONNINGTON CITY

Municipality

STONNINGTON CITY

Level of significance

Registered

Victorian Heritage Register (VHR) Number

H0908

Heritage Overlay Numbers

HO114

VHR Registration

January 22, 1992

Heritage Listing

Statement of Significance

Last updated on - August 10, 1999

What is significant?

The Central Park Conservatory was constructed in 1927. It measures 10 metres in length by 7 metres in width. It is divided into three distinct areas, the central being used for tropical plants, with display shelves located on either side with feature tiered shelving. The conservatory was constructed of wire-reinforced clear glass in a structural steel frame on a concrete base.

How is it significant?

The Central Park Conservatory is of historical, scientific and aesthetic significance to the State of Victoria.

Why is it significant?

The Central Park Conservatory is of historical significance as one of the oldest and largest extant public conservatories in Victoria. Only two other public conservatories comparable to that at Central Park exist in the State: the Rosalind Park conservatory at Bendigo, constructed in 1897, (extensive alterations were undertaken in 1978); and the conservatory in the Fitzroy gardens, which was constructed in 1930. Several other public conservatories have been demolished, making the Central Park Conservatory a now rare example of this kind of structure.

The Central Park Conservatory is of scientific significance as evidence of the growth in interest in exotic plants, and the public display of plants, in the inter-war years. Its large size, tiered shelves, and expansive clear glass walls emphasise the display purposes of the conservatory, perhaps reflecting a growing knowledge of horticultural matters on behalf of a populace that was well endowed with public parks and gardens. This interest in exotic plants would not have been possible without the provision of the adjacent boiler house, integral to the functioning of conservatories at that time.

The Central Park Conservatory is of aesthetic significance because of its contribution to the landscape values of one of Melbourne's best Edwardian parks, Malvern's Central Park. The conservatory remains in its original form, still on its initial central axis. It provides a focal point within the park, as well as providing a demarcation, visually and geographically, between the active and passive areas of the park.

Permit Exemptions

General Exemptions:

General exemptions apply to all places and objects included in the Victorian Heritage Register (VHR). General exemptions have been designed to allow everyday activities, maintenance and changes to your property, which don't harm its cultural heritage significance, to proceed without the need to obtain approvals under the Heritage Act 2017.

Places of worship: In some circumstances, you can alter a place of worship to accommodate religious practices without a permit, but you must [notify](#) the Executive Director of Heritage Victoria before you start the works or activities at least 20 business days before the works or activities are to commence.

Subdivision/consolidation: Permit exemptions exist for some subdivisions and consolidations. If the subdivision or consolidation is in accordance with a planning permit granted under Part 4 of the *Planning and Environment Act 1987* and the application for the planning permit was referred to the Executive Director of Heritage Victoria as a determining referral authority, a permit is not required.

Specific exemptions may also apply to your registered place or object. If applicable, these are listed below. Specific exemptions are tailored to the conservation and management needs of an individual registered place or object and set out works and activities that are exempt from the requirements of a permit. Specific exemptions prevail if they conflict with general exemptions.

Find out more about heritage permit exemptions [here](#).

Construction dates 1927,
Heritage Act Categories Registered place,
Hermes Number 684
Property Number

Extent of Registration

AMENDMENT OF REGISTER OF HISTORIC BUILDINGS

Historic Building No. 908, Central Park Conservatory, Central Park, Wattle Tree Road, Malvern.

1. The whole of the building known as the Central Park Conservatory and associated boiler house, marked B-1 and B-2 on Plan 600946S(A), endorsed by the Chairperson, Historic Buildings Council and held by the Director, Historic Buildings Council; and

2. All the land surrounding the Central Park Conservatory to the extent of 30 metres to the north, 40 metres to the west, 13 metres to the south and 15 metres to the east shown on Plan 600946S(B) being part of the land described in the Certificate of Title Volume 3180 Folio 635942 as shown on Plan 600946S(B) endorsed by the Chairperson, Historic Buildings Council and held by the Director, Historic Buildings Council.

[*Victoria Government Gazette* No. G3 22 January 1992 pp.149-150]

This place/object may be included in the Victorian Heritage Register pursuant to the Heritage Act 2017. Check the Victorian Heritage Database, selecting 'Heritage Victoria' as the place source.

For further details about Heritage Overlay places, contact the relevant local council or go to Planning Schemes Online <http://planningschemes.dpcd.vic.gov.au/>