

FORMER PRESBYTERIAN UNION MEMORIAL CHURCH COMPLEX



PRESBYTERIAN UNION
MEMORIAL CHURCH
COMPLEX SOHE 2008



presbyterian church north
melb exterior front



presbyterian church north
melb exterior side



presbyterian union memorial
church north melb church hall
rear sw aug1999



presbyterian union memorial
church north melb manse sw
aug1999



presbyterian union memorial
church north melb parsonage
sw aug1999



presbyterian union memorial
church north melb
queensberry street cottages
sw aug1999



presbyterian union memorial
church north melb south
detail sw aug1999

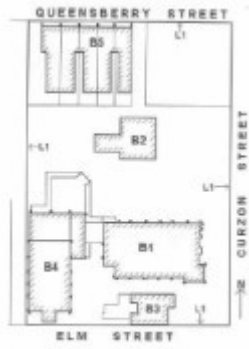

H0007 h0007 plan

Location

49-61 CURZON STREET AND 2-22 ELM STREET AND 579-589 QUEENSBERRY STREET NORTH
MELBOURNE, MELBOURNE CITY

Municipality

MELBOURNE CITY

Level of significance

Registered

Victorian Heritage Register (VHR) Number

H0007

Heritage Overlay Numbers

HO292

VHR Registration

October 9, 1974

Amendment to Registration

November 16, 2023

Heritage Listing

Victorian Heritage Register

Statement of Significance

Last updated on - July 17, 2023

What is significant?

The North Melbourne Presbyterian Church was founded in 1854, the opening services being held on 29 October. On this land an iron school room donated by the denominational schools board was erected in 1855. The United Presbyterian Church of Victoria was formed in 1859 from three separate Presbyterian movements. Shortly after the foundation stone of a new bluestone church was laid and worship moved there from the adjacent iron building in November 1859, when the church was completed. The designer for the church was John Donaldson and it was built by Thomas Cattnach & Co. In 1867 tenders were called for a manse and it was constructed in 1868. During the 1870s the bluestone church was found to be too small and it was resolved to build a new one with a spire. Competitive designs were called and that of architect Evander McIver was chosen from the thirteen submitted. Contractor James Thurgood's tender was accepted and the old church was pulled down to make way for the present building. The new church was completed in 1879. At this time the Church Hall was built behind the church out of the materials from the old church. Half of the original land grant was sold to offset some of the debts of the congregation and cottages were also built on Queensberry Street to provide revenue from their rental. Five cottages remain of eight, which were constructed on the Union Memorial Church site. Four of the cottages were constructed in 1911, designed by Inskip and Kemp and built by Messrs F&W Aberly and a further four were constructed by builders Mather and Lydster to the same design in 1915 and adjoining the earlier cottages. The church is a di-chrome brick building in the Gothic revival style. It has an asymmetrically placed brick tower and stuccoed spire. Internally the church has a gallery supported on cast iron columns with decorative cast iron panel railing. Local craftsmen Ferguson and Urie made the stained glass windows. The church hall is built out of the bluestone and rubble of the old 1859 church. It is also in the Gothic Revival style and has an attached porch and bellcote. Stucco has been applied since its reconstruction. It has large decorative exposed timber trusses on the interior. The manse is a two-storey stuccoed brick residence with a hipped slate roof and corniced chimneys. The parsonage is a polychrome brick, single storey double-fronted cottage in a typical asymmetrical, gabled ecclesiastical mode. Decorative details include fretted bargeboards and a cast iron verandah. The cottages are designed in a low-key Federation Queen Anne style. They are redbrick and originally had four rooms. The front verandahs, which face directly onto the street, have timber fretwork and railing.

How is it significant?

The Union Memorial Church Complex is of historical, social, architectural and aesthetic significance to the State of Victoria.

Why is it significant?

The Union Memorial Church Complex is of historical importance as a rare surviving example of an intact church complex built in the nineteenth and early twentieth century and including, church, manse, hall, parsonage and cottages. With its complex of buildings it is of social importance for its demonstration of the needs and operations of the Presbyterian Church since the 1860s. The construction of cottages on the site clearly demonstrates the practice of church organisations seeking revenue opportunities through property investment. Early examples of this rarely remain part of the original church complex.

The Union Memorial Church building is of architectural importance as it epitomises a substantial Presbyterian church built in the latter half of the nineteenth century with its galleries on three sides. The nature of the meeting-house type of interior used by the Congregationalists, Methodists and Presbyterians can be fully appreciated in

this church. This church is probably architect Evander McIver's best surviving work. The di-chrome brickwork, interior gallery, stairs and stained glass are just four of the notable features. The church hall is of architectural significance for the notable large exposed timber trusses. The spire and imposing exterior of the church along with the intact manse, rear hall, parsonage and cottages results in a complex of aesthetic significance, which is a landmark in North Melbourne.

Permit Exemptions

General Exemptions:

General exemptions apply to all places and objects included in the Victorian Heritage Register (VHR). General exemptions have been designed to allow everyday activities, maintenance and changes to your property, which don't harm its cultural heritage significance, to proceed without the need to obtain approvals under the Heritage Act 2017.

Places of worship: In some circumstances, you can alter a place of worship to accommodate religious practices without a permit, but you must **notify** the Executive Director of Heritage Victoria before you start the works or activities at least 20 business days before the works or activities are to commence.

Subdivision/consolidation: Permit exemptions exist for some subdivisions and consolidations. If the subdivision or consolidation is in accordance with a planning permit granted under Part 4 of the *Planning and Environment Act 1987* and the application for the planning permit was referred to the Executive Director of Heritage Victoria as a determining referral authority, a permit is not required.

Specific exemptions may also apply to your registered place or object. If applicable, these are listed below. Specific exemptions are tailored to the conservation and management needs of an individual registered place or object and set out works and activities that are exempt from the requirements of a permit. Specific exemptions prevail if they conflict with general exemptions.

Find out more about heritage permit exemptions [here](#).

Specific Exemptions:

General Conditions:

1. All exempted alterations are to be planned and carried out in a manner which prevents damage to the fabric of the registered place or object.
2. Should it become apparent during further inspection or the carrying out of alterations that original or previously hidden or inaccessible details of the place or object are revealed which relate to the significance of the place or object, then the exemption covering such alteration shall cease and the Executive Director shall be notified as soon as possible.
3. If there is a conservation policy and plan approved by the Executive Director, all works shall be in accordance with it.
4. Nothing in this declaration prevents the Executive Director from amending or rescinding all or any of the permit exemptions.
5. Nothing in this declaration exempts owners or their agents from the responsibility to seek relevant planning or building permits from the responsible authority where applicable.

Exterior of church, manse, parsonage, hall and cottages

- Minor repairs and maintenance which replace like with like.
- Removal of any extraneous items such as air conditioners, pipe work, ducting, wiring, antennae, aerials etc, and making good.
- Installation or repair of damp-proofing by either injection method or grouted pocket method.
- Regular garden maintenance.

Interior of church, manse, parsonage and hall

- Painting of previously painted walls and ceilings provided that preparation or painting does not remove evidence of the original paint or other decorative scheme.
- Removal of paint from originally unpainted or oiled joinery, doors, architraves, skirtings and decorative strapping.
- Installation, removal or replacement of carpets and/or flexible floor coverings.
- Installation, removal or replacement of curtain track, rods, blinds and other window dressings.
- Installation, removal or replacement of hooks, nails and other devices for the hanging of mirrors, paintings and other wall mounted artworks.
- Refurbishment of bathrooms, toilets including removal, installation or replacement of sanitary fixtures and associated piping, mirrors, wall and floor coverings.
- Installation, removal or replacement of kitchen benches and fixtures including sinks, stoves, ovens, refrigerators, dishwashers etc and associated plumbing and wiring.
- Installation, removal or replacement of ducted, hydronic or concealed radiant type heating provided that the installation does not damage existing skirtings and architraves and provided that the location of the heating unit is concealed from view.
- Installation, removal or replacement of electrical wiring provided that all new wiring is fully concealed and any original light switches, pull cords, push buttons or power outlets are retained in-situ. Note: if wiring original to the place was carried in timber conduits then the conduits should remain in-situ.
- Installation, removal or replacement of bulk insulation in the roof space.

Interior of cottages

- No permit required for interior alterations, which do not affect the exterior or structure of the buildings.

Construction dates	1879,
Architect/Designer	Mclver, Evander,
Heritage Act Categories	Registered place,
Other Names	HOTHAM MISSION, HOTHAM PARISH UNITING CHURCH, ST MARKS CHURCH,
Hermes Number	884
Property Number	

Extent of Registration

Heritage Act 2017

NOTICE OF REGISTRATION

As Executive Director for the purpose of the **Heritage Act 2017**, I give notice under section 53 that the Victorian Heritage Register is amended by modifying a place in the Heritage Register:

Number: H0007

Category: Registered Place

Place: Former Presbyterian Union Memorial Church Complex

Location: 49-61 Curzon Street and 595 Queensberry Street North Melbourne

Municipality: Melbourne City

All the buildings known as B1 Church, B2 Manse, B3 Parsonage, B4 Church Hall, B5 Cottages as marked on Diagram 7.

2. All the land marked L1 on Diagram 7, being all of Lot 1 on Title Plan 891361.

16 November 2023
STEVEN AVERY
Executive Director

This place/object may be included in the Victorian Heritage Register pursuant to the Heritage Act 2017. Check the Victorian Heritage Database, selecting 'Heritage Victoria' as the place source.

For further details about Heritage Overlay places, contact the relevant local council or go to Planning Schemes Online <http://planningschemes.dpcd.vic.gov.au/>