

# YURUNGA



YURUNGA SOHE 2008



YURUNGA SOHE 2008



1 yurunga cust street rainbow  
side verandah oct1981

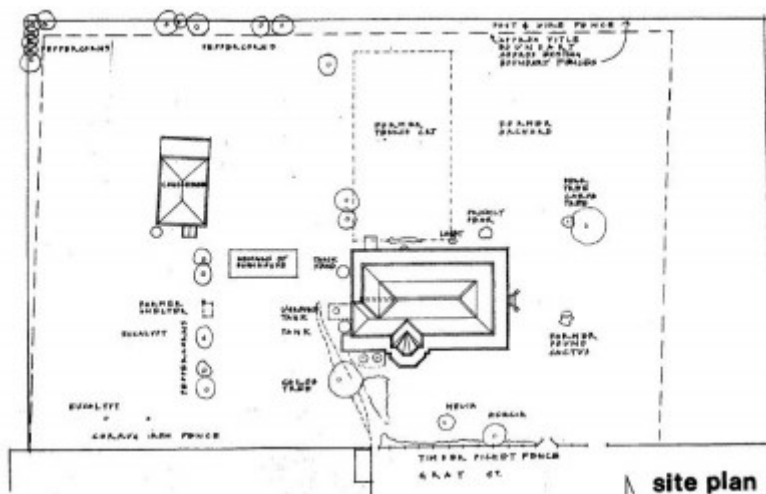

h00598 plan h0598

## Location

1 GRAY STREET RAINBOW, HINDMARSH SHIRE

## Municipality

HINDMARSH SHIRE

## Level of significance

Registered

## Victorian Heritage Register (VHR) Number

H0598

## Heritage Overlay Numbers

HO6

## VHR Registration

August 21, 1985

## Heritage Listing

Victorian Heritage Register

---

## Statement of Significance

Last updated on - June 24, 1999

After its initial period as a sheep farming area, the Mallee deteriorated until it became a wasteland, a breeding ground for rabbits. The lack of confidence in the area was expressed in the vermin-proof fence which extended from Swan Hill (NSW border) to the South Australian border along the 36th parallel, cordoning it off from the remainder of Victoria.

A number of factors led to the Mallee's recovery and Yurunga embodies the brief heyday of this metropolis of the Mallee when Rainbow's population reached its zenith. It was the centre of the Mallee land boom, collector of more wheat than any other area in Victoria (in 1909) and optimism in its expanding future knew no bounds. Yurunga has historical associations with two families who made large contributions to the Mallee's regeneration. The Cust family had connections with western Victoria since the 1840s. As the railways extended into the Mallee, opening up new and revitalising existing towns, the Cust family established a network of general stores in their wake - in Beulah, Brim, Warracknabeal, Hopetoun and of course, Rainbow. The Liesfield brothers on the other hand, were farmers and came from South Australia in the 1880s, pioneers who cleared the mallee scrub with an axe and they are representative of the south Australian migration and the large part these people from over the border played in the Mallee's development. FR Liesfield and his wife occupied Yurunga for over 40 years and were significant figures in the local community.

Architecturally Yurunga is a unique combination of influences. Italianate in form, Federation style in its finishes, adaptive to its context in the innovative inclusion of a sunken room to escape the heat, its plumbing systems and the use of local masonry material which in its construction technique expresses the South Australian influence in the region. The homestead is the most substantial in the district belonging to an age which vanished after the 1914-18 war and it is virtually intact. The interiors are significant examples of Edwardian decoration and the metal ceilings are exceptional in the delicately executed paintwork that highlights the relief patterns. The building is unusual in its use of materials that were relatively new at the time such as the AC roof, art metal ceilings and Art Nouveau glazing and tiles, etc. that if obtainable today, are hardly ever used.

Since the Dimboola Shire purchased Yurunga in 1969 the Rainbow Historical Society has built up an excellent collection of furniture and household items - some lent, some donated, typical of the time and/or Mallee, Wimmera region. The number of visitors to the house each year is testimony to the importance of the building (enhanced by the museum) in this part of Victoria.

## Permit Exemptions

### General Exemptions:

General exemptions apply to all places and objects included in the Victorian Heritage Register (VHR). General exemptions have been designed to allow everyday activities, maintenance and changes to your property, which don't harm its cultural heritage significance, to proceed without the need to obtain approvals under the Heritage

Act 2017.

Places of worship: In some circumstances, you can alter a place of worship to accommodate religious practices without a permit, but you must [notify](#) the Executive Director of Heritage Victoria before you start the works or activities at least 20 business days before the works or activities are to commence.

Subdivision/consolidation: Permit exemptions exist for some subdivisions and consolidations. If the subdivision or consolidation is in accordance with a planning permit granted under Part 4 of the *Planning and Environment Act 1987* and the application for the planning permit was referred to the Executive Director of Heritage Victoria as a determining referral authority, a permit is not required.

Specific exemptions may also apply to your registered place or object. If applicable, these are listed below. Specific exemptions are tailored to the conservation and management needs of an individual registered place or object and set out works and activities that are exempt from the requirements of a permit. Specific exemptions prevail if they conflict with general exemptions.

Find out more about heritage permit exemptions [here](#).

Construction dates	1909,
Heritage Act Categories	Registered place,
Hermes Number	966
Property Number	

---

## Extent of Registration

### AMENDMENT OF REGISTER OF HISTORIC BUILDINGS

Historic Building No. 598, Yurunga, Cust Street, Rainbow (to the extent of all of the buildings and the land entered in the Register Book as Volume 8107 Folio 752).

[*Victoria Government Gazette* No. 86 21 August 1985 p. 3222]

*This place/object may be included in the Victorian Heritage Register pursuant to the Heritage Act 2017. Check the Victorian Heritage Database, selecting 'Heritage Victoria' as the place source.*

*For further details about Heritage Overlay places, contact the relevant local council or go to Planning Schemes Online <http://planningschemes.dpcd.vic.gov.au/>*