

# TINTARA



TINTARA SOHE 2008



1 tintara lyndon street  
ripponlea front entrance  
apr1989



h00842 tintara lyndon street  
ripponlea bay window dining  
room she project 2003



h00842 tintara lyndon street  
ripponlea sunroom she  
project 2003

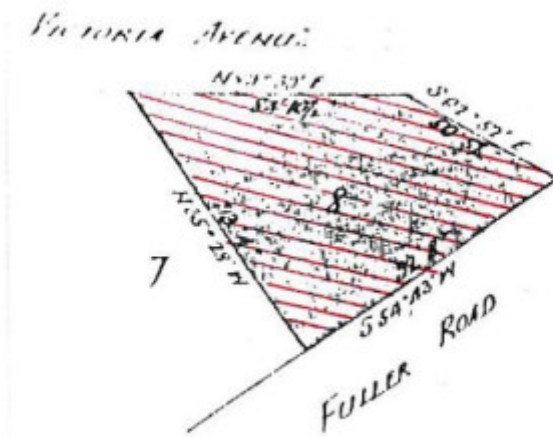

H0842 H0842 plan

## Location

20 LYNDON STREET RIPPONLEA, PORT PHILLIP CITY

## **Municipality**

PORT PHILLIP CITY

## **Level of significance**

Registered

## **Victorian Heritage Register (VHR) Number**

H0842

## **Heritage Overlay Numbers**

HO186

## **VHR Registration**

February 6, 1991

## **Heritage Listing**

Victorian Heritage Register

---

## **Statement of Significance**

Last updated on - July 1, 1999

1. Tintara has continual association with the Keane family dating from its construction in 1923 until the last decade. It also has an association with the Billson family through the building's architect and by marriage with the Keane family.
2. The residence is a rare work by the architectural partnership Billson and Lippincott. Both partners were former employees of Walter Burley Griffin, Billson for 7 years. Lippincott was one of the American architects who joined Griffin in Australia after his success in the Canberra competition.
3. The design of Tintara is attributed to Edward Fielder Billson, one of Griffin's most talented disciples. Billson is now recognised as a very important Victorian modern architect and was a recipient of the RVIA street architecture medal in 1940 for the Sanitarium Health Food building, Warburton.
4. Tintara is a rare example of a local interpretation of the American Prairie School brought to Australia by Griffin and his associates. In the treatment of the large bargeboards and the rendered sills and lintels, Tintara has a horizontal emphasis in keeping with the work of Frank Lloyd Wright. The dominant roof form adds a Melbourne flavour to the composition.
5. In its heavy articulation, Tintara retains a protective feel inspired by Griffin's early domestic work in the United States. Features, such as encompassing roof, paired brickwork piers, infill panels and the use of the crystal motif in glazing are derived from Griffin's work. The Tintara design is a particularly successful architectural resolution of Griffin's elements.
6. Tintara is an essentially intact example of a small group of Melbourne houses utilising a distinctive vocabulary. It is very different from other 1920s housing in Melbourne and also separate from the majority of buildings done

by Griffin's followers which relate more to his later Australian work.

## Permit Exemptions

### General Exemptions:

General exemptions apply to all places and objects included in the Victorian Heritage Register (VHR). General exemptions have been designed to allow everyday activities, maintenance and changes to your property, which don't harm its cultural heritage significance, to proceed without the need to obtain approvals under the Heritage Act 2017.

Places of worship: In some circumstances, you can alter a place of worship to accommodate religious practices without a permit, but you must [notify](#) the Executive Director of Heritage Victoria before you start the works or activities at least 20 business days before the works or activities are to commence.

Subdivision/consolidation: Permit exemptions exist for some subdivisions and consolidations. If the subdivision or consolidation is in accordance with a planning permit granted under Part 4 of the *Planning and Environment Act 1987* and the application for the planning permit was referred to the Executive Director of Heritage Victoria as a determining referral authority, a permit is not required.

Specific exemptions may also apply to your registered place or object. If applicable, these are listed below. Specific exemptions are tailored to the conservation and management needs of an individual registered place or object and set out works and activities that are exempt from the requirements of a permit. Specific exemptions prevail if they conflict with general exemptions.

Find out more about heritage permit exemptions [here](#).

Construction dates	1923,
Architect/Designer	Billson, Edward F,
Heritage Act Categories	Registered place,
Hermes Number	989
Property Number	

---

## History

Associated People: Assoc.People KEANE

## Extent of Registration

AMENDMENT OF REGISTER OF HISTORIC BUILDINGS

Historic Building No. 842-

Tintara, 20 Lyndon Street, Ripponlea.

(The buildings and the whole of the land entered in the Register Book Certificate of Title Volume 4671 Folio 181 as shown hatched on the plan endorsed by the Chairperson, Historic Buildings Council and held by the Director, Historic Buildings Council.)

[*Victoria Government Gazette* No. G5 6 February 1991 p.248]

*This place/object may be included in the Victorian Heritage Register pursuant to the Heritage Act 2017. Check the Victorian Heritage Database, selecting 'Heritage Victoria' as the place source.*

*For further details about Heritage Overlay places, contact the relevant local council or go to Planning Schemes Online <http://planningschemes.dpcd.vic.gov.au/>*