

Deep Lead Ballast Line, north of Deep Lead Sandbar Road, DEEP LEAD

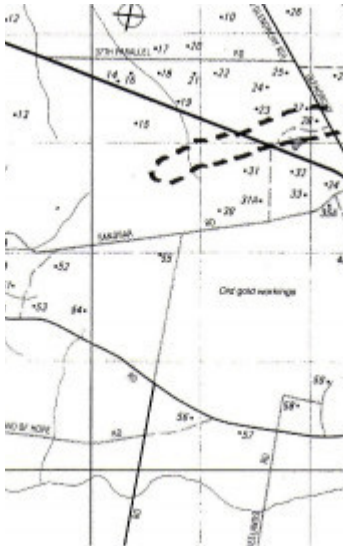

DL 03 - Shire of Northern
Grampians - Stage 2 Heritage
Study, 2004

Location

Deep Lead Sandbar Road DEEP LEAD, NORTHERN GRAMPIANS SHIRE

Municipality

NORTHERN GRAMPIANS SHIRE

Level of significance

Recommended for Heritage Overlay

Heritage Listing

Northern Grampians Shire

Statement of Significance

Last updated on - July 30, 2004

The Deep Lead Ballast Line consists of a line of raised and formed earth which is still evident across paddocks and in historic reserves.

The Deep Lead Ballast Line is **historically** and **scientifically** important at a **LOCAL** level as an example of an industry which used a by product of gold mining technique to assist the emerging network of railways. Overall the Deep Lead Ballast Line is of **LOCAL** significance.

RECOMMENDED LEVEL OF SIGNIFICANCE: LOCAL

Heritage Study/Consultant	Northern Grampians - Shire of Northern Grampians - Stage 2 Heritage Study, Wendy Jacobs, Vicki Johnson, David Rowe, Phil Taylor, 2004;
Hermes Number	104836
Property Number	

Physical Description 1

Remnants of the former ballast line, which runs from Deep Lead railway station to the Hand in Hand mine. The bed of the spur line can be seen emerging from the north end of the tailings dump of the Band of Hope Mine with traces visible where it passed across the paddocks to the Western Highway. Here it crossed behind the site of the Junction Hotel at the junction of the Western Highway and the Warracknabeal Roads. The spur line emerges from the Warracknabeal Road just south of a narrow bridge at Canadian Gully. It then crosses the paddock to join the main railway line just south of the 250 Km post.

This place/object may be included in the Victorian Heritage Register pursuant to the Heritage Act 2017. Check the Victorian Heritage Database, selecting 'Heritage Victoria' as the place source.

For further details about Heritage Overlay places, contact the relevant local council or go to Planning Schemes Online <http://planningschemes.dpcd.vic.gov.au/>