

Shop and Office 60 and 62 Grant St (McDonalds Saddlery, Busi Fingers Ceramics Studio, Fisher & Box Pty. Ltd. Accountants)

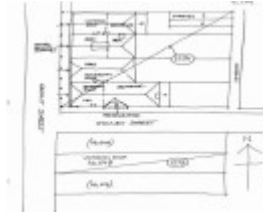

McDonalds Saddlery, Busi Fingers Ceramics Studio, Fisher & Box Pty. Ltd. Accountants



McDonalds Saddlery, Busi Fingers Ceramics Studio, Fisher & Box Pty. Ltd. Accountants

Location

60-62 Grant Street BACCHUS MARSH, MOORABOOL SHIRE

Municipality

MOORABOOL SHIRE

Level of significance

Included in Heritage Overlay

Heritage Overlay Numbers

HO81

Heritage Listing

Moorabool Shire

Statement of Significance

Last updated on - December 19, 1993

A row of four brick late Victorian and Edwardian shops in two pairs, built over the period 1890-1911 and operated during 1890-1955 as a general store for Maddingley.

It has historical significance to Bacchus Marsh for its association with developments in community life, as a retail business. It has architectural significance locally also, as an example of a building type of its period. Finally, it has local social significance within living memory as a traditional community focus, meeting place and information exchange for Maddingley.

Heritage Study/Consultant	Moorabool - Bacchus Marsh Heritage Study 1995, Richard Peterson and Daniel Catrice, 1995;
Other Names	John Jory; William Morton; William & Alexander Gulline.,
Hermes Number	117073
Property Number	

Physical Conditions

Reasonable

Intactness

All shopfront windows have been replaced except no. 62. Brickwork has almost all been painted.

SIGNIFICANT INTACT ELEMENTS:

FORM. FACADE. VERANDAH. ROOF FORM. USE. PARAPET DECORATION. CHIMNEYS. DOORS. WINDOWS. OUTBUILDINGS.

Physical Description 1

A row of four brick shops in two pairs: No. 60 Victorian (shop, 1890 and residence behind 1891) and No. 62 Edwardian (62A shop, 1899 and 62B shop and residence 1911). They have hip roofs behind parapet fronts. There is a continuous old timber verandah extending over the footpath to the kerb. Chimneys are bichromatic brick. No. 60 has a former residential section at the rear, with chimney and verandah. No. 62 has a residential side entrance to Sydney Street, this is canted and recessed with a projecting minor gable roof on brackets, with a finial and a catenary curved valance rail. There are two triple casement sashes with highlights and the wall is roughcast over a dado board. There is also a small opening. No. 60(a) has a large outbuilding (stables?) accessible from a rear lane off Sydney Street and No. 60(b) has a roof lantern vent.

Historical Australian Themes

Townships/Community Life

Usage/Former Usage

USE: Shops and office.

PREVIOUS USE: General Store.

This place/object may be included in the Victorian Heritage Register pursuant to the Heritage Act 2017. Check the Victorian Heritage Database, selecting 'Heritage Victoria' as the place source.

For further details about Heritage Overlay places, contact the relevant local council or go to Planning Schemes Online <http://planningschemes.dpcd.vic.gov.au/>