

DRESSING PAVILION



DRESSING PAVILION SOHE
2008



DRESSING PAVILION SOHE
2008



1 dressing pavillion the
esplanade williamstown rear
view from beach



H0927 DRESSING
PAVILION LHA 2015 1.JPG



H0927 DRESSING
PAVILION LHA 2015 2.JPG



H0927 DRESSING
PAVILION LHA 2015 3.JPG



H0927 DRESSING
PAVILION LHA 2015 4.JPG

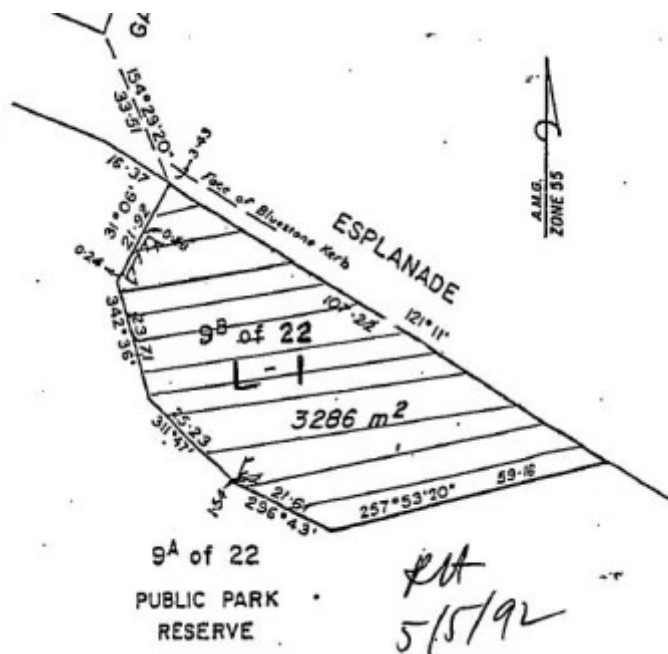

h00927 plan h0927

Location

26 ESPLANADE WILLIAMSTOWN, HOBSONS BAY CITY

Municipality

HOBSONS BAY CITY

Level of significance

Registered

Victorian Heritage Register (VHR) Number

H0927

Heritage Overlay Numbers

HO106

VHR Registration

June 10, 1992

Heritage Listing

Victorian Heritage Register

Statement of Significance

Last updated on - January 28, 2000

The Williamstown Dressing Pavilion, constructed in 1936, is architecturally significant at the state level as an extraordinarily strong dynamic and early example of European Modernism applied to the design of a pavilion structure by two then relatively unknown architects Arnold Bridge and Alan Bogle. The design wields influences emerging as a new design ethic from Europe brought back to Melbourne by young architects who translated steel, concrete and glass into a new building style. The Williamstown Dressing Pavilion is an overtly Modernist building with a design lineage reaching back to the Stijl Movement based in Holland. The Williamstown Dressing Pavilion is architecturally significant as a structure which brought a large number of people in contact with architectural modernism.

Permit Exemptions

General Exemptions:

General exemptions apply to all places and objects included in the Victorian Heritage Register (VHR). General exemptions have been designed to allow everyday activities, maintenance and changes to your property, which don't harm its cultural heritage significance, to proceed without the need to obtain approvals under the Heritage Act 2017.

Places of worship: In some circumstances, you can alter a place of worship to accommodate religious practices without a permit, but you must [notify](#) the Executive Director of Heritage Victoria before you start the works or activities at least 20 business days before the works or activities are to commence.

Subdivision/consolidation: Permit exemptions exist for some subdivisions and consolidations. If the subdivision or consolidation is in accordance with a planning permit granted under Part 4 of the *Planning and Environment Act 1987* and the application for the planning permit was referred to the Executive Director of Heritage Victoria as a determining referral authority, a permit is not required.

Specific exemptions may also apply to your registered place or object. If applicable, these are listed below. Specific exemptions are tailored to the conservation and management needs of an individual registered place or object and set out works and activities that are exempt from the requirements of a permit. Specific exemptions prevail if they conflict with general exemptions.

Find out more about heritage permit exemptions [here](#).

Construction dates	1936,
Architect/Designer	Bridge, Arnold, Bogle, Alan,
Heritage Act Categories	Registered place,
Hermes Number	1229
Property Number	

Extent of Registration

AMENDMENT OF REGISTER OF HISTORIC BUILDINGS

Historic Building No. 927-

Williamstown Dressing Pavilion, The Esplanade, Williamstown.

To the extent of:

1. All the buildings known as the Williamstown Dressing Pavilion marked B-1 on Plan 862127K(A) endorsed by the Chairperson, Historic Buildings Council and held by the Director, Historic Buildings Council; and
2. All the land described as 9B of 22 (excision from public park reserve) on Map CP108352 Department of Property and Services, County of Bourke, Parish of Cut Paw Paw, Township of Williamstown and marked L-1 on Plan 862127K(A), endorsed by the Chairperson, Historic Buildings Council and held by the Director, Historic Buildings Council.

[*Victoria Government Gazette* No. G22 10 June 1992 p.1459]

This place/object may be included in the Victorian Heritage Register pursuant to the Heritage Act 2017. Check the Victorian Heritage Database, selecting 'Heritage Victoria' as the place source.

For further details about Heritage Overlay places, contact the relevant local council or go to Planning Schemes Online <http://planningschemes.dpcd.vic.gov.au/>