

---

## Dwelling, 69 Lerderderg Street, Bacchus Marsh

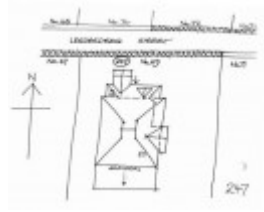

House, 69 Lerderderg Street,  
Bacchus Marsh



House, 69 Lerderderg Street,  
Bacchus Marsh

---

### Location

69 Lerderderg Street BACCHUS MARSH, MOORABOOL SHIRE

### Municipality

MOORABOOL SHIRE

### Level of significance

Included in Heritage Overlay

### Heritage Overlay Numbers

HO93

### Heritage Listing

Moorabool Shire

---

### Statement of Significance

Last updated on - July 10, 2015

What is significant?

The Residence and its setting at 69 Lerderderg Street, Bacchus Marsh.

How is it significant?

The Residence and its setting at 69 Lerderderg Street, Bacchus Marsh is of local historical and architectural significance to the Shire of Moorabool.

Why is it significant?

The Residence and its setting at 69 Lerderderg Street, Bacchus Marsh is of local historical significance for its demonstration of the prosperous period in the history of Bacchus Marsh stimulated by farming, industry and closer settlement. Constructed in 1913, the property would have been one of the first developed following the subdivision of the Lerderderg Street area by W. H. McFarlane. The picturesque residence is of historical significance for demonstrating why Lerderderg Street became known as the 'Toorak of Bacchus Marsh'.

The Residence and its setting at 69 Lerderderg Street, Bacchus Marsh is of aesthetic significance as an architect designed transitional Victorian and Edwardian residence. The building demonstrates key features of the Edwardian period, including the complex dominant roof form with combined hips and gables, corner return verandah with timber fretwork valance and curved timber brackets to the posts, projecting bays with decorated gable ends, tripartite bay windows and diagonal floor planning.

Heritage Study/Consultant	Moorabool - Bacchus Marsh Heritage Study 1995, Richard Peterson and Daniel Catrice, 1995;
Hermes Number	124285
Property Number	

---

## Physical Description 1

A triple-fronted, tuckpointed red brick, Edwardian house. It has a major gambrel roof from which the right-hand front bay and the left side rear bay project as gables. A verandah returns around the corner to these. The roof extends break pitch at front as a hip. Over this is a decorative gablet. The upper gables jetty deeply on brackets, with unusual timbering flush with the barges, with a diamond pattern. Beneath is a canted bay, its upper section roughcast and with double casements. The verandah has a wavy rail valance and large decorative fretwork brackets. At the corner is a rectangular bay on the diagonal. There is an Edwardian entry door with leadlight, sidelights, fanlight and a rare flyscreen door.

## Historical Australian Themes

Townships.

## Intactness

Good. It appears to have all been clad with bagged mortar and coloured, perhaps with Colortex. The fence and garden are recent. The verandah floor has been replaced with a concrete slab.

SIGNIFICANT INTACT ELEMENTS:

FORM. FACADE. VERANDAH. ROOF FORM.

ROOF DECORATION. VERANDAH DECORATION.

CHIMNEYS. WALL DECORATION. DOORS. WINDOWS. PAINTWORK SCHEME.

*This place/object may be included in the Victorian Heritage Register pursuant to the Heritage Act 2017. Check the Victorian Heritage Database, selecting 'Heritage Victoria' as the place source.*

*For further details about Heritage Overlay places, contact the relevant local council or go to Planning Schemes Online <http://planningschemes.dpcd.vic.gov.au/>*