

Darnlee Residence

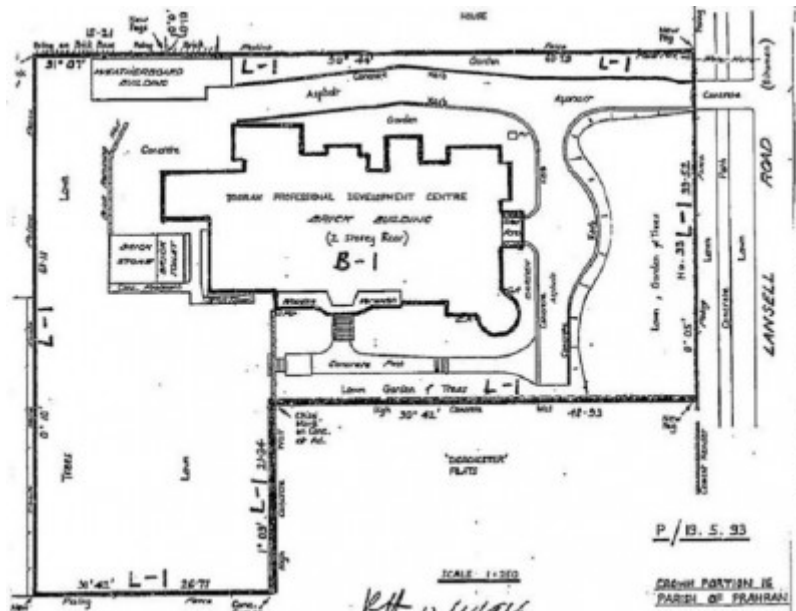

DARNLEE SOHE 2008

1 darnlee lansell road toorak
front view

h01024 plan h1024

Location

33 LANSELL ROAD TOORAK, Stonnington City

Municipality

STONNINGTON CITY

Level of significance

-

Victorian Heritage Register (VHR) Number

H1024

Heritage Overlay Numbers

HO69

Heritage Listing

Vic. War Heritage Inventory

Statement of Significance

Last updated on - August 10, 1999

What is significant?

Darnlee, constructed c. 1899 by builder J. Gibb, was designed by architect Leonard J. Flannagan for Mr C. McIntyre. It was a private residence until the Second World War when it was used as a hostel for the WAAF. Subsequently Darnlee has been occupied by the Health Department, serving as a tuberculosis rehabilitation centre, and the Department of Education, and was converted into an aged care facility in the late 1990s. Darnlee is a finely detailed and essentially intact example of a Federation Queen Anne style residence. It is particularly noteworthy for its numerous gables and elaborately carved bargeboards, its ornamental terracotta finials, and its corner tower with a steeply pitched conical roof. Of particular note is the use and execution of timber decorative and structural elements; the front gable is decoratively carved and heavy turned timber columns support the timber framing of the entrance porch. The entrance also retains its original leadlighting around the front door and the encaustic tile pavement. Much of the internal elaborate plaster ceilings and cornices, fireplaces and surrounds, panelled timber doors with distinctive architraves and stained glass panels are intact.

How is it significant?

Darnlee is of architectural and historical significance to the State of Victoria.

Why is it significant?

Darnlee is of architectural significance as one of the best and most intact examples of Melbourne's Federation Style architecture. The Federation Queen Anne style was the dominant style in Australian domestic architecture immediately before and after 1900, reflecting the influence of the revival of Queen Anne architecture in England from 1870. Darnlee is a particularly finely detailed and essentially intact example of the genre.

Darnlee is of architectural significance as an important example of the work of the notable architect Leonard Flannagan (1864-1946?), whose designs included many dwellings, several churches and convents and works for the Prahran and Malvern Tramways Trust.

Darnlee is of historical significance because it provides evidence of the way of life of prominent families of early 20th century Melbourne. A number of influential Victorian families owned the property, including the McIntyre family, the Winter-Irving family, the Riggall family and Sarah McKay, widow of HV McKay, the inventor of the Sunshine Harvester and important early Australian industrialist.

Construction dates 1899,

Architect/Designer Flannagan, Leonard,

Heritage Act Categories Registered place,

Hermes Number 125268

Property Number

Physical Description 1

Date Started c1899; ; Storeys 0; Desc INDIVIDUAL BUILDING OR GROUP; Walls BRICK;
Additions c.1917, also by Flannagan

Usage/Former Usage

1895-1943; residence

1943-45; used by Red Cross (1949-53 Tuberculosis rehabilitation centre?)

1951-56; Red Cross

1956-1968; Commonwealth property- Occupational Therapy School

1969-93; Commonwealth Education Department - Professional Development Centr

Veterans Description for Public

The Darnlee Residence, at 33 Lansell Road Toorak, was constructed c. 1899 by builder J. Gibb and designed by architect Leonard J. Flannagan for Mr C. McIntyre. It was a private residence until the Second World War when it was used as a hostel for the WAAF. From 1943-45 it was used by the Red Cross. Subsequently Darnlee has been occupied by the Health Department, serving as a tuberculosis rehabilitation centre, and the Department of Education, and was converted into an aged care facility in the late 1990s.

Darnlee is a finely detailed and essentially intact example of a Federation Queen Anne style residence. It is particularly noteworthy for its numerous gables and elaborately carved bargeboards, its ornamental terracotta finials, and its corner tower with a steeply pitched conical roof.

Extent of Registration

1. All the building known as Darnlee, excluding the brick store and toilet building and the weatherboard building, marked B1 on Plan No. 604683 and endorsed by the Chairperson, HBC./n/n

2. All the land in Lot 2 on Plan of Subdivision No. 20276, Parish of Prahran being part of Crown Portion 16 marked L1 on Plan No. 604683 and endorsed by the Chairperson, HBC and held by the Director, HBC.

This place/object may be included in the Victorian Heritage Register pursuant to the Heritage Act 2017. Check the Victorian Heritage Database, selecting 'Heritage Victoria' as the place source.

For further details about Heritage Overlay places, contact the relevant local council or go to Planning Schemes Online <http://planningschemes.dpcd.vic.gov.au/>