

ST PATRICKS CATHEDRAL AND HALL



ST PATRICKS CATHEDRAL AND HALL SOHE 2008



ST PATRICKS CATHEDRAL AND HALL SOHE 2008



ST PATRICKS CATHEDRAL AND HALL SOHE 2008



ST PATRICKS CATHEDRAL AND HALL SOHE 2008



ST PATRICKS CATHEDRAL AND HALL SOHE 2008



ST PATRICKS CATHEDRAL AND HALL SOHE 2008



1 st patrick's cathedral ballarat exterior view of cathedral



St Patricks Ballarat cadastral layout.JPG

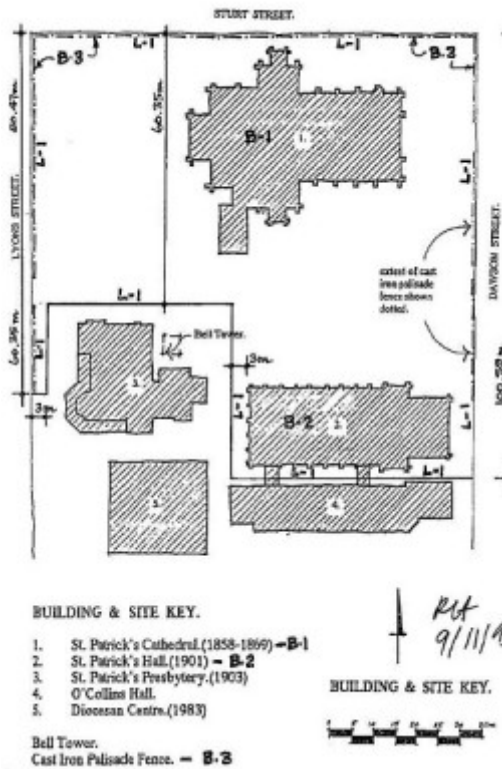

h00997 plan h0997

Location

501 STURT STREET BALLARAT CENTRAL, BALLARAT CITY

Municipality

BALLARAT CITY

Level of significance

Registered

Victorian Heritage Register (VHR) Number

H0997

Heritage Overlay Numbers

HO107

VHR Registration

March 3, 1994

Heritage Listing

Statement of Significance

Last updated on - May 31, 1999

St Patrick's Cathedral, Ballarat built between 1857 and 1871, was based on a design of English architect Charles Hansom, modified by local architects Dowden and Ross and later by JB Denny who designed the eastern section. Reed, Tappin and Smart designed the decorations for the interior in 1891.

Ballarat architects Clegg, Kell and Miller designed St Patrick's Hall which was built by Peter Bodger in 1901.

St Patrick's Cathedral and Hall form an important ecclesiastical pair demonstrating the particular strength of the Catholic Church in Ballarat.

St Patrick's Cathedral, built in bluestone and comprising a five bay nave with aisles and clerestory, porches, transepts, side chapels, chancel and sacristies, demonstrates outstanding craftsmanship particularly in the stencilled patterning on the boarded chancel ceiling, the stone carvings by Andrea Stombucco and the excellent examples of stained glass by Clayton and Bell of London, Mayer & Co of Munich and Hardman & Co of Birmingham.

The cathedral is significant for its association with the important English architect Charles Francis Hansom (1817-1888) who played a prominent role in the Gothic revival of the 1840s in England. A number of his church designs were built in Victoria, sometimes modified by local architects, including St Patrick's Church, Port Fairy and St Augustine's Church, Creswick. St Patrick's Cathedral is Hansom's largest cathedral design in Australia, apart from the Adelaide Cathedral which has been substantially altered.

St Patrick's Cathedral is also significant for its association with the leader of the English Gothic revival movement, Augustus Welby Pugin, through JB Denny. Denny, who had worked with Pugin in England, was responsible for the final form of the cathedral.

The participation of the local community in financing a church of such an impressive scale demonstrates the importance placed in the church as a symbol of the faith and identity of the Catholic community in Ballarat.

The cast iron gates and fence around the perimeter of the complex, designed in an elaborate gothic style with crowned piers demonstrate outstanding craftsmanship.

St Patrick's Hall demonstrates a notable application of decorative schemes, particularly its highly decorated ceiling which has few parallels amongst other church halls in Victoria.

Permit Exemptions

General Exemptions:

General exemptions apply to all places and objects included in the Victorian Heritage Register (VHR). General exemptions have been designed to allow everyday activities, maintenance and changes to your property, which don't harm its cultural heritage significance, to proceed without the need to obtain approvals under the Heritage Act 2017.

Places of worship: In some circumstances, you can alter a place of worship to accommodate religious practices without a permit, but you must [notify](#) the Executive Director of Heritage Victoria before you start the works or activities at least 20 business days before the works or activities are to commence.

Subdivision/consolidation: Permit exemptions exist for some subdivisions and consolidations. If the subdivision or consolidation is in accordance with a planning permit granted under Part 4 of the *Planning and Environment Act*

1987 and the application for the planning permit was referred to the Executive Director of Heritage Victoria as a determining referral authority, a permit is not required.

Specific exemptions may also apply to your registered place or object. If applicable, these are listed below. Specific exemptions are tailored to the conservation and management needs of an individual registered place or object and set out works and activities that are exempt from the requirements of a permit. Specific exemptions prevail if they conflict with general exemptions.

Find out more about heritage permit exemptions [here](#).

Construction dates	1857,
Architect/Designer	Manson, Charles,
Heritage Act Categories	Registered place,
Hermes Number	1399
Property Number	

History

Associated People: Owner ROMAN CATHOLIC TRUSTS CORPORATION OF BALLARAT;

Extent of Registration

AMENDMENT OF REGISTER OF HISTORIC BUILDINGS

Historic Building No. 997.

St Patrick's Cathedral and St Patrick's Hall, Sturt and Dawson Streets, Ballarat.

(To the extent of:

1. All of the buildings known as St Patrick's Cathedral (B-1), St Patrick's Hall (B-2) and the fence and gates from the driveway in Lyons Street up to Sturt Street, the complete frontage to Sturt Street and the Dawson Street frontage to the north side of St Patrick's Hall (B-3) shown on Plan 600228 endorsed by the Chairperson, Historic Buildings Council and held by the Director, Historic Buildings Council.
2. All of the land in Certificate of Title Volume 9225 Folio 082, part of the land in Certificate of Title Volume 9225 Folio 083, all of the land in Certificate of Title Volume 177 Folio 265 and part of the land in Certificate of Title Volume 2390 Folio 974 marked L-1 on Plan 600228 endorsed by the Chairperson, Historic Buildings Council and held by the Director, Historic Buildings Council.

[*Victoria Government Gazette* No. G9 3 March 1994 p.578]

This place/object may be included in the Victorian Heritage Register pursuant to the Heritage Act 2017. Check the Victorian Heritage Database, selecting 'Heritage Victoria' as the place source.

For further details about Heritage Overlay places, contact the relevant local council or go to Planning Schemes Online <http://planningschemes.dpcd.vic.gov.au/>