

---

# House

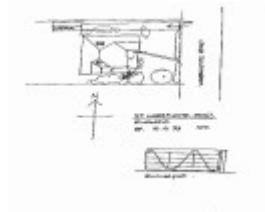

House at 49 Warrandyte Rd



House at 49 Warrandyte Rd

---

## Location

49 Warrandyte Road RINGWOOD, MAROONDAH CITY

## Municipality

MAROONDAH CITY

## Level of significance

Included in Heritage Overlay

## Heritage Overlay Numbers

HO128

## Heritage Listing

Maroondah City

---

## Statement of Significance

Last updated on -

A characteristic timber Edwardian house built in the 1920s. It is historically significant in embodying the family life in Ringwood before the Great depression and architecturally as a characteristic intact example of this domestic style, with some contextual elements, including a rare vehicular gate.

Heritage Study/Consultant	Maroondah - Maroondah Heritage Study, Richard Peterson Architect & Conservation Consultant, 2010;
Hermes Number	146878
Property Number	

---

## Physical Description 1

A characteristic triple-fronted timber Edwardian house with a high hipped-roof. The left-side rear and right front bays project as gables. Upper gables jetty on fretwork brackets, timbered roughcast, with triple windows with toplights. The verandah is under the hip which extends at break-pitch and returns around the

angle. It has a palisaded valance with fretwork panels with an Art Nouveau incised tulip motif. It has turned posts and concave fretwork brackets. There is a rare Edwardian flyscreen door. There is a canted gablet at the canted angle, giving a diagonal axis to the entry beneath. There is a mature garden with remnant period elements including a front boundary hedge and a palm. The front fence is chicken-wire and red gum posts. There is a rare surviving rural vehicular N-profile gate, with five horizontal wire stands and two verticals, bolted connections to cast-iron bosses.

## Intactness

Excellent.

## Physical Conditions

A characteristic timber Edwardian house built in the 1920s. It is historically significant in embodying the family life in Ringwood before the Great depression and architecturally as a characteristic intact example of this domestic style, with some contextual elements, including a rare vehicular gate.

*This place/object may be included in the Victorian Heritage Register pursuant to the Heritage Act 2017. Check the Victorian Heritage Database, selecting 'Heritage Victoria' as the place source.*

*For further details about Heritage Overlay places, contact the relevant local council or go to Planning Schemes Online <http://planningschemes.dpcd.vic.gov.au/>*