

# COTTAGE



COTTAGE SOHE 2008



COTTAGE SOHE 2008



1 cottage barkly street  
brunswick front view oct1984

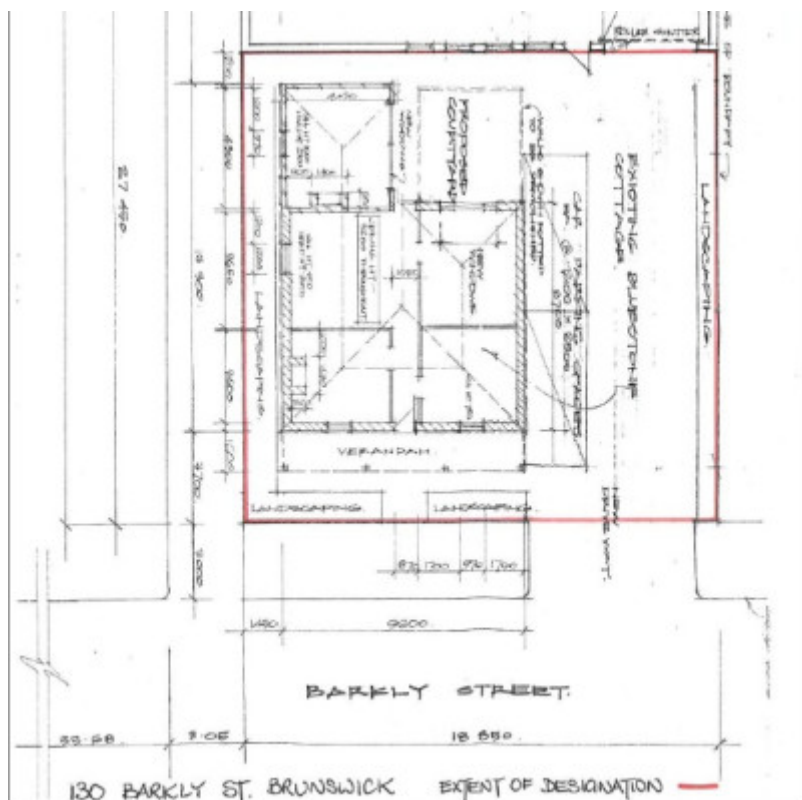

H0594 H0594 plan

## Location

130 BARKLY STREET BRUNSWICK, MORELAND CITY

## Municipality

MERRI-BEK CITY

## Level of significance

Registered

## Victorian Heritage Register (VHR) Number

H0594

## Heritage Overlay Numbers

HO17

## VHR Registration

January 9, 1985

## Heritage Listing

Victorian Heritage Register

---

## Statement of Significance

Last updated on - June 24, 1999

The single-storey bluestone cottage at 130 Barkly Street, Brunswick, is significant as an early example of a working man's cottage in an area distinguished by its association with Melbourne's building trades. The cottage is believed to have been constructed sometime in the late 1850s by a quarryman of the area, Matthew Birkett.

With its shallow bluestone deposits and rich clay beds along the nearby Moonee Ponds Creek, Brunswick became the city's main source of building stone and bricks in the nineteenth century, but located on the city's perimeter, and poorly served by transport facilities until it was not until the boom decade of the 1880s that Brunswick became part of metropolis proper. Brunswick's rapid growth in the 1880s reflected the intense activity in the district's building trades at this time.

The cottage at 130 Barkly St is therefore a rare and tangible legacy of pre-land boom Brunswick, and important for its association with quarrying. The brick addition and building material reflects the style of the later period.

## Permit Exemptions

### General Exemptions:

General exemptions apply to all places and objects included in the Victorian Heritage Register (VHR). General exemptions have been designed to allow everyday activities, maintenance and changes to your property, which don't harm its cultural heritage significance, to proceed without the need to obtain approvals under the Heritage Act 2017.

**Places of worship:** In some circumstances, you can alter a place of worship to accommodate religious practices without a permit, but you must [notify](#) the Executive Director of Heritage Victoria before you start the works or activities at least 20 business days before the works or activities are to commence.

**Subdivision/consolidation:** Permit exemptions exist for some subdivisions and consolidations. If the subdivision or consolidation is in accordance with a planning permit granted under Part 4 of the *Planning and Environment Act 1987* and the application for the planning permit was referred to the Executive Director of Heritage Victoria as a

determining referral authority, a permit is not required.

Specific exemptions may also apply to your registered place or object. If applicable, these are listed below. Specific exemptions are tailored to the conservation and management needs of an individual registered place or object and set out works and activities that are exempt from the requirements of a permit. Specific exemptions prevail if they conflict with general exemptions.

Find out more about heritage permit exemptions [here](#).

Construction dates	1850,
Heritage Act Categories	Registered place,
Hermes Number	167
Property Number	

---

## Plaque Citation

Built in the late 1850s by a local quarryman, Matthew Birkett, this is a rare remnant of early Brunswick and an unusual example of an early working man's home. Brunswick was then a major source of Melbourne's building stone.

## Extent of Registration

### AMENDMENT OF REGISTER OF HISTORIC BUILDINGS

Historic Building No. 594 130 Barkly Street, Brunswick (to the extent of the whole of the bluestone and brick cottage and land entered in the Register Book as Volume 2868 Folio 451 and as described in the map held by the Ministry for Planning and Environment).

[*Victoria Government Gazette* No. 2 9 January 1985 p. 37]

*This place/object may be included in the Victorian Heritage Register pursuant to the Heritage Act 2017. Check the Victorian Heritage Database, selecting 'Heritage Victoria' as the place source.*

*For further details about Heritage Overlay places, contact the relevant local council or go to Planning Schemes Online <http://planningschemes.dpcd.vic.gov.au/>*