

## FORMER CURATOR'S COTTAGE



FORMER CURATOR'S  
COTTAGE SOHE 2008



FORMER CURATOR'S  
COTTAGE SOHE 2008



1 former curator's cottage  
queens park moonee ponds  
front view oct1994

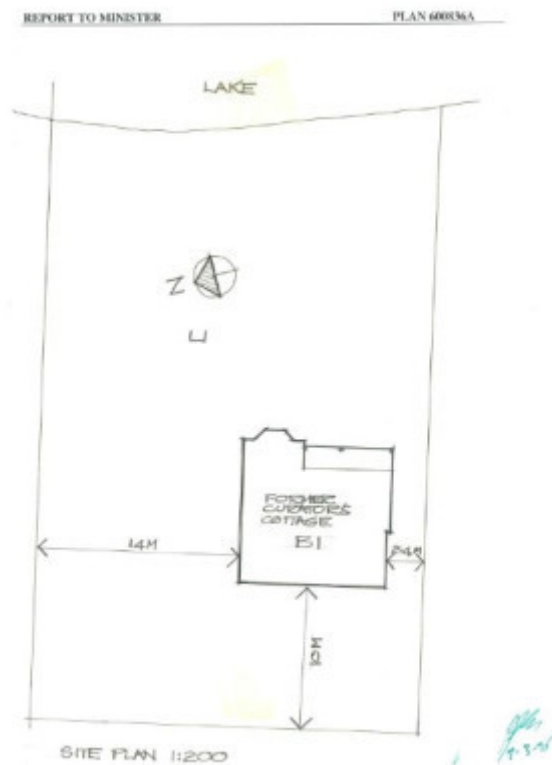

H1078 extent

### Location

776 MOUNT ALEXANDER ROAD AND 10 THE STRAND, MOONEE PONDS, MOONEE VALLEY CITY

### Municipality

## Level of significance

Registered

## Victorian Heritage Register (VHR) Number

H1078

## Heritage Overlay Numbers

HO69

## VHR Registration

April 20, 1995

## Heritage Listing

Victorian Heritage Register

---

## Statement of Significance

Last updated on - February 7, 2023

### What is significant?

The area now known as Queen's Park was once the site of a natural watering-hole, surrounded by red gums. It was reserved for ornamental plantation in 1884, but it was not until the 1890s that plans were drawn up for the creation of a park by the local council and John Oliver, the first curator.

A fund was set up to beautify the lake in celebration of the Queen's Jubilee. The plans for the Swiss cottage had been approved by the Essendon Council in 1891 and it was constructed between then and 1898. The timber building was designed as a house for the curator and continued to be used as the residence for the superintendent of gardens until 1990.

### How is it significant?

The former curator's cottage is of architectural, historic and aesthetic significance to Victoria.

### Why is it significant?

The cottage has artistic associations with the Picturesque landscape movement of the early nineteenth century Britain, demonstrated by the use of the Victorian Rustic Gothic style in a landscaped setting next to the ornamental lake in Queen's Park. As possibly the only example of a timber Victorian Rustic Gothic curator's cottage and the only known example with a shingled roof and dormers, the building is a relatively rare and extraordinary example of a curator's cottage in a large public garden.

The building demonstrates outstanding craftsmanship and decoration in the use of shingles to the roof, scalloped shingles to the walls, decorative criss-cross timber valance, timber finials and tied pendants, including smaller finials to the three dormers.

It represents the important functions played by the curator in public gardens. The curator was involved not only in the development and management of the gardens, but also their protection and security. The cottage, located in a prominent and central position near the lake and once adjacent to the now demolished conservatory, reflects the roles of the curator.

The cottage demonstrates an association with John Oliver, the first curator at Queen's Park, who was appointed in 1891 and who retired in 1938. John Oliver also worked at Ballarat Botanical Gardens and the Chirnside's estate at Werribee and advised on the designs for the gardens at Duntroon Military College and for other municipalities.

## Permit Exemptions

### General Exemptions:

General exemptions apply to all places and objects included in the Victorian Heritage Register (VHR). General exemptions have been designed to allow everyday activities, maintenance and changes to your property, which don't harm its cultural heritage significance, to proceed without the need to obtain approvals under the Heritage Act 2017.

**Places of worship:** In some circumstances, you can alter a place of worship to accommodate religious practices without a permit, but you must **notify** the Executive Director of Heritage Victoria before you start the works or activities at least 20 business days before the works or activities are to commence.

**Subdivision/consolidation:** Permit exemptions exist for some subdivisions and consolidations. If the subdivision or consolidation is in accordance with a planning permit granted under Part 4 of the *Planning and Environment Act 1987* and the application for the planning permit was referred to the Executive Director of Heritage Victoria as a determining referral authority, a permit is not required.

Specific exemptions may also apply to your registered place or object. If applicable, these are listed below. Specific exemptions are tailored to the conservation and management needs of an individual registered place or object and set out works and activities that are exempt from the requirements of a permit. Specific exemptions prevail if they conflict with general exemptions.

Find out more about heritage permit exemptions [here](#).

Construction dates	1896,
Heritage Act Categories	Registered place,
Hermes Number	1762
Property Number	

---

## Extent of Registration

### AMENDMENT OF REGISTER OF HISTORIC BUILDINGS

Historic Building No. 1078.

Former Curator's Cottage, Queen's Park, Mt Alexander Road, Moonee Ponds, City of Moonee Valley.

(To the extent of:

1. All of the building known as the former curator's cottage, excluding the later additions and outsheds, marked B-1 on Plan 600836A endorsed by the Chair, Historic Buildings Council and held by the Director, Historic Buildings Council.
2. All of the land marked L1 on Plan 600836B being part of Crown Reserve No.1009 endorsed by the Chair, Historic Buildings Council and held by the Director, Historic Buildings Council.)

[*Victoria Government Gazette* No. G15 20 April 1995 p.932]

*This place/object may be included in the Victorian Heritage Register pursuant to the Heritage Act 2017. Check the Victorian Heritage Database, selecting 'Heritage Victoria' as the place source.*

For further details about Heritage Overlay places, contact the relevant local council or go to Planning Schemes Online <http://planningschemes.dpcd.vic.gov.au/>