

# Victorian Heritage Database Report

Report generated 03/04/20



1 glenara glenara road bulla front view  
dec1983



glenara glenara road bulla courtyard  
dec1983



glenara glenara road bulla drawing room  
bay exterior dec1983



glenara glenara road bulla garden  
terrace dec1983

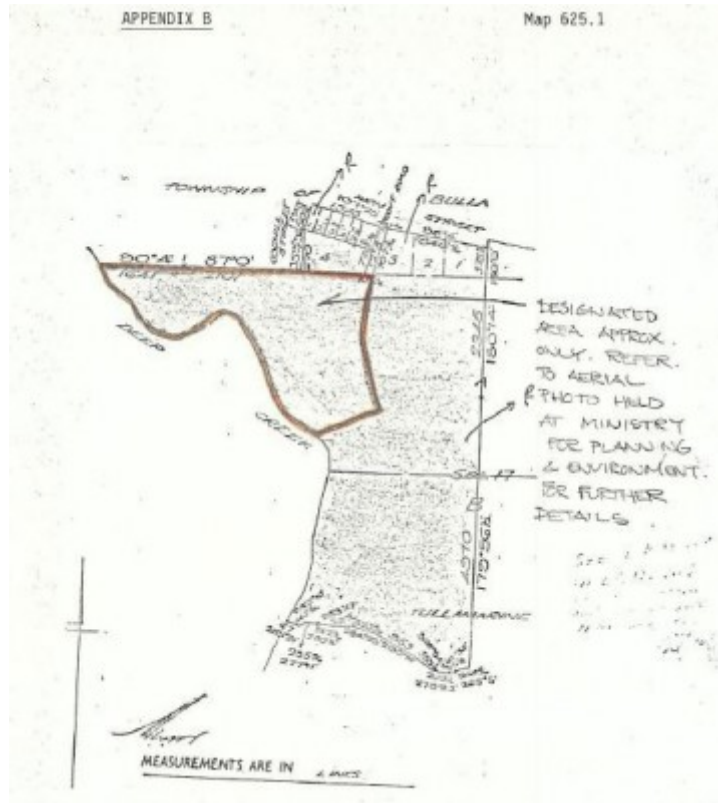

H0625 Image001

---

### Location

10 GLENARA DRIVE BULLA, HUME CITY

### Municipality

HUME CITY

### Level of significance

Registered

### Victorian Heritage Register (VHR) Number

H0625

### Heritage Overlay Numbers

HO11

## VHR Registration

October 1, 1986

## Heritage Listing

Victorian Heritage Register

---

## Statement of Significance

Last updated on - May 16, 2007

### What is significant?

Glenara, Bulla was settled by pastoralist Walter Clark in 1857. Originally purchasing 485 acres to the north-west of Melbourne, Clark built his estate up to 4079 acres before his death in 1873. In 1887 the homestead block of about 830 acres was purchased by his son, Alister Clark, one of Australia's best known horticulturalists and rosarians, and the garden became the site for the breeding of many plant species for more than sixty years. At his death in 1949 the estate covered 1035 acres.

Walter Clark arrived in Sydney from Scotland in 1837, and lived in the Riverina region of N.S.W. before purchasing a dramatic site on Deep Creek, near Melbourne, in 1857. He immediately planted vineyards on this new property, Glenara, and tenders were called by architects Purchas and Swyer for the construction of a house. Walter Clark's interest in gardening saw the architects also supervising the design of the landscape surrounding the house. Early garden features included a terrace to the west of the homestead with stone steps and urns and a sundial. Extensive paths were constructed to the south of the house and pathways were formed amongst, and steps cut into, rocky outcrops.

The dramatic siting, on a high promontory above large, rocky outcrops along Deep Creek, and early plantings and landscape features, were recorded in a photograph by Nettleton in c 1864 and in a painting by Eugene von Guerard in 1867. By 1868 Glenara's picturesque beauty was described as unsurpassed in Australia in the *Guide for Excursionists from Melbourne*.

In 1872 architect Evander McIver called tenders for the erection of a bluestone tower at Glenara, which was constructed on a hill to the south of the homestead. A rustic bridge leading to this tower was also constructed.

Walter Clark died in 1873 and his son Alister, born in 1864, finally purchased the homestead block at Glenara in 1887. He settled there permanently in 1892. A series of managers and lessees had been responsible for the property, however the house and the form of the garden had been retained. A billiard room was added to the eastern end of the homestead in 1895 and Alister began to assemble an extensive range of plants in the garden. His greatest interest was the breeding of roses and daffodils and he introduced many species to the garden at Glenara before his death in 1949.

The Glenara homestead is a large single storey Italianate house of rendered stone and brick, with hipped slate roofs and eaves supported on paired brackets. An encircling verandah has open work timber posts and lintels. The west end features an Italianate terrace with classical balustrade and urns, flanked by staircases at either side leading to an elaborate path system. Double doors, which lead to this terrace from the polygonal bay of the drawing room, are framed by heavy cornices supported on large consoles. The 1895 billiard room, which is designed to match the earlier building, contains a large glass skylight with transfer design, timber dado and coved ceiling, stained glass windows and polygonal bay with French doors and stained glass toplights.

The property contains a number of early buildings, including an octagonal, timber building, evident in von Guerard's painting, and a gatekeeper's lodge and winery of rendered brick and coursed rubble bluestone, possibly c1870s.

### How is it significant?

Glenara, Bulla is of historical, architectural and aesthetic significance to the State of Victoria.

### Why is it significant?

Glenara, Bulla is of historical significance for its long associations with the Clark family and the pastoral industry. It is of particular historical significance for its associations with Alister Clark, one of Australia's best known horticulturalists and rosarians.

Glenara, Bulla is of architectural significance as a representative example of a substantially intact 1850s Italianate homestead. The surviving outbuildings on the property, including the pre-1867 octagonal building, the gatekeeper's house and the winery are also of architectural significance.

Glenara, Bulla is of aesthetic significance for its rare picturesque qualities which result from the relationship between the homestead, garden and dramatic landscape setting. The retention of indigenous trees and exposed rocks contribute to this quality. The early recording of the property, by Eugene von Guerard in 1857-8, is also of note.

Glenara, Bulla is of aesthetic significance as one of the earliest surviving domestic gardens in Victoria. It conforms to its original pattern and retains an elaborate path system, Italianate terrace, sundial, gates, bridge and bluestone tower from the nineteenth century. The latter is of particular significance as a rare, true garden folly in Victoria. The garden retains trees and plantings from the mid-nineteenth to early twentieth century.

Glenara, Bulla is of scientific (horticultural) as the site of Alister Clark's extensive plant breeding programmes in the early twentieth century. The garden retains a large number of his plants, including daffodils and mature specimens of many roses.

[Online Data Upgrade Project 2007]

## Permit Exemptions

General Conditions: 1. All exempted alterations are to be planned and carried out in a manner which prevents damage to the fabric of the registered place or object. General Conditions: 2. Should it become apparent during further inspection or the carrying out of works that original or previously hidden or inaccessible details of the place or object are revealed which relate to the significance of the place or object, then the exemption covering such works shall cease and Heritage Victoria shall be notified as soon as possible. Note: All archaeological places have the potential to contain significant sub-surface artefacts and other remains. In most cases it will be necessary to obtain approval from the Executive Director, Heritage Victoria before the undertaking any works that have a significant sub-surface component.

General Conditions: 3. If there is a conservation policy and plan all works shall be in accordance with it. Note: A Conservation Management Plan or a Heritage Action Plan provides guidance for the management of the heritage values associated with the site. It may not be necessary to obtain a heritage permit for certain works specified in the management plan.

General Conditions: 4. Nothing in this determination prevents the Executive Director from amending or rescinding all or any of the permit exemptions. General Conditions: 5. Nothing in this determination exempts owners or their agents from the responsibility to seek relevant planning or building permits from the responsible authorities where applicable. Minor Works : Note: Any Minor Works that in the opinion of the Executive Director will not adversely affect the heritage significance of the place may be exempt from the permit requirements of the Heritage Act. A person proposing to undertake minor works must submit a proposal to the Executive Director. If the Executive Director is satisfied that the proposed works will not adversely affect the heritage values of the site, the applicant may be exempted from the requirement to obtain a heritage permit. If an applicant is uncertain whether a heritage permit is required, it is recommended that the permits co-ordinator be contacted.

Construction dates	1857, 1872,
Architect/Designer	Purchas & Sawyer, Mclver, Evander,
Heritage Act Categories	Registered place,
Hermes Number	177

## History

Glenara, Bulla was settled by pastoralist Walter Clark in 1857. Originally purchasing 485 acres to the north-west of Melbourne, Clark built his estate up to 4079 acres before his death in 1873. In 1887 the homestead block of about 830 acres was purchased by his son, Alister Clark, one of Australia's best known horticulturalists and rosarians, and the garden became the site for the breeding of many plant species for more than sixty years. At his death in 1949 the estate covered 1035 acres.

Walter Clark arrived in Sydney from Scotland in 1837, and lived in the Riverina region of N.S.W. before purchasing a dramatic site on Deep Creek, near Melbourne, in 1857. He immediately planted vineyards on this new property, Glenara, and tenders were called by architects Purchas and Swyer for the construction of a house. Walter Clark's interest in gardening saw the architects also supervising the design of the landscape surrounding the house. Early garden features included a terrace to the west of the homestead with stone steps and urns and a sundial. Extensive paths were constructed to the south of the house and pathways were formed amongst, and steps cut into, rocky outcrops.

The dramatic siting, on a high promontory above large, rocky outcrops along Deep Creek, and early plantings and landscape features, were recorded in a photograph by Nettleton in c 1864 and in a painting by Eugene von Guerard in 1867. By 1868 Glenara's picturesque beauty was described as unsurpassed in Australia in the *Guide for Excursionists from Melbourne*.

In 1872 architect Evander McIver called tenders for the erection of a bluestone tower at Glenara, which was constructed on a hill to the south of the homestead. A rustic bridge leading to this tower was also constructed.

Walter Clark died in 1873 and his son Alister, born in 1864, finally purchased the homestead block at Glenara in 1887. He settled there permanently in 1892. A series of managers and lessees had been responsible for the property, however the house and the form of the garden had been retained. A billiard room was added to the eastern end of the homestead in 1895 and Alister began to assemble an extensive range of plants in the garden. His greatest interest was the breeding of roses and daffodils and he introduced many species to the garden at Glenara before his death in 1949.

### **The draft statement of significance and the above history were produced as part of an Online Data Upgrade Project 2007. Sources were as follows:**

J. Patrick Pty Ltd in association with Allom Lovell & Assoc Pty Ltd. *Glenara, Bulla. Vol 1 Conservation Study and Management Plan*. 1996

D Moloney & V Johnson. *City of Hume: Heritage Study of the Former Shire of Bulla District*. 1998

C. Kellaway. *Research into Glenara Homestead*, 1985. (in Heritage Victoria file)

T. R. Garnett. *Man of Roses. Alister Clark of Glenara and His Family*. 1990

## Extent of Registration

### AMENDMENT OF REGISTER OF HISTORIC BUILDINGS

Historic Building No. 625 - 'Glenara', Glenara Drive, Bulla (to the extent of all buildings (excluding the stables c.1960) and land entered in the Register Book as Volume 8448 Folio 139, to the extent of the area shown outlined in red on Plan No. 625.1 held by the Ministry for Planning and Environment).

[*Victoria Government Gazette* No. 80 1 October 1986 p. 3789]

*This place/object may be included in the Victorian Heritage Register pursuant to the Heritage Act 2017. Check the Victorian Heritage Database, selecting 'Heritage Victoria' as the place data owner.*

*For further details about Heritage Overlay places, contact the relevant local council or go to Planning Schemes Online <http://planningschemes.dpcd.vic.gov.au/>*