

# NOBLE STREET UNITING CHURCH, HALL AND KINDERGARTEN



NOBLE STREET UNITING CHURCH,  
HALL AND KINDERGARTEN SOHE  
2008



NOBLE STREET UNITING CHURCH,  
HALL AND KINDERGARTEN SOHE  
2008



NOBLE STREET UNITING CHURCH,  
HALL AND KINDERGARTEN SOHE  
2008



1 noble street uniting church hall &  
kindergarten noble street newtown  
kindergarten

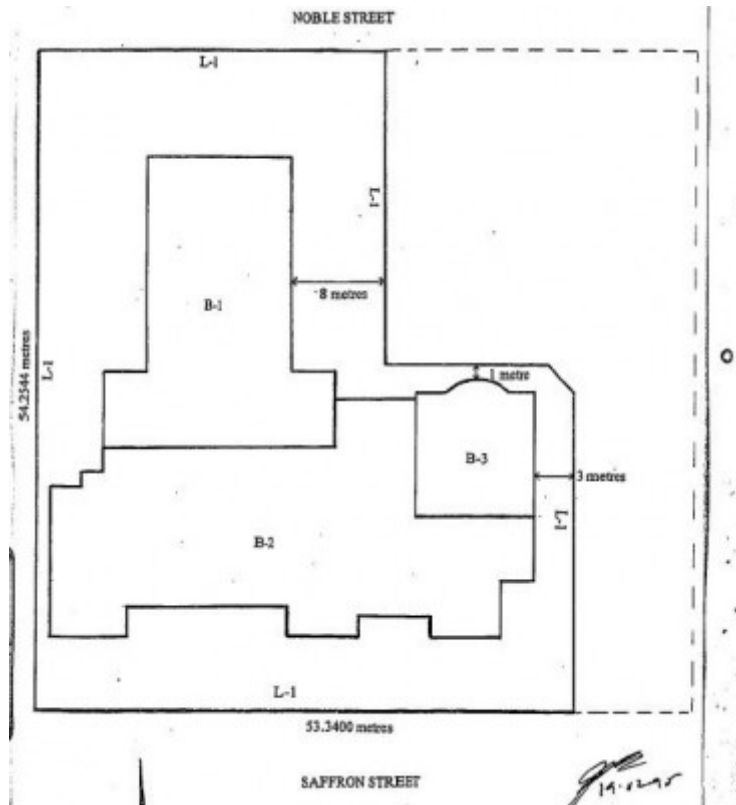

h01158 plan h1158

**Location**

35 NOBLE STREET NEWTOWN, GREATER GEELONG CITY

**Municipality**

GREATER GEELONG CITY

**Level of significance**

Registered

**Victorian Heritage Register (VHR) Number**

H1158

**Heritage Overlay Numbers**

HO198

**VHR Registration**

April 18, 1996

**Heritage Listing**

## Statement of Significance

Last updated on - May 6, 1999

The Noble Street Uniting Church, Newtown was built in 1854 by Pile and Brimblecombe to replace an earlier structure. The church, built of bluestone in a purportedly Norman style but exhibiting the proportions of a classical temple, was extended in 1876 by the addition of transepts. The Fincham pipe organ and choir gallery were also added at this time. The Gothic style single storey Sunday School/hall was built in 1890 and the kindergarten in 1915.

The Noble Street Uniting Church is of historical and architectural significance to Victoria.

The Noble Street Uniting Church is important for its historical associations with the Wesleyan Methodist Church in Victoria. Amongst the earliest of the churches built by the Wesleyan Church in the state, it demonstrates the simple and more classicising nature of Wesleyan architecture during the period prior to their acceptance of the Gothic style with the construction of the Wesley Church, Lonsdale Street, Melbourne in 1857.

The church is significant as an extraordinary example of an architectural style. Despite its classical temple form, typical of early nonconformist churches, the building also incorporates elements derived from Romanesque architecture, including a wheel window. The hall is an extraordinarily late example of the Picturesque Gothic style complete with pseudo Georgian glazing bars. The sequence of styles exhibited by the complex exemplifies the changing attitudes to architectural expression by the Wesleyan Church in the nineteenth century. The classical/Romanesque expression demonstrates the earlier nonconformist aversion to the "papist" associations of the Gothic.

This contrasts markedly with the (by then) extremely old fashioned Gothic expression of the 1890 Sunday School/hall.

|                         |                   |
|-------------------------|-------------------|
| Construction dates      | 1854,             |
| Heritage Act Categories | Registered place, |
| Hermes Number           | 2014              |
| Property Number         |                   |

---

## Extent of Registration

## AMENDMENT OF REGISTER OF HISTORIC BUILDINGS

Historic Building No. 1158:

Noble Street, Uniting Church, Hall and Kindergarten, 31 Noble Street, Newtown, City of Greater Geelong.

Extent:

To the extent of:

1. All of the buildings known as the Noble Street Uniting Church (B-1), Hall (B-2) and Kindergarten (B-3) shown on Plan 601131 endorsed by the Chairperson, Historic Buildings Council and held by the Director, Historic Buildings Council.

2. All of the land marked L-1 on Plan 601131 being all of the land described in Memorial No. 774 Book 167, Memorial No. 678 Book 8, Memorial No. 907 Book 113, Memorial No. 778 Book 167, Memorial No. 684 Book 2 and part of the land described in Memorial No. 747 Book 142 endorsed by the Chairperson, Historic Buildings Council and held by the Director, Historic Buildings Council.

[*Victoria Government Gazette* No. G15 18 April 1996 p.955]

*This place/object may be included in the Victorian Heritage Register pursuant to the Heritage Act 2017. Check the Victorian Heritage Database, selecting 'Heritage Victoria' as the place source.*

*For further details about Heritage Overlay places, contact the relevant local council or go to Planning Schemes Online <http://planningschemes.dpcd.vic.gov.au/>*