

Police Stables & Lock Up (former)



Smythesdale Stables



Smythesdale Lock Up



Former Police Lock Up & Stables



23730 Lock up and Police Station Smythesdale



November 2003. Source: Lorraine Huddle Pty Ltd.



November 2003. Source: Lorraine Huddle Pty Ltd.



November 2003. Source: Lorraine Huddle Pty Ltd.



November 2003. Source: Lorraine Huddle Pty Ltd.

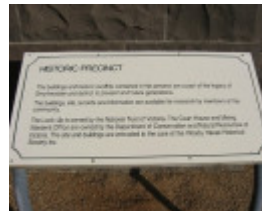

November 2003. Source: Lorraine Huddle Pty Ltd.

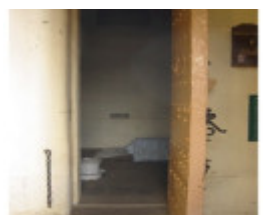

November 2003. Source: Lorraine Huddle Pty Ltd.



November 2003. Source: Lorraine Huddle Pty Ltd.



November 2003. Source: Lorraine Huddle Pty Ltd.



November 2003. Source:
Lorraine Huddle Pty Ltd.



Former Police Lock Up
& Stables



Former Police Lock Up
& Stables



Former Police Lock Up



Former Police Stables

Location

62 Brooke Street SMYTHESDALE, GOLDEN PLAINS SHIRE

Municipality

GOLDEN PLAINS SHIRE

Level of significance

Included in Heritage Overlay

Heritage Overlay Numbers

HO68

HO104

Heritage Listing

Golden Plains Shire

Statement of Significance

Last updated on -

What is Significant?

The former police stables and lock up, 62 Brooke Street, Smythesdale, has significance as rare and predominantly intact surviving examples of a 19th century police infrastructure buildings in the Golden Plains Shire. These buildings, along with the neighbouring court house, represent the only surviving structures of a

considerable police complex on the former police reserve from 1859. The stables building was erected at this time and the lock up was built in 1866 at the height of the gold rush in Smythesdale. Both buildings are of standard Public Works Department design, in their gabled roof forms clad in slate, rendered brick wall construction (stables) and bluestone construction (lock up) and associated details. The interiors of the buildings are also predominantly intact. Of particular interest in the stables is the brick floor having the bricks set with their lengths into the ground, as well as the timber screen and cement rendered wall finishes. The interior of the lock up symbolises contemporary 19th century attitudes towards confinement and punishment, in the austere flagstone and timber floors, white washed walls, timber-lined ceilings, and especially in the solid timber doors (with substantial iron bolts and hinges) and openings with iron security grilles.

How is it Significant?

The former police stables and lock up at Smythesdale are architecturally, historically and socially significant at the state level. The stables represent the only example of its type in the Golden Plains Shire, and the only known surviving rendered brick police stables by the Public Works Department in Victoria. The lock up is only one of two surviving 19th century bluestone gaols in the municipality today.

Why is it Significant?

The former police stables and lock up at Smythesdale are historically significant (Practice Note Criteria A & B) for their associations with the evolution and development of law and order (and particularly a police presence) in Smythesdale from the height of the gold boom in the town from the 1850s and 1860s. Alongside the neighbouring court house, they served their original purpose until 1959. The buildings symbolise the 19th century police presence in the town, with the lock up servicing prisoners awaiting trial at the neighbouring court house.

The former police stables and lock up at Smythesdale are architecturally significant (Practice Note Criteria D & E) as predominantly intact and rare surviving examples of standard Public Works Department austere designs of the 1850s and 1860s in the Golden Plains Shire. While the buildings have experienced repairs, they reflect their original designs and construction. The former stables building is the only example of its type in the Shire, and the only known surviving rendered brick example in Victoria. The lock up is only one of two lock ups surviving in the Shire (the other example being at Bannockburn).

The former police stables and lock up at Smythesdale are socially significant (Practice Note Criterion G) as symbols of 19th century law and order in the town. While no longer functioning for their original purpose, they are recognised and valued as tangible links to the town's public infrastructure heritage of the booming gold rush years.

Heritage Study/Consultant	Golden Plains - Golden Plains Shire Heritage Assessments, D. Rowe, 2012; Golden Plains - Golden Plains Shire Heritage Study Phase 1, Lorraine Huddle P/L, 2003;
Hermes Number	23730
Property Number	

This place/object may be included in the Victorian Heritage Register pursuant to the Heritage Act 2017. Check the Victorian Heritage Database, selecting 'Heritage Victoria' as the place source.

For further details about Heritage Overlay places, contact the relevant local council or go to Planning Schemes Online <http://planningschemes.dpcd.vic.gov.au/>