

# TERRACE



TERRACE SOHE 2008



1 terrace 408 albert street  
east melbourne front view  
nov1990



terrace 408 albert street east  
melbourne front entrance  
nov1990

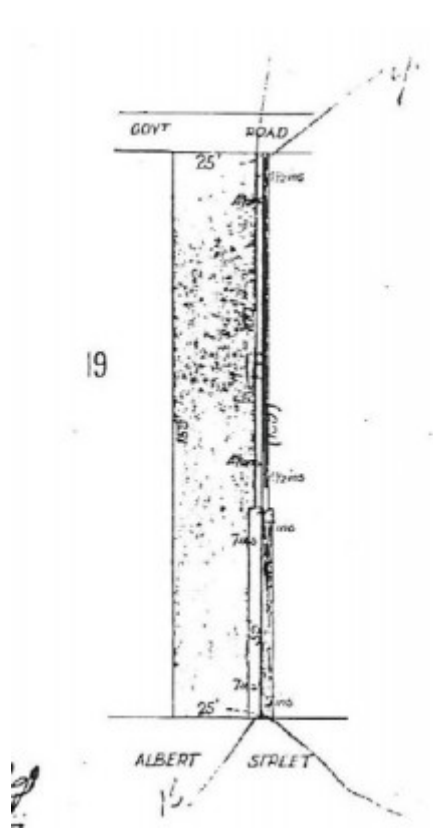

H0851 h0851 plan

## Location

408 ALBERT STREET EAST MELBOURNE, MELBOURNE CITY

## Municipality

MELBOURNE CITY

## Level of significance

Registered

## Victorian Heritage Register (VHR) Number

H0851

## Heritage Overlay Numbers

HO121

## VHR Registration

November 13, 1991

## Heritage Listing

Victorian Heritage Register

---

## Statement of Significance

Last updated on - January 19, 2000

What is significant?

The terrace house at 408 Albert Street was constructed as one of a pair of houses in 1868 to the design of Charles Webb. 408 Albert Street is a three storey brick house with a two storey composite construction timber and cast iron verandah. The facade is divided into three bays. On the ground floor there is strong horizontal banded rustication and the main entrance is set against the party wall. The three windows on the second storey have prominent projecting sills supported by pairs of brackets. The cornice projects across 406 and 408 Albert Street and is also supported by brackets. Above the level of the verandah recessed quoins delineate 408 Albert Street from its neighbouring house at 406 Albert Street. The two storey verandah is divided into three bays of timber arches set on timber posts with Corinthian capitals. The first floor arches are depressed. The friezes, spandrels and balustrades are of decorative cast iron. A cast iron palisade fence with decorative gate posts divides the small front garden from the street.

How is it significant?

The terrace at 408 Albert Street is of architectural and historical significance to the State of Victoria.

Why is it significant?

The terrace at 408 Albert Street is architecturally significant as an early and intact three storey terrace by noted architect Charles Webb. Webb was a prolific architect of terrace houses in the 1870s and 1880s. 408 Albert Street is significant for the intact composite timber and cast iron construction verandah. The timber columns with Corinthian capitals and the cast iron balustrade panels and friezes are particularly notable. The facade articulation on the second floor and the decoration of the verandah piers are important and anticipate the later so-called boom style architecture in Melbourne.

The terrace at 408 Albert Street is historically significant for its associations with influential members of the Jewish community who played a prominent role in the development of the Eastern Hill precinct.

## Permit Exemptions

## General Exemptions:

General exemptions apply to all places and objects included in the Victorian Heritage Register (VHR). General exemptions have been designed to allow everyday activities, maintenance and changes to your property, which don't harm its cultural heritage significance, to proceed without the need to obtain approvals under the Heritage Act 2017.

**Places of worship:** In some circumstances, you can alter a place of worship to accommodate religious practices without a permit, but you must **notify** the Executive Director of Heritage Victoria before you start the works or activities at least 20 business days before the works or activities are to commence.

**Subdivision/consolidation:** Permit exemptions exist for some subdivisions and consolidations. If the subdivision or consolidation is in accordance with a planning permit granted under Part 4 of the *Planning and Environment Act 1987* and the application for the planning permit was referred to the Executive Director of Heritage Victoria as a determining referral authority, a permit is not required.

Specific exemptions may also apply to your registered place or object. If applicable, these are listed below. Specific exemptions are tailored to the conservation and management needs of an individual registered place or object and set out works and activities that are exempt from the requirements of a permit. Specific exemptions prevail if they conflict with general exemptions.

Find out more about heritage permit exemptions [here](#).

Construction dates	1868,
Architect/Designer	Webb, Charles,
Heritage Act Categories	Registered place,
Hermes Number	350
Property Number	

---

## History

History of Place:

The first rate book entry for Jacob Harris' pair of three-storeyed brick houses at 406-408 Albert Street is in 1869 when he is listed as owner of two houses each of 12 rooms with outhouses. By 1871 Harris still owns both buildings and his business partner Julius Matthews is listed as occupier of 408 Albert Street. In 1874 Matthews is shown as owner-occupier. Harris and Matthews are listed in the 1874 Melbourne Directory as boot and shoe importers and manufacturers of 18 Elizabeth Street.

(File notes drawn from National Trust file no.3592, October 1978)

The two storey verandah was originally continuous to 406 and 408 Albert Street.

## Extent of Registration

AMENDMENT OF REGISTER OF HISTORIC BUILDINGS

Historic Building No. 851.

408 Albert Street, East Melbourne.

(The whole of the building and land entered in the Register Book Certificate of Title Volume 5818 Folio 410, shown in the plan endorsed by the Chairperson, Historic Buildings Council and held by the Director, Historic Buildings Council.)

[*Victoria Government Gazette* No. G44 13 November 1991 p.3117]

*This place/object may be included in the Victorian Heritage Register pursuant to the Heritage Act 2017. Check the Victorian Heritage Database, selecting 'Heritage Victoria' as the place source.*

*For further details about Heritage Overlay places, contact the relevant local council or go to Planning Schemes Online <http://planningschemes.dpcd.vic.gov.au/>*