

## FORMER MURRAY HOTEL



FORMER MURRAY HOTEL  
SOHE 2008



1 former murray hotel echuca  
streetscape 1998



H1071 FORMER MURRAY  
HOTEL LHA 2015 1.JPG



H1071 FORMER MURRAY  
HOTEL LHA 2015 2.JPG



H1071 FORMER MURRAY  
HOTEL LHA 2015 3.JPG



H1071 FORMER MURRAY  
HOTEL LHA 2015 4.JPG



H1071 FORMER MURRAY  
HOTEL LHA 2015 5.JPG



H1071 FORMER MURRAY  
HOTEL LHA 2015 6.JPG

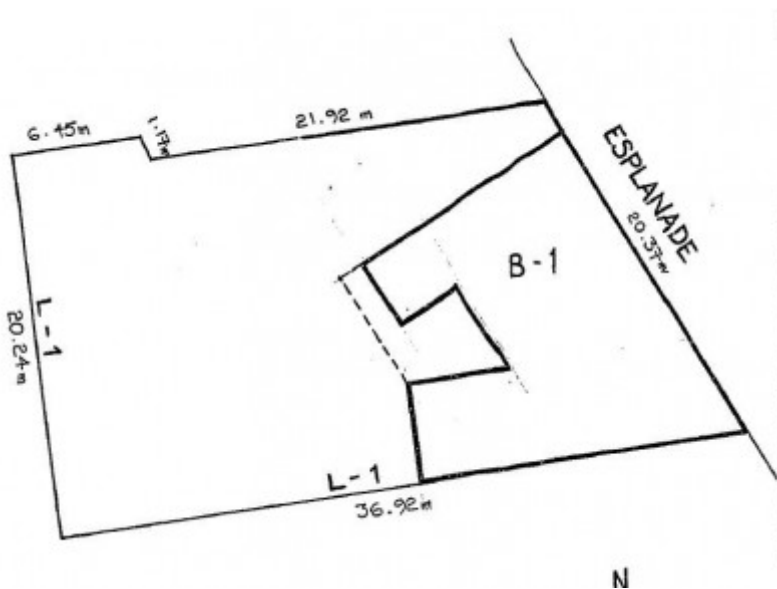

h01071 plan h1071

---

### Location

9-11 MURRAY ESPLANADE ECHUCA, CAMPASPE SHIRE

### Municipality

CAMPASPE SHIRE

### Level of significance

Registered

### Victorian Heritage Register (VHR) Number

H1071

### Heritage Overlay Numbers

HO32

### VHR Registration

February 23, 1995

### Heritage Listing

Victorian Heritage Register

---

### Statement of Significance

Last updated on - May 5, 1999

The former Murray Hotel, built in 1879 by publican William Lawson to replace an earlier timber structure, is a small two storey building of red brick construction with unpainted stuccoed plinth, pilasters, string course and cornice. It was delicensed around 1906.

The building has historic and architectural significance to the state of Victoria.

The former Murray Hotel is important for its association with the early social life of Echuca and as a rare intact example of a modest hotel. The utilitarian style of the building reflects its role of offering accommodation and refreshment to the passing river traffic during the period when Echuca was Victoria's principal inland port. The building has little embellishment, the predominant features being the round arched openings at street level and slightly segmentally arched upper level windows. The original small bar room of the Murray Hotel and the other small rooms presumably used for dining and accommodation offer a rare and essentially intact example of the original layout.

[Source: Report to the Minister]

## Permit Exemptions

### General Exemptions:

General exemptions apply to all places and objects included in the Victorian Heritage Register (VHR). General exemptions have been designed to allow everyday activities, maintenance and changes to your property, which don't harm its cultural heritage significance, to proceed without the need to obtain approvals under the Heritage Act 2017.

Places of worship: In some circumstances, you can alter a place of worship to accommodate religious practices without a permit, but you must [notify](#) the Executive Director of Heritage Victoria before you start the works or activities at least 20 business days before the works or activities are to commence.

Subdivision/consolidation: Permit exemptions exist for some subdivisions and consolidations. If the subdivision or consolidation is in accordance with a planning permit granted under Part 4 of the *Planning and Environment Act 1987* and the application for the planning permit was referred to the Executive Director of Heritage Victoria as a determining referral authority, a permit is not required.

Specific exemptions may also apply to your registered place or object. If applicable, these are listed below. Specific exemptions are tailored to the conservation and management needs of an individual registered place or object and set out works and activities that are exempt from the requirements of a permit. Specific exemptions prevail if they conflict with general exemptions.

Find out more about heritage permit exemptions [here](#).

|                         |                   |
|-------------------------|-------------------|
| Construction dates      | 1879,             |
| Heritage Act Categories | Registered place, |
| Hermes Number           | 3820              |
| Property Number         |                   |

---

## Extent of Registration

### AMENDMENT OF REGISTER OF HISTORIC BUILDINGS

Historic Building No. 1071:

Former Murray Hotel, 9-11 Murray Esplanade, Echuca, Shire of Campaspe.

(To the extent of:

1. All of the building known as the former Murray Hotel marked B-1 on Plan No. 605553 signed by the Chairperson, Historic Buildings Council and held by the Director, Historic Buildings Council, and
2. All of the land in Certificate of Title, Volume 5342, Folio 211 marked L-1 on Plan 605553 signed by the Chairperson, Historic Buildings Council and held by the Director, Historic Buildings Council.)

[*Victoria Government Gazette* No. G7 23 February 1995 p.413]

*This place/object may be included in the Victorian Heritage Register pursuant to the Heritage Act 2017. Check the Victorian Heritage Database, selecting 'Heritage Victoria' as the place source.*

*For further details about Heritage Overlay places, contact the relevant local council or go to Planning Schemes Online <http://planningschemes.dpcd.vic.gov.au/>*