

# NATIONAL BANK



NATIONAL BANK SOHE  
2008



1 national bank benalla front view mar1994

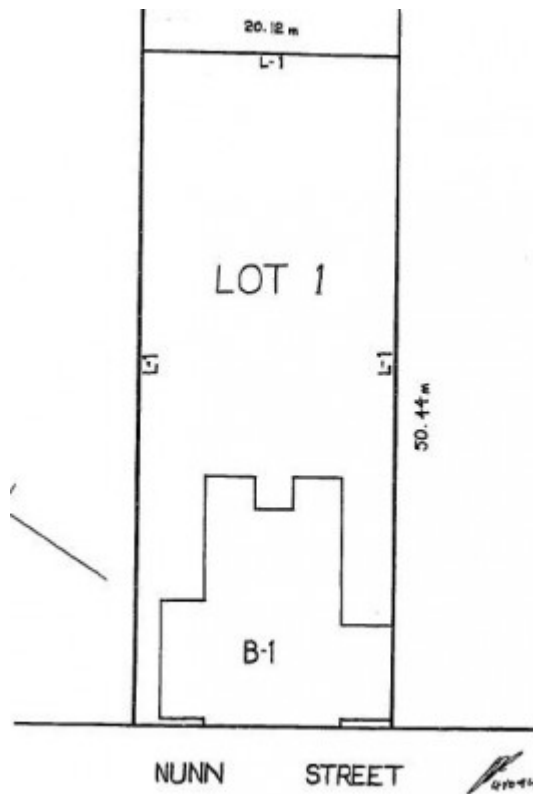

h01056 plan h1056

## Location

75-79 NUNN STREET BENALLA, Benalla Rural City

## Municipality

BENALLA RURAL CITY

### **Level of significance**

Registered

### **Victorian Heritage Register (VHR) Number**

H1056

### **Heritage Overlay Numbers**

HO23

### **VHR Registration**

November 10, 1994

### **Heritage Listing**

Victorian Heritage Register

---

### **Statement of Significance**

Last updated on - May 5, 1999

What is significant?

The National Bank, Benalla was built in 1891 by contractor Mr Ferguson to a design by architects Gordon & Gordon. The two-storeyed stuccoed bank with cast iron verandah was originally designed to accommodate a banking chamber on the ground floor with manager's residence occupying the rear section at ground level and the entire second storey.

In 1919 the lower section of the verandah was removed and the ground floor area enclosed. A single storey addition was constructed at the south of the building in 1980 and in 1989 a matching northern extension was built.

How is it significant?

The Bank has historic, social and architectural significance to Victoria.

Why is it significant?

The Benalla National Bank attains a stylistic rarity through the successful integration of a 1919 Edwardian Baroque style enlargement of the banking chamber at the ground floor into a typical 1890s Boom style bank. The visual solidity of the 1919 Edwardian Baroque style enlargement is also a symbolic representation of the desire of banks to re-establish an image of substance and security following the bank failures of the 1890s.

The bank demonstrates an association with the social status and role of the bank manager in a country town. The disproportionate size of the residence, which once occupied the entire upper storey and part of the rear ground section, compared to the original smaller, closed rooms of the banking chamber, reflects the high social standing of a country bank manager.

The alterations to the building over time demonstrate changing sequence of styles, patterns of occupancy and functions. The internal modifications which enlarged the banking chamber and opened it to public scrutiny and the fact that the residence is no longer used by the manager for security reasons demonstrate the changing position of the manager's social status and the changing needs and practices of the banking industry.

Construction dates	1891,
Architect/Designer	Gordon & Gordon,
Heritage Act Categories	Registered place,
Hermes Number	3828
Property Number	

---

## Plaque Citation

Designed by architects Gordon & Gordon and built in a Boom style in 1891 this bank incorporated a large manager's residence above. In 1919 the ground floor verandah was replaced with an Edwardian Baroque style addition.

## Extent of Registration

### AMENDMENT OF REGISTER OF HISTORIC BUILDINGS

Historic Building No. 1056.

National Bank, 75-79 Nunn Street, Benalla.

(To the extent of:

1. All of the building known as the National Bank, Benalla marked B-1 on Plan 605622 endorsed by the Chairperson, Historic Buildings Council and held by the Director, Historic Buildings Council.
  2. All of the land described in Certificate of Title Volume 1279 Folio 607 marked L-1 on Plan 605622 endorsed by the Chairperson, Historic Buildings Council and held by the Director, Historic Buildings Council.)
- [*Victoria Government Gazette* No. G45 10 November 1994 p.3008]

*This place/object may be included in the Victorian Heritage Register pursuant to the Heritage Act 2017. Check the Victorian Heritage Database, selecting 'Heritage Victoria' as the place source.*

*For further details about Heritage Overlay places, contact the relevant local council or go to Planning Schemes Online <http://planningschemes.dpcd.vic.gov.au/>*