

# BENALLA WATER SUPPLY DEPOT



BENALLA WATER SUPPLY DEPOT SOHE 2008



1 benalla water system  
benalla view of property



benalla water supply depot  
benalla blacksmiths shop she  
project 2003



benalla water supply depot  
benalla carpenters shop she  
project 2003



benalla water supply depot  
benalla pump shed she  
project 2003



benalla water supply depot  
benalla steel tank she project  
2003

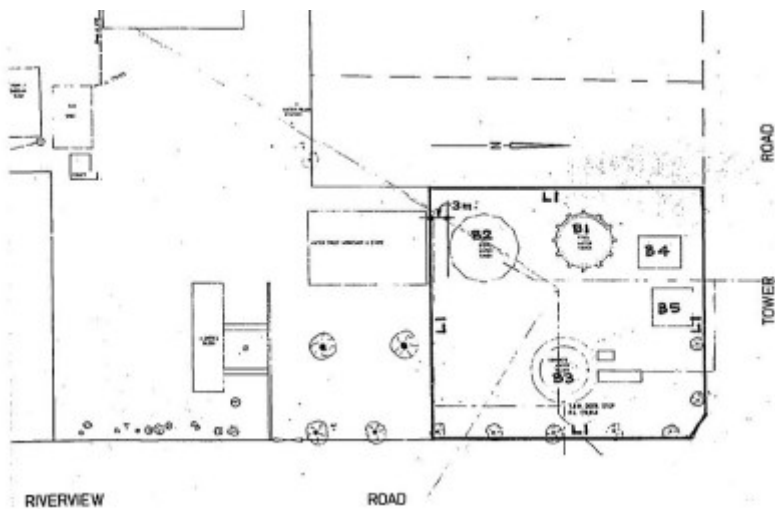

h01048 plan h1048

## Location

1-3 RIVERVIEW ROAD BENALLA, BENALLA RURAL CITY

## **Municipality**

BENALLA RURAL CITY

## **Level of significance**

Registered

## **Victorian Heritage Register (VHR) Number**

H1048

## **Heritage Overlay Numbers**

HO24

## **VHR Registration**

November 10, 1994

## **Heritage Listing**

Victorian Heritage Register

---

## **Statement of Significance**

Last updated on - May 5, 1999

What is significant?

The Benalla Water Supply Depot comprises a c.6 metre diameter riveted iron tank, with blacksmiths shop; a steel tank, a reinforced concrete tower; a carpenters shop; and a brick pumphouse.

How is it significant?

The Benalla Water Supply Depot is of significance to the State of Victoria for technological and social reasons.

Why is it significant?

The Benalla Water Supply Depot demonstrates the evolving nature of a municipal water supply expanding to cope with the increasing demands of a growth in population in a country town. The sequence of water tanks and the existence of workshops designed to build and repair all the machinery needed to provide town water supply illustrates the level of independence needed to maintain such structures in rural Victoria.

The Benalla Water Supply Depot is an essentially intact example of a complex which demonstrates the changes in water tower design since the 1880s. It is also a rare surviving example of a nineteenth century municipal water supply complex containing all the elements needed to supply a rural town in that period: an iron water tower, blacksmith's shop, carpenters shop and pumphouse. The Water Supply depot is important because of its ability to demonstrate the population growth of Benalla, an important rural town in Victoria for over a century, and its increasing demands for a safe and constant supply of drinking water.

## **Permit Exemptions**

**General Exemptions:**

General exemptions apply to all places and objects included in the Victorian Heritage Register (VHR). General exemptions have been designed to allow everyday activities, maintenance and changes to your property, which don't harm its cultural heritage significance, to proceed without the need to obtain approvals under the Heritage Act 2017.

Places of worship: In some circumstances, you can alter a place of worship to accommodate religious practices without a permit, but you must **notify** the Executive Director of Heritage Victoria before you start the works or activities at least 20 business days before the works or activities are to commence.

Subdivision/consolidation: Permit exemptions exist for some subdivisions and consolidations. If the subdivision or consolidation is in accordance with a planning permit granted under Part 4 of the *Planning and Environment Act 1987* and the application for the planning permit was referred to the Executive Director of Heritage Victoria as a determining referral authority, a permit is not required.

Specific exemptions may also apply to your registered place or object. If applicable, these are listed below. Specific exemptions are tailored to the conservation and management needs of an individual registered place or object and set out works and activities that are exempt from the requirements of a permit. Specific exemptions prevail if they conflict with general exemptions.

Find out more about heritage permit exemptions [here](#).

Construction dates	1879,
Architect/Designer	Grainger, J,
Heritage Act Categories	Registered place,
Hermes Number	3829
Property Number	

---

## Extent of Registration

### AMENDMENT OF REGISTER OF HISTORIC BUILDINGS

Historic Building No. 1048.

Benalla Water Supply Depot, Riverview Road, Benalla.

(To the extent of:

1. All the buildings known as the Benalla Water Supply Depot including the iron tank and brick blacksmith shop (B-1); the steel tank (B-2); the reinforced concrete tower (B-3); the carpenters shop (B-4) and the pumphouse (B-5) marked on Plan 605623, signed by the Chairperson of the Historic Buildings Council and held by the Director, Historic Buildings Council.

2. Portion of that land contained in Certificate of Title marked L-1 on Plan 605623, signed by the Chairperson of the Historic Buildings Council and held by the Director, Historic Buildings Council.)

[*Victoria Government Gazette* No. G45 10 November 1994 p.3007]

*This place/object may be included in the Victorian Heritage Register pursuant to the Heritage Act 2017. Check the Victorian Heritage Database, selecting 'Heritage Victoria' as the place source.*

*For further details about Heritage Overlay places, contact the relevant local council or go to Planning Schemes Online <http://planningschemes.dpcd.vic.gov.au/>*