

ANSELM



ANSELM SOHE 2008



ANSELM SOHE 2008



ANSELM SOHE 2008



1 anselm glenferrie road
caulfield front view sep1998

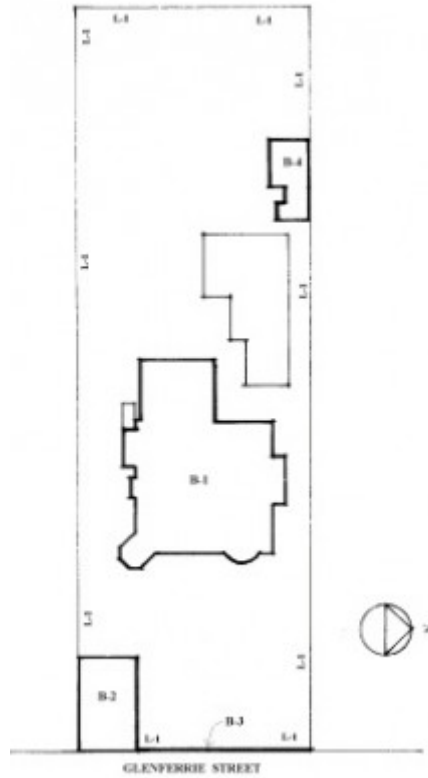

anselm glenferrie road caulfield plan

Location

4 GLENFERRIE STREET CAULFIELD NORTH, GLEN EIRA CITY

Municipality

GLEN EIRA CITY

Level of significance

Registered

Victorian Heritage Register (VHR) Number

H1795

Heritage Overlay Numbers

HO27

VHR Registration

April 22, 1999

Heritage Listing

Victorian Heritage Register

Statement of Significance

Last updated on - April 7, 2021

What is significant?

Anselm was designed by noted English born architect Robert Joseph Haddon(1866-1929) as his own house and constructed in 1906. A single storey Arts and Crafts influenced red brick house with attic, Anselm has a pyramidal slate roof with prominent chimney stacks. There is a octagonal corner tower with saucer shaped domed roof surmounted by a weather vane, and the tower has decorative terracotta panels immediately below the eaves line. The front door opens immediately into a large living or common room, screened from view by a timber and bottle glass screen. The large room was designed to function as a drawing and dining room. The house is rich with hand crafted details including door and window furniture, wrought iron gutter brackets, fireplaces (one with built in wood box), and fire tools. The interior decoration includes hand painted frieze of Port Phillip in the study, and a hand painted frieze of turbulent sea with sailing boats in the tiled bathroom. There is a small hand painted tile at the base of the tower which states "This building was erected AD1906 from designs by Robt J Haddon FRIBA,Lond FRIVA Melb Architect?". He also designed an attic addition which was constructed in 1927. Anselm is substantially intact although the double casement window immediately to the south of the front door was originally circular.

How is it significant?

Anselm is of historical and architectural significance to the state of Victoria.

Why is it significant?

Anselm is historically significant as the home of highly influential architect, teacher and writer Robert Haddon, who was a consulting architect from his office known as the Central Drawing Office and was associated with the

work of a number of architects and firms such as G B Leith and Sydney Smith and Ogg of Melbourne and Laird and Barlow of Geelong, and Michael McCabe of Camperdown. He was head of the department of architecture at the Working Men's College from 1902 and a founding Vice president of the Arts and Crafts Society of Victoria.. He influenced many architects through his teachings including Percy Oakley, A C Leith, E M Nicholls and Eric Hughes who were articled in his office and later became principals of their own firms.

Anselm is architecturally significant as an Arts and Crafts influenced villa and as an example of the work of architect Robert Haddon, which combines elements characteristic of much of his work including the corner tower, decorative Art Nouveau style terra cotta work. Anselm is important for its ability to demonstrate many of the principles he espoused and which are explained in his book 'Australian Architecture' published in 1908. These principles include simplicity, originality, craftsmanship, honesty and national sentiment. The house demonstrates the various ideas he held on the external appearance of a building, as well as on the design of the house and garden. Anselm is significant for its innovative planning with the use of what he described as a common room, rather than separate dining and drawing rooms, and unusual absence of a hallway. It is also significant for exhibiting a richness in hand crafted or painted decoration, which are evidence of his lifelong interest in art and craftwork. The garden retains much of the original hard landscaping including the central terracotta paved front path, side path and glazed terracotta surface drainage system, and is also important for its ability to demonstrate his ideas on garden design.

Permit Exemptions

General Exemptions:

General exemptions apply to all places and objects included in the Victorian Heritage Register (VHR). General exemptions have been designed to allow everyday activities, maintenance and changes to your property, which don't harm its cultural heritage significance, to proceed without the need to obtain approvals under the Heritage Act 2017.

Places of worship: In some circumstances, you can alter a place of worship to accommodate religious practices without a permit, but you must [notify](#) the Executive Director of Heritage Victoria before you start the works or activities at least 20 business days before the works or activities are to commence.

Subdivision/consolidation: Permit exemptions exist for some subdivisions and consolidations. If the subdivision or consolidation is in accordance with a planning permit granted under Part 4 of the *Planning and Environment Act 1987* and the application for the planning permit was referred to the Executive Director of Heritage Victoria as a determining referral authority, a permit is not required.

Specific exemptions may also apply to your registered place or object. If applicable, these are listed below. Specific exemptions are tailored to the conservation and management needs of an individual registered place or object and set out works and activities that are exempt from the requirements of a permit. Specific exemptions prevail if they conflict with general exemptions.

Find out more about heritage permit exemptions [here](#).

Specific Exemptions:

General Conditions:

1. All exempted alterations are to be planned and carried out in a manner which prevents damage to the fabric of the registered place or object.
2. Should it become apparent during further inspection or the carrying out of alterations that original or previously hidden or inaccessible details of the place or object are revealed which relate to the significance of the place or object, then the exemption covering such alteration shall cease and the Executive Director shall be notified as soon as possible.
3. If there is a conservation policy and plan approved by the Executive Director, all works shall be in accordance with it.
4. Nothing in this declaration prevents the Executive Director from amending or rescinding all or any of the permit

exemptions.

5. Nothing in this declaration exempts owners or their agents from the responsibility to seek relevant planning or building permits from the responsible authority where applicable.

The following permit exemptions apply to the residence B 1 only but do not apply to the hand painted mural in the study, or to the ground floor bathroom tiled walls:

* Interior painting to previously painted walls and ceilings, provided the preparation work does not remove evidence of the building's original paint or other decorative scheme.

* Removal of existing carpets and flexible floor coverings.

* Installation of carpet and flexible floor coverings

* Removal of existing kitchen benches and fixtures, and installation of new kitchen benches and fixtures, including associated wiring and plumbing.

The following permit exemptions apply to the garden:

* Minor repairs and maintenance which replace like with like.

* Erection of small, plain (not "period") outbuildings including sheds, aviaries, kennels, poultry sheds and the like provided that they are not visible from the front garden and provided that no new outbuilding is larger than 10 square metres in floor area or 2.4 metres in height.

* Regular garden maintenance.

* Installation, removal or replacement of garden watering systems, provided the installation of the watering systems do not cause short or long term moisture problems to the building.

* Removal of hard landscaping elements which are not shown in Haddon's original plan for Anselm.

Construction dates	1906,
Architect/Designer	Haddon, Robert Joseph,
Heritage Act Categories	Registered place, Registered object integral to a registered place,
Hermes Number	4442
Property Number	

Extent of Registration

NOTICE OF REGISTRATION

As Executive Director for the purpose of the Heritage Act, I give notice under section 46 that the Victorian Heritage Register is amended by including the Heritage Register Number 1795 in the categories described as a Heritage Place and a Heritage Object:

Anselm, 4 Glenferrie Street, North Caulfield, Glen Eira City Council.

EXTENT:

1. The building known as Anselm B 1, the garage B 2, the front fence and gate B 3, the shed/toilet B 4 and all hard landscaping as shown on Diagram 607044 held by the Executive Director.

2. The following Objects: 4 No handcrafted fire tools located in B 1.

3. All the land marked L 1 on Diagram 607044 held by the Executive Director, being all of the land described in Certificate of Title Volume 3054 Folio 668.

Dated 13 April 1999.

RAY TONKIN

Executive Director

[*Victoria Government Gazette* G 16 22 April 1999 p.935]

This place/object may be included in the Victorian Heritage Register pursuant to the Heritage Act 2017. Check the Victorian Heritage Database, selecting 'Heritage Victoria' as the place source.

For further details about Heritage Overlay places, contact the relevant local council or go to Planning Schemes Online <http://planningschemes.dpcd.vic.gov.au/>