

PRIMARY SCHOOL NO. 734



PRIMARY SCHOOL NO. 734
SOHE 2008



PRIMARY SCHOOL NO. 734
SOHE 2008



1 primary school number 734
dandenong road clayton front
view

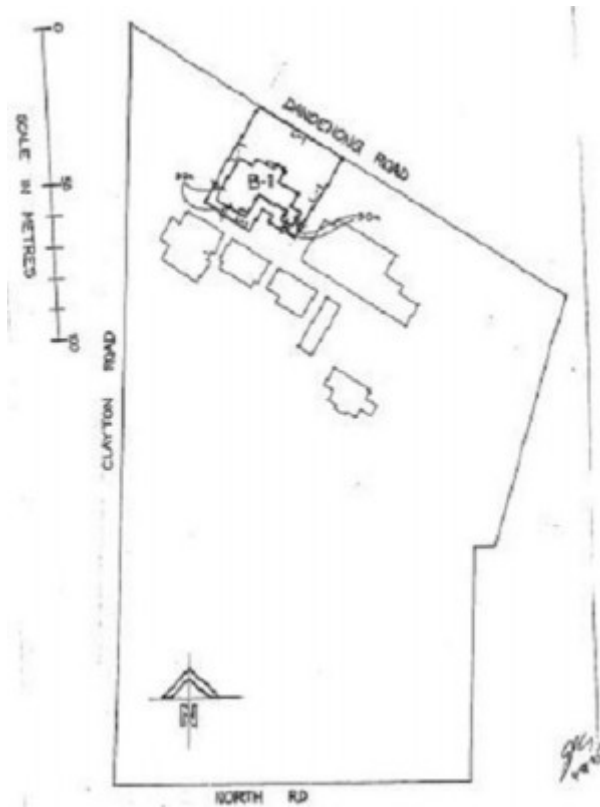

h01084 plan h1084

Location

1714-1716 DANDENONG ROAD CLAYTON, MONASH CITY

Municipality

MONASH CITY

Level of significance

Registered

Victorian Heritage Register (VHR) Number

H1084

Heritage Overlay Numbers

HO20

VHR Registration

June 1, 1995

Heritage Listing

Victorian Heritage Register

Statement of Significance

Last updated on - May 5, 1999

What is significant?

Clayton North Primary School was established in 1865 and in 1875 its original wooden school building was replaced by a stone and brick structure comprising one classroom. In 1909 a brick building was constructed in Edwardian Baroque Style which incorporated the earlier structure. The architect was JB Cohen of the Public Works Department. The school has been in continuous operation since 1865.

How is it significant?

The main brick building at Clayton North Primary School is of architectural and historical significance to Victoria.

Why is it significant?

The main school building is an extraordinary example of the Edwardian baroque style produced by the Public works Department with highly asymmetrical elevations combining a variety of gables, parapet lines, rain water heads and chimneys, and featuring a squat octagonal lantern bell tower. It successfully incorporates an earlier brick and stone structure into the design.

Permit Exemptions

General Exemptions:

General exemptions apply to all places and objects included in the Victorian Heritage Register (VHR). General exemptions have been designed to allow everyday activities, maintenance and changes to your property, which don't harm its cultural heritage significance, to proceed without the need to obtain approvals under the Heritage Act 2017.

Places of worship: In some circumstances, you can alter a place of worship to accommodate religious practices

without a permit, but you must [notify](#) the Executive Director of Heritage Victoria before you start the works or activities at least 20 business days before the works or activities are to commence.

Subdivision/consolidation: Permit exemptions exist for some subdivisions and consolidations. If the subdivision or consolidation is in accordance with a planning permit granted under Part 4 of the *Planning and Environment Act 1987* and the application for the planning permit was referred to the Executive Director of Heritage Victoria as a determining referral authority, a permit is not required.

Specific exemptions may also apply to your registered place or object. If applicable, these are listed below. Specific exemptions are tailored to the conservation and management needs of an individual registered place or object and set out works and activities that are exempt from the requirements of a permit. Specific exemptions prevail if they conflict with general exemptions.

Find out more about heritage permit exemptions [here](#).

Construction dates	1865,
Architect/Designer	Cohen, JB,
Heritage Act Categories	Registered place,
Other Names	CLAYTON NORTH PRIMARY SCHOOL,
Hermes Number	4614
Property Number	

History

Associated People:

Owner DEPARTMENT OF EDUCATION;

Extent of Registration

AMENDMENT OF REGISTER OF HISTORIC BUILDINGS

Historic Building No. 1084:

Clayton North Primary School (No. 734), 1714-1716 Dandenong Road, Clayton North, City of Monash.

Extent:

- (1) To the extent of all the building known as the 1909 main building at Clayton North Primary School marked as B-1 on Plan 605657 endorsed by the Chairperson HBC and held by the Director HBC.
- (2) All the land from the Dandenong Road facade of the building to the street boundary and a curtilage of three metres from the base of the remaining walls of the building, being part of the land set aside as a Common School Reserve on Crown Allotment 15A in the Parish of Mulgrave, County of Bourke, marked L-1 on Plan 605657 endorsed by the Chairperson HBC and held by the Director HBC.
[*Victoria Government Gazette* No. G21 1 June 1995 p.1338]

This place/object may be included in the Victorian Heritage Register pursuant to the Heritage Act 2017. Check the Victorian Heritage Database, selecting 'Heritage Victoria' as the place source.

For further details about Heritage Overlay places, contact the relevant local council or go to Planning Schemes Online <http://planningschemes.dpcd.vic.gov.au/>