

# FORMER ROYAL AUSTRALIAN FIELD ARTILLERY BARRACKS



FORMER ROYAL AUSTRALIAN FIELD ARTILLERY BARRACKS SOHE 2008



FORMER ROYAL AUSTRALIAN FIELD ARTILLERY BARRACKS SOHE 2008



FORMER ROYAL AUSTRALIAN FIELD ARTILLERY BARRACKS SOHE 2008



FORMER ROYAL AUSTRALIAN FIELD ARTILLERY BARRACKS SOHE 2008



h01098 1 rafa barracks 2001



H01098 rafa barracks guard room 1995



H01098 rafa barracks gun shed 1995



H01098 rafa barracks horse hospital demolished 1995



H01098 rafa barracks 1995



H01098 rafa barracks guard room 2001 pm1



H01098 rafa barracks gymnasium 2001 pm1

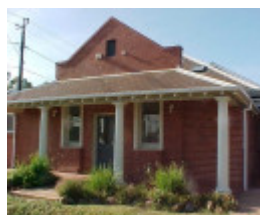

H01098 rafa barracks orderly room 2001 pm1



H01098 rafa barracks qstore infirmary 2001 pm1



H01098 rafa barracks gun shed 2001pm1



h01098 rafa barracks commandant s house 2002



h01098 rafa barracks single men s quarters 2002



h01098 rafa barracks captain s quarters outhouse 2002



h01098 rafa barracks captain s quarters 2002



Rafa Barracks 1 Ordnance Reserve



Rafa Barracks 2 Ordnance Reserve



Rafa Barracks 3 Ordnance Reserve

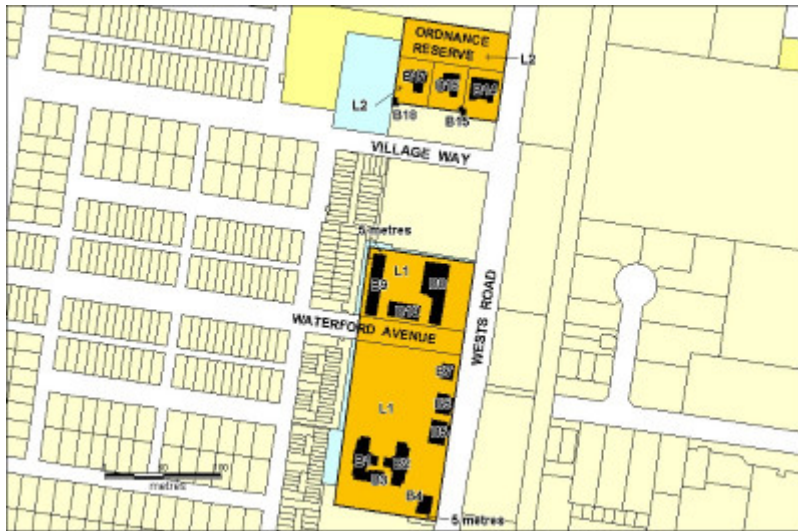

h01098 rafa barracks plan 2

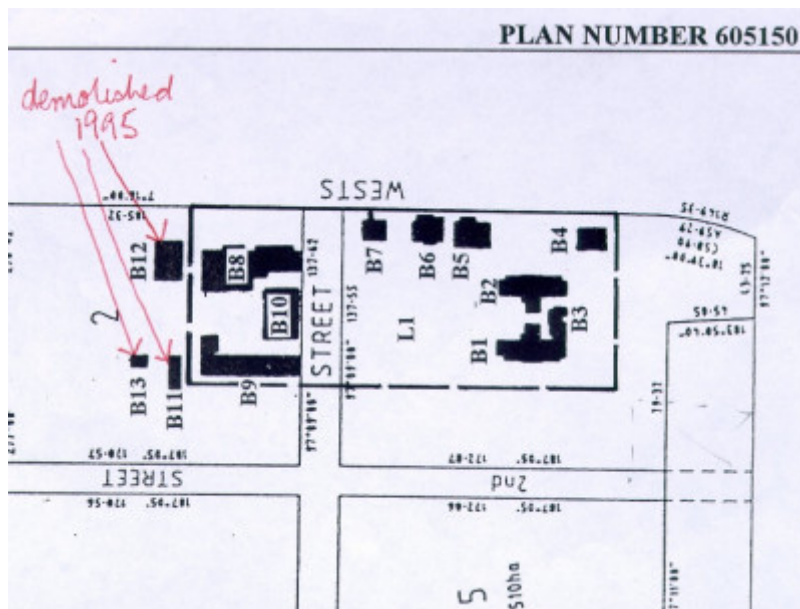

Rafa Barracks Plan

---

## Location

PART OF FORMER ORDNANCE FACTORY, WESTS ROAD MARIBYRNONG AND ORDNANCE RESERVE MARIBYRNONG AND WATERFORD AVENUE MARIBYRNONG, MARIBYRNONG CITY

## Municipality

MARIBYRNONG CITY

## Level of significance

Registered

## Victorian Heritage Register (VHR) Number

H1098

## Heritage Overlay Numbers

HO72

## VHR Registration

October 5, 1995

## Amendment to Registration

February 13, 2003

## Heritage Listing

## Statement of Significance

Last updated on - April 1, 2022

### What is significant?

The buildings that comprise the former Royal Australian Field Artillery (RAFA) Barracks of 1911 are red brick with either slate or corrugated iron roofs grouped around the former parade ground. The accommodation buildings are on the western side of the parade ground with the administration buildings to the east and the stables, gun shed and service buildings to the north. Further north are separate residences for the Commandant, Captain and Single Officers constructed in 1913. There is a consistent architecture throughout the RAFA Barracks which is an eclectic blend of elements of the Federation Free Classical and Arts and Crafts styles favoured by Commonwealth architect John Smith Murdoch (1862 -1945).

### How is it significant?

The former RAFA Barracks is historically, architecturally and socially significant to the State of Victoria.

### Why is it significant?

The former RAFA Barracks buildings form an important, architecturally cohesive complex of early Commonwealth military buildings associated with a field artillery battery. The layout of the complex with the accommodation buildings on the western side of the former parade ground, the administration buildings to the east and the stables, gun shed and service buildings to the north, and distinctly separate quarters for the commanding officers reflects its military function.

The former Royal Australian Field Artillery Barracks is historically significant as the only field artillery depot in Victoria remaining from the pre-World War One era and as a rare example of a site which demonstrates the relationship between soldiers, horses and guns. It is also historically important for its use as a First World War training depot.

The architectural design of the RAFA Barracks buildings is significant as the work of the distinguished Commonwealth architect John Smith Murdoch whose nationally important works include Provisional Parliament House and Yarralumla Canberra, HMAS Cerberus Crib Point, RAAF Point Cook and the former High Court, 450 Little Bourke Street, Melbourne. The three Arts and Crafts Bungalow style houses for the commanding officers were some of the earliest Commonwealth Government houses by Murdoch designed in a Garden Suburb manner. They were the earliest domestic designs by Murdoch in Victoria and were the forerunner to the Garden Suburb designs of many other houses by Murdoch in Australia.

The RAFA Barracks is of interest as a good example of a complex of buildings which have been adapted with minimal alteration from one significant use as a military barracks to another as administration and process buildings in a nationally important munitions factory.

## Permit Exemptions

### General Exemptions:

General exemptions apply to all places and objects included in the Victorian Heritage Register (VHR). General exemptions have been designed to allow everyday activities, maintenance and changes to your property, which don't harm its cultural heritage significance, to proceed without the need to obtain approvals under the Heritage Act 2017.

Places of worship: In some circumstances, you can alter a place of worship to accommodate religious practices without a permit, but you must **notify** the Executive Director of Heritage Victoria before you start the works or activities at least 20 business days before the works or activities are to commence.

Subdivision/consolidation: Permit exemptions exist for some subdivisions and consolidations. If the subdivision or consolidation is in accordance with a planning permit granted under Part 4 of the *Planning and Environment Act 1987* and the application for the planning permit was referred to the Executive Director of Heritage Victoria as a determining referral authority, a permit is not required.

Specific exemptions may also apply to your registered place or object. If applicable, these are listed below. Specific exemptions are tailored to the conservation and management needs of an individual registered place or object and set out works and activities that are exempt from the requirements of a permit. Specific exemptions prevail if they conflict with general exemptions.

Find out more about heritage permit exemptions [here](#).

### **Specific Exemptions:**

General Conditions: 1. All exempted alterations are to be planned and carried out in a manner which prevents damage to the fabric of the registered place or object. General Conditions: 2. Should it become apparent during further inspection or the carrying out of works that original or previously hidden or inaccessible details of the place or object are revealed which relate to the significance of the place or object, then the exemption covering such works shall cease and the Executive Director shall be notified as soon as possible. Note: All archaeological places have the potential to contain significant sub-surface artefacts and other remains. In most cases it will be necessary to obtain approval from Heritage Victoria before the undertaking any works that have a significant sub-surface component. General Conditions: 3. If there is a conservation policy and plan approved by the Executive Director, all works shall be in accordance with it. Note: The existence of a Conservation Management Plan or a Heritage Action Plan endorsed by Heritage Victoria provides guidance for the management of the heritage values associated with the site. It may not be necessary to obtain a heritage permit for certain works specified in the management plan. General Conditions: 4. Nothing in this declaration prevents the Executive Director from amending or rescinding all or any of the permit exemptions. General Conditions: 5. Nothing in this declaration exempts owners or their agents from the responsibility to seek relevant planning or building permits from the responsible authorities where applicable. **SITE/GARDEN WORKS**

The process of gardening, mowing, mulching, removal of dead plants, disease and weed control, emergency and safety works.

Management of trees in accordance with Australian Standard AS 4373 Pruning of Amenity Trees.

Installation, removal and replacement of garden watering systems.

Repair, conservation and maintenance of hard landscaping elements (pavings etc.) which replace like with like.

#### **EXTERNAL:**

Removal of air-conditioners, pipework, wiring, antennae, aerials, and making good.

Installation of damp-proofing by either injection method, or "grouted pocket" method. **INTERNAL:**

Interior painting/wall-papering to walls and ceilings, provided the preparation work for painting papering does not remove evidence of the building's original paint or other decorative scheme.

Removal and replacement of existing carpets and flexible floor coverings.

Removal and replacement of curtain tracks, rods, blinds and other window dressings.

Refurbishment of bathrooms, toilets, ensuites, kitchens and laundries including removal of existing sanitary fixtures and associated piping, mirrors, wall and floor coverings, and installation of new fixtures, and wall and floor coverings.

Removal of existing kitchen cupboards, benches and fixtures (stoves, dishwashers etc.) and floor coverings and installation of new kitchen benches and fixtures, including associated plumbing and wiring. **NOTE:** This exemption does not apply to original pantries, built-in cupboards, stores and their associated shelving.

Installation of ducted, hydronic, or concealed radiant (Ceiling Foil Radiant Heating or under carpet heating) type heating, provided that the installation does not damage existing skirtings, architraves and the location of the heating unit (boiler etc) is concealed from view.

Re-wiring provided that all new wiring is fully concealed and any original light switches, pull cords, or GPO's are retained in-situ.

Note: If wiring is original to the building, timber conduits should be left in situ rather than removed.

Installation of hooks, nails and other devices for hanging paintings, mirrors, and other wall-mounted works of art.

Installation of bulk insulation to roof space.

Installation of smoke detectors.

Construction dates            1911,

Architect/Designer Murdoch, John Smith,  
Heritage Act Categories Registered place,  
Other Names RAFA BARRACKS, ORDNANCE FACTORY,  
Hermes Number 4856  
Property Number

---

## History

Associated People: Owner AUSTRALIAN DEFENCE INDUSTRIES;

## Extent of Registration

### NOTICE OF REGISTRATION

As Executive Director for the purpose of the **Heritage Act 1995**, I give notice under section 46 that the Victorian Heritage Register is amended in that Heritage Register Number H1098 in the category described as a Heritage place is now described as:

Former Royal Australian Field Artillery Barracks, Ordnance Reserve, Maribyrnong, Maribyrnong City Council.

### EXTENT:

1. All of the buildings known as the former Royal Australian Field Artillery Barracks being two Barracks Blocks (B1 and B2), Kitchen (B3), Quartermaster's Store (B4), Gymnasium (B5), Orderly Room (B6), Guard House (B7), two Stable Blocks (B8 and B9), Gun Shed (B10), Commandant's House (B14), Commandant's House and Captain's Quarters outbuildings (B15), Captain's Quarters (B16), Single Officer's Quarters (B17) and Single Officer's Quarters outbuilding (B18) marked on Diagram H1098 held by the Executive Director.

(Note: The Forge and Farriery (B11), Saddler's and Wheeler's Workshop (B12) and the Pharmacy and Sick Boxes (B13) were demolished in 1995.)

2. All of the land within a rectangle formed by the property boundary along Wests Road, a line perpendicular to Wests Road passing 5 metres to the north of the former stables building (B9), a line parallel to Wests Road passing 5 metres west of the former stables building (B9), and a line perpendicular to Wests Road passing 5 metres south of the former Quartermaster's Store (B4) marked L1 on Plan H1098 held by the Executive Director, being part of Lot 1 on Title Plan 3724C, part of Crown Allotment 9, Section 20, Parish of Cut Paw Paw more particularly described in Certificate of Title Volume 10054, Folio 847.

3. All of the land marked L2 on Plan H1098 held by the Executive Director, being Lots 1Ð3 inclusive described in Plan of Subdivision PS431085K and part of the Ordnance Reserve.

Dated 13 February 2003

RAY TONKIN  
Executive Director

[*Victoria Government Gazette* G 7 13 February 2003 257]

*This place/object may be included in the Victorian Heritage Register pursuant to the Heritage Act 2017. Check the Victorian Heritage Database, selecting 'Heritage Victoria' as the place source.*

*For further details about Heritage Overlay places, contact the relevant local council or go to Planning Schemes Online <http://planningschemes.dpcd.vic.gov.au/>*