

ROYAL AGRICULTURAL SHOWGROUNDS

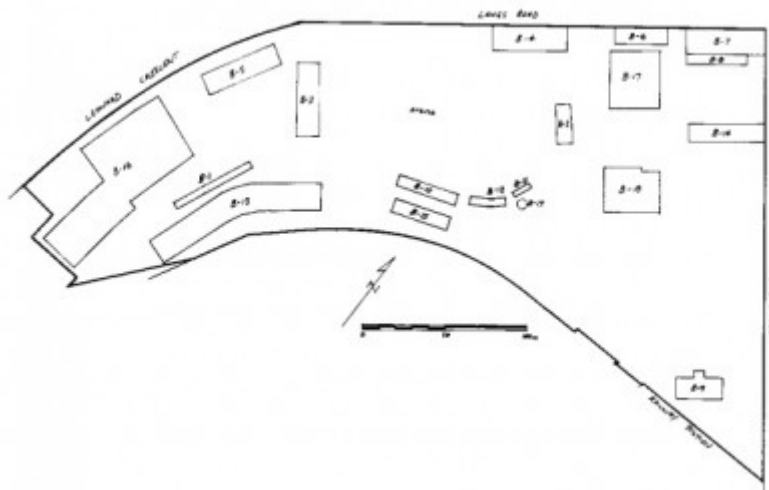

1 royal agricultural
showgrounds epsom road
ascot vale cattle pavillion



royal agricultural showgrounds epsom road ascot vale plan

Location

300 EPSOM ROAD FLEMINGTON, MELBOURNE CITY

Municipality

MELBOURNE CITY

Level of significance

Registered

Victorian Heritage Register (VHR) Number

H1329

Heritage Overlay Numbers

HO221

VHR Registration

August 14, 1997

Heritage Listing

Victorian Heritage Register

Statement of Significance

Last updated on - May 13, 1999

Developed as the base for the Royal Agricultural Society of Victoria and the home of the Royal Melbourne Show from 1883, the Royal Melbourne Showgrounds are Victoria's largest and pre-eminent example of an agricultural showground complex. The substantial grounds contain a large number of buildings conforming to a range of building types, many of which are of individual interest as exemplars of their type. The Showgrounds have been the sole site of the annual Royal Melbourne Show from 1883 until the present, and continue in that role. The continued presence of the Royal Melbourne Show within the showgrounds demonstrates the importance of the metropolitan area as a focus for ideas in agriculture, and also maintains a fundamental principle of the Show, the provision of access for the urban population to information about the rural areas.

The Royal Agricultural Showgrounds are of cultural heritage significance to the State of Victoria.

As a complex, the Royal Agricultural Showgrounds have economic, historical and cultural significance as the largest agricultural show complex in Australia, a vital part of Australia's oldest major industry, and an important location for the enactment of national identity. The site and its show are of cultural significance as the largest single public event held annually in Victoria, attracting in excess of 700,000 persons each year. They are also vital as the major interface between rural and urban populations in Victoria's calendar. These aspects of the significance of the place are intimately related to the ongoing presence of the annual Show upon the site. The fabric of the Showgrounds is the primary illustration of the significant activities of the Royal Agricultural Society of Victoria in the past one hundred years.

The Royal Agricultural Showgrounds represents the most diverse, substantial and significant place of its kind in Australia. Within the complex, the various Cattle, Pig, Dog, Horse and Agricultural Pavilions may be considered to have great architectural, historical and social significance as the largest substantially intact group of Federation and inter-war pavilions in Australia, a significance enhanced by the complementary architecture of the Public, Cliff and Chirnside Grandstands. The Arts & Crafts Pavilion and the Hall of Manufactures are of significance for economic as well as aesthetic reasons, epitomising as they do strong social movements in national development. Other buildings which aid interpretation of the place include the Royal Luncheon Buildings, the Woodfull Pavilion, the Administration Building, the Horse Boxes and Lockers, and the carnival buildings.

Permit Exemptions

General Exemptions:

General exemptions apply to all places and objects included in the Victorian Heritage Register (VHR). General exemptions have been designed to allow everyday activities, maintenance and changes to your property, which don't harm its cultural heritage significance, to proceed without the need to obtain approvals under the Heritage

Act 2017.

Places of worship: In some circumstances, you can alter a place of worship to accommodate religious practices without a permit, but you must [notify](#) the Executive Director of Heritage Victoria before you start the works or activities at least 20 business days before the works or activities are to commence.

Subdivision/consolidation: Permit exemptions exist for some subdivisions and consolidations. If the subdivision or consolidation is in accordance with a planning permit granted under Part 4 of the *Planning and Environment Act 1987* and the application for the planning permit was referred to the Executive Director of Heritage Victoria as a determining referral authority, a permit is not required.

Specific exemptions may also apply to your registered place or object. If applicable, these are listed below. Specific exemptions are tailored to the conservation and management needs of an individual registered place or object and set out works and activities that are exempt from the requirements of a permit. Specific exemptions prevail if they conflict with general exemptions.

Find out more about heritage permit exemptions [here](#).

Specific Exemptions:

EXEMPTIONS FROM PERMITS:

(Classes of works or activities which may be undertaken without a permit under Part 4 of the Heritage Act 1995)

Demolition of or alterations to buildings identified as being of contributory or little significance in the Royal Agricultural Showgrounds, Melbourne - Conservation Plan prepared by Bryce Raworth Pty Ltd in association with Dr Airlie Worrall on behalf of Heritage Victoria and the Royal Agricultural Society of Victoria, April 1997.

Relocation and restoration of the remnant 1903-1915 fabric of the Pig (Rural) Pavilion (B-1) within the Showgrounds curtilage.

Demolition of the 1934 Horse Boxes and Lockers (B-17) and of the 1954 Horse Boxes and Lockers (B-16), providing that a representative sample of at least 10 per cent of each of the two major periods of the present stock is retained.

Alterations to the interior of the Arts & Crafts Building (B-2).

Construction of new buildings as indicated for Precinct 2 in the Structure Plan and Development Plan, (1995).

Removal of paint from previously unpainted buildings such as the Cattle Pavilions (B-3 to B-6).

Reconstruction of the original appearance of the Royal Luncheon Rooms (B-18).

Minor works and maintenance, including repainting of previously painted surfaces and repairs.

Construction dates 1883,

Heritage Act Categories Registered place,

Other Names ROYAL MELBOURNE SHOWGROUNDS,
Hermes Number 4874
Property Number

Extent of Registration

1. All the buildings and structures marked as follows on Diagram 607190 held by the Executive Director:

B1 Pig (Rural) Pavilion; (demolished)
B2 Arts and Crafts Building;
B3 Cattle Pavilion Number 1;
B4 Cattle Pavilion Number 3; (demolished)
B5 Cattle Pavilion Number 4;
B6 Cattle Pavilion Number 5; (demolished)
B7 Horse (Clydesdale) Pavilion;
B8 harness shed; (demolished)
B9 Woodfull Pavilion;
B10 Public Grandstand;
B11 Cliff Grandstand;
B12 Chirnside Grandstand;
B13 Sheep Pavilion and lockers;
B14 Hall of Manufactures; (demolished)
B15 Agricultural (Horticultural) Hall;
B16 horse boxes, lockers and horse Bar;
B17 horse boxes and lockers;
B18 Royal Luncheon Rooms;
B19 food kiosk, incorporating meat pie sign.

2. All the land known as the Royal Agricultural Showgrounds as shown on Diagram 607190 held by the Executive Director and more particularly described in Certificates of Title Vol. 4950 Folio 829, Vol. 4950 Folio 830, Vol. 3807 Folio 226, Vol. 1588 Folio 409, Vol. 1492 Folio 267, Vol. 3227 Folio 245, Vol. 3157 Folio 216, Vol. 1902 Folio 325, Vol.6333 Folio 488, Vol. 3859 Folio 752, Vol. 3843 Folio 500, Vol. 8038 Folio 127, Vol. 1463 Folio 579, Vol. 6826 Folio 164, Vol. 2859 Folio 661, Vol. 2859 Folio 662, Vol. 4956 Folio 111, and Crown Allotments 28D and 28E, Parish of Doutta Galla, County of Bourke.

This place/object may be included in the Victorian Heritage Register pursuant to the Heritage Act 2017. Check the Victorian Heritage Database, selecting 'Heritage Victoria' as the place source.

For further details about Heritage Overlay places, contact the relevant local council or go to Planning Schemes Online <http://planningschemes.dpcd.vic.gov.au/>