

# RETURNED SOLDIERS MEMORIAL HALL



RETURNED SOLDIERS  
MEMORIAL HALL SOHE  
2008



1 returned soldiers hall  
bendigo front dome

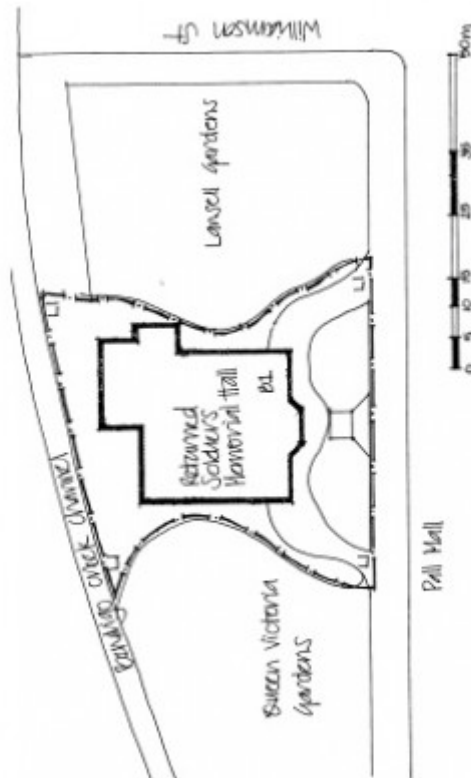

returned soldiers hall bendigo garden plan

## Location

39 PALL MALL BENDIGO, GREATER BENDIGO CITY

## Municipality

GREATER BENDIGO CITY

## Level of significance

Registered

## Victorian Heritage Register (VHR) Number

H1339

## Heritage Overlay Numbers

HO222

## VHR Registration

August 14, 1997

## Heritage Listing

Victorian Heritage Register

---

## Statement of Significance

Last updated on - May 13, 1999

What is significant?

The Returned Soldiers' Memorial Hall was opened on 15 November 1921 by the Earl of Stradbroke as a permanent memorial to all those from Bendigo who served in World War One and particularly to those who died in service. The design of the memorial hall characterised by stripped and distorted classicism popular with public buildings of the early twentieth century, was by local architect Mr GD Garvin of the architectural partnership, W Beebe and GD Garvin. The memorial hall was planned to provide accommodation for a club for returned soldiers, a band rotunda and a publicly accessible honour roll. on Anzac Day, 1926 the Honour Roll, with 2300 names on bronze tablets fitted on the wall of the loggia of the Memorial was unveiled.

How is it significant?

The Returned Soldiers' Memorial Hall, Bendigo is of architectural, social and historical significance to the state of Victoria.

Why is it significant?

The Memorial is of architectural importance as an unusual example of a war memorial hall designed to accommodate a band rotunda on the roof. The building has well designed external detailing, integrating symbolic memorial wreaths and flags characteristic of war memorials with more standard classical architectural features. The Bendigo Returned Soldier's Memorial is of historical and social importance as a large intact memorial hall commemorating the citizens of Bendigo and region who served and gave their lives during World War I.

## Permit Exemptions

### General Exemptions:

General exemptions apply to all places and objects included in the Victorian Heritage Register (VHR). General exemptions have been designed to allow everyday activities, maintenance and changes to your property, which don't harm its cultural heritage significance, to proceed without the need to obtain approvals under the Heritage Act 2017.

Places of worship: In some circumstances, you can alter a place of worship to accommodate religious practices without a permit, but you must **notify** the Executive Director of Heritage Victoria before you start the works or activities at least 20 business days before the works or activities are to commence.

Subdivision/consolidation: Permit exemptions exist for some subdivisions and consolidations. If the subdivision or consolidation is in accordance with a planning permit granted under Part 4 of the *Planning and Environment Act 1987* and the application for the planning permit was referred to the Executive Director of Heritage Victoria as a determining referral authority, a permit is not required.

Specific exemptions may also apply to your registered place or object. If applicable, these are listed below. Specific exemptions are tailored to the conservation and management needs of an individual registered place or object and set out works and activities that are exempt from the requirements of a permit. Specific exemptions prevail if they conflict with general exemptions.

Find out more about heritage permit exemptions [here](#).

### Specific Exemptions:

Nil

Construction dates	1921,
Architect/Designer	Garvin, GD,
Heritage Act Categories	Registered place,
Other Names	BENDIGO RSL,
Hermes Number	5150
Property Number	

---

## History

Contextual History:History of Place:

The Soldier's Memorial Hall, in Pall Mall, Bendigo was constructed to a design of local architect, GD Garvin, in 1921 and opened on 21 November 21. The hall was constructed to commemorate the members of the local community who served on World War I and, in particular, those who died whilst in service. A large brass honour roll was added to the loggia of the building in 1926.

The hall was constructed on Pall Mall, replacing the poppet head of the Hustler's Royal Reserve No 2 quartz mine and is thought to sit over the mine, from which gas still escapes into the nearby Bendigo Creek stone lined channel. A cast iron fence cast by Robert and Sons, Bendigo which bounded Rosalind Park was removed for the construction of the war memorial hall which addresses Pall Mall.

The brief for the memorial hall outlined the need for the hall top provide a hall or club for returned soldiers, a band rotunda and a publicly accessible but covered honour roll. The solution of the architect, GD Garvin from local architectural partnership W Beebe and GD Garvin, was to provide a band rotunda on the roof of the building overlooking Pall Mall and o which access was provided via internal stairs. Comments about the design were made in the local paper, reporting the opening;

In the external finishes, the prevailing motif has been the open loggia, on the ground floor with the honour roll and on the first floor the band rotunda. Engaged columns and pilasters treated in the free ionic style of architecture, with arches between them, produce pleasing effects in light and shade and furnish an invitation to anyone to

enter. The main cornice and parapets have been treated with ornamental pressed cement work of bold, but chaste design while all ornamental work has been sparingly but very effectively used. The band rotunda is octagon shaped, supported on pilasters and finished with an octagonal dome, ventilating turret and flag pole.

Internally the hall provided accommodation for an entrance vestibule which provides access to the principal internal room and the band rotunda. Several rooms to the rear of the entrance vestibule were used as an office to the general secretary, committee room and reading and writing rooms. A billiard room and a main assembly room are the two principal rooms in the building.

The building was opened by the Governor of Victoria, the Earl of Stradbroke, in the presence of other city and state dignitaries on November 15, 1921. A large full page report of the ceremony, with photographs appeared in The Bendigo Advertiser, on the following day commenting on the fine design of the building and of the events of the day.

## **Extent of Registration**

1. All the building known as the Returned Soldiers Memorial Hall and marked as B1 on Diagram 607782.
2. All the land marked L1 on Diagram 607782 held by the Executive Director being part of the land described as part of Rosalind Park, Public Reserve and Drainage Reserve, R1375.

*This place/object may be included in the Victorian Heritage Register pursuant to the Heritage Act 2017. Check the Victorian Heritage Database, selecting 'Heritage Victoria' as the place source.*

*For further details about Heritage Overlay places, contact the relevant local council or go to Planning Schemes Online <http://planningschemes.dpcd.vic.gov.au/>*