MASONIC HALL



MASONIC HALL SOHE 2008



MASONIC HALL SOHE 2008



1 masonic hall camperdown
front view sep1997

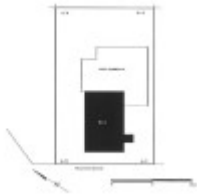

H1414 H1414 plan

Location

248 MANIFOLD STREET CAMPERDOWN, CORANGAMITE SHIRE

Municipality

CORANGAMITE SHIRE

Level of significance

Registered

Victorian Heritage Register (VHR) Number

H1414

Heritage Overlay Numbers

HO79

VHR Registration

February 12, 1998

Heritage Listing

Victorian Heritage Register

Statement of Significance

Last updated on - May 19, 1999

What is significant?

The Masonic Hall, 248 Manifold Street Camperdown, was constructed of rubble bluestone in 1867-68 in eclectic Renaissance Revival style, to the design of lodge member John Young. The Leura Masonic Lodge No. 50 had been formed in 1865 by a number of leading Camperdown citizens and pastoralists. The hall which originally incorporated the temple, is one of the oldest surviving, continuously occupied, purpose-built Masonic structures in Victoria. It is only surpassed by the 1859 purpose-built Beechworth Temple which is still used by the local lodge. The hall is also one of the earliest non-residential buildings in Camperdown. Its important role in the community was emphasised in the years 1869-1885, when a section of the building was used as the Shire of Hampden municipal offices. The hall has also been used regularly for community meetings and social functions. It is substantially intact despite repairs and additions, including the construction of a new temple at the rear in 1922. The finely executed basalt facade is an early exemplar of the stonemason's craft in Camperdown and is particularly relevant to its Masonic history.

How is it significant?

The Masonic Hall, 248 Manifold Street Camperdown, is historically, socially and architecturally important to the State of Victoria.

Why is it significant?

The Masonic Hall, 248 Manifold Street Camperdown, is historically and socially important as one of the earliest purpose-built and continuously occupied Masonic lodge buildings in Victoria. The survival of the lodge for over 130 years emphasises its important role in Camperdown society, while the building itself remains a valued venue for the Camperdown community. The adherence to traditional practices and rituals, which is synonymous with orders such as the Masons, is reflected in the comparative intactness and unchanging use and layout of the building.

The Masonic Hall, 248 Manifold Street Camperdown, is architecturally important as a rare and essentially intact early Masonic structure in Victoria, which incorporates an original temple and ante-rooms expressly designed for lodge purposes. Its strong, distinctive and finely executed Renaissance Revival style facade, with a Masonic symbol set in the parapet, emphasises the lodge's presence in the town. The hall is also one of the oldest surviving non-residential bluestone buildings in Camperdown, and is a notable work of eclectic Geelong-based architect, John Young.

Permit Exemptions

General Exemptions:

General exemptions apply to all places and objects included in the Victorian Heritage Register (VHR). General exemptions have been designed to allow everyday activities, maintenance and changes to your property, which don't harm its cultural heritage significance, to proceed without the need to obtain approvals under the Heritage Act 2017.

Places of worship: In some circumstances, you can alter a place of worship to accommodate religious practices without a permit, but you must **notify** the Executive Director of Heritage Victoria before you start the works or activities at least 20 business days before the works or activities are to commence.

Subdivision/consolidation: Permit exemptions exist for some subdivisions and consolidations. If the subdivision or

consolidation is in accordance with a planning permit granted under Part 4 of the *Planning and Environment Act 1987* and the application for the planning permit was referred to the Executive Director of Heritage Victoria as a determining referral authority, a permit is not required.

Specific exemptions may also apply to your registered place or object. If applicable, these are listed below. Specific exemptions are tailored to the conservation and management needs of an individual registered place or object and set out works and activities that are exempt from the requirements of a permit. Specific exemptions prevail if they conflict with general exemptions.

Find out more about heritage permit exemptions [here](#).

Specific Exemptions:

EXEMPTIONS FROM PERMITS:

(Classes of works or activities which may be undertaken without a permit under Part 4 of the Heritage Act 1995)

General Conditions:

All alterations are to be planned and carried out in a manner which prevents damage to the fabric of the registered place or object.

Should it become apparent during further inspection or the carrying out of alterations that original or previously hidden or inaccessible details of the place or object are revealed which relate to the significance of the place or object, then the exemption covering such alteration shall cease and the Executive Director shall be notified as soon as possible.

If there is a conservation policy and plan approved by the Executive Director, all works shall be in accordance with it.

Nothing in this declaration prevents the Executive Director from amending or rescinding all or any of the permit exemptions.

Nothing in this declaration exempts owners or their agents from the responsibility to seek relevant planning or building permits from the responsible authority where applicable.

Exterior

Minor repairs and maintenance which replace like with like.

Removal of extraneous items such as air conditioners, pipe work, ducting, wiring, antennae, aerials etc, and making good.

Installation or repair of damp-proofing by either injection method or grouted pocket method.

Repair or replacement of timber fences and gates.

Regular garden maintenance.

Installation, removal or replacement of garden watering systems.

Laying, removal or replacement of paving in the front, back and side gardens.

All works (except external additions) to the 20th century additions at the rear and side of the hall.

Interior

Painting of previously painted walls and ceilings provided that preparation or painting does not remove evidence of the original paint or other decorative scheme.

Removal of paint from originally unpainted or oiled joinery, doors, architraves, skirtings and decorative strapping.

Installation, removal or replacement of carpets and/or flexible floor coverings.

Installation, removal or replacement of curtain track, rods, blinds and other window dressings.

Installation, removal or replacement of hooks, nails and other devices for the

hanging of honour boards, paintings and other wall mounted pieces.
Installation, removal or replacement of ducted, hydronic or concealed radiant type heating provided that the installation does not damage existing skirtings and architraves and provided that the location of the heating unit is concealed from view.

Installation, removal or replacement of electrical wiring provided that all new wiring is fully concealed and any original light switches, pull cords, push buttons or power outlets are retained in-situ. Note: if wiring original to the place was carried in timber conduits then the conduits should remain in-situ.

Installation, removal or replacement of bulk insulation in the roof space.

Installation, removal or replacement of smoke detectors.

Construction dates	1867,
Architect/Designer	Long, John,
Heritage Act Categories	Registered place,
Other Names	LEURA,
Hermes Number	5308
Property Number	

Extent of Registration

NOTICE OF REGISTRATION

As Executive Director for the purpose of the Heritage Act, I give notice under Section 46 that the Victorian Heritage Register is amended in that the Heritage Register Number 1414 is now described in the category as a Heritage Place:

Masonic Hall, 248 Manifold Street, Camperdown, Corangamite Shire Council.

EXTENT

1. All of the building marked B-1 on Diagram Number 608105 held by the Executive Director but excluding the red brick 1922 additions.
2. All of the land marked L-1 on Diagram Number 608105 held by the Executive Director being all of the land described in Certificate of Title Volume 7478 Folio 198.

Dated 5 February 1998
RAY TONKIN
Executive Director

[Victoria Government Gazette No. G6 12 February 1998 pp.350-351]

This place/object may be included in the Victorian Heritage Register pursuant to the Heritage Act 2017. Check the Victorian Heritage Database, selecting 'Heritage Victoria' as the place source.

For further details about Heritage Overlay places, contact the relevant local council or go to Planning Schemes Online <http://planningschemes.dpcd.vic.gov.au/>