

FORMER GEELONG GAOL



FORMER HM TRAINING PRISON SOHE 2008



FORMER HM TRAINING PRISON SOHE 2008



FORMER HM TRAINING PRISON SOHE 2008



FORMER HM TRAINING PRISON SOHE 2008



former hm training prison myers street geelong front elevation publication



former hm training prison geelong forecourt north wing sep1992



former hm training prison geelong northeast yard & services building aug1992



former hm training prison geelong watch tower sep1992



1 former hm training prison geelong east wing south east yard jul1984

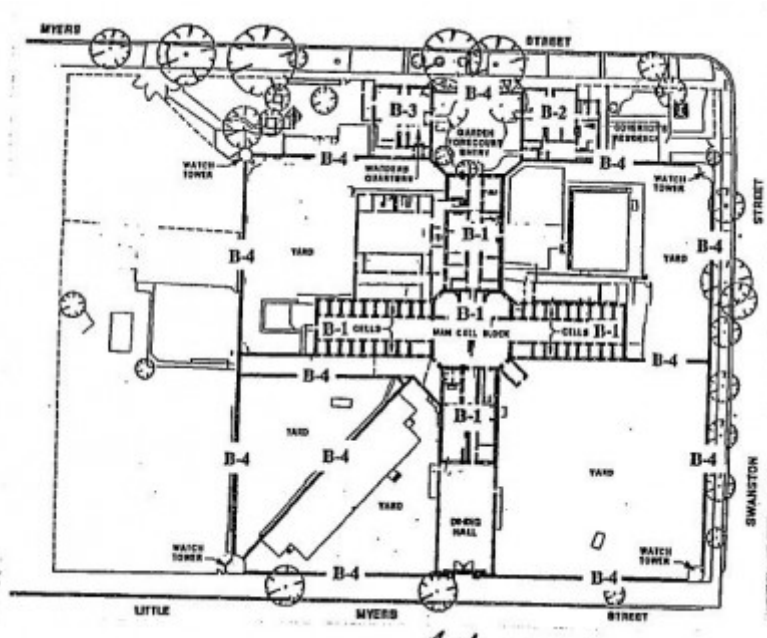

h00991 plan h00991

Location

200-202 MYERS STREET GEELONG, GREATER GEELONG CITY

Municipality

GREATER GEELONG CITY

Level of significance

Registered

Victorian Heritage Register (VHR) Number

H0991

Heritage Overlay Numbers

HO143

VHR Registration

August 20, 1982

Amendment to Registration

October 28, 1993

Heritage Listing

Statement of Significance

Last updated on - February 21, 1997

The completion of the Geelong Gaol in 1864 reflects an important phase of prison constructed in Victoria. Between 1857 and 1864 a remarkable period of building activity saw eight prisons constructed on Pentonville principles in metropolitan and regional areas.

The Geelong Gaol is an essentially intact example of a building type. The sequence of alterations, however, are historically important in representing the changing requirements of prison design and construction.

The Geelong Gaol is a prominent landmark; its design and scale reflecting not only the importance of Geelong in the development of western Victoria but also indicative of Geelong's size and status within the Port Philip district before the discovery of gold in 1851.

The Geelong Gaol is significant in being designed by Henry Ginn, the first colonial architect of Victoria, the plan being produced while he was clerk of works. The first stage of construction was supervised by him.

The Gaol was constructed between 1849 and 1864 and represents an important phase in the development of prison design, being the first prison designed on Pentonville principles in Victoria, albeit cruciform rather than radial in plan.

[Source: Report to the Minister.]

Permit Exemptions

General Exemptions:

General exemptions apply to all places and objects included in the Victorian Heritage Register (VHR). General exemptions have been designed to allow everyday activities, maintenance and changes to your property, which don't harm its cultural heritage significance, to proceed without the need to obtain approvals under the Heritage Act 2017.

Places of worship: In some circumstances, you can alter a place of worship to accommodate religious practices without a permit, but you must [notify](#) the Executive Director of Heritage Victoria before you start the works or activities at least 20 business days before the works or activities are to commence.

Subdivision/consolidation: Permit exemptions exist for some subdivisions and consolidations. If the subdivision or consolidation is in accordance with a planning permit granted under Part 4 of the *Planning and Environment Act 1987* and the application for the planning permit was referred to the Executive Director of Heritage Victoria as a determining referral authority, a permit is not required.

Specific exemptions may also apply to your registered place or object. If applicable, these are listed below. Specific exemptions are tailored to the conservation and management needs of an individual registered place or object and set out works and activities that are exempt from the requirements of a permit. Specific exemptions prevail if they conflict with general exemptions.

Find out more about heritage permit exemptions [here](#).

Construction dates 1857,
Architect/Designer Ginn, Henry,
Heritage Act Categories Registered place,
Other Names GEELONG GAOL, FORMER HM TRAINING PRISON,
Hermes Number 539
Property Number

Extent of Registration

AMENDMENT OF REGISTER OF HISTORIC BUILDINGS

Historic Building No. 991

Former HM Prison

Myers Street, Geelong

(To the extent of:

1. all the buildings known as HM Prison, Geelong, including the main cell block, the Governor's residence, the warders' quarters; and the walls and fences on the Myers, Swanston and Little Myers Streets, marked B-1, B-2, B-3 and B-4 respectively on Plan No. 6037052(A) and signed by the Chairperson, Historic Buildings Council and held by the Director, Historic Buildings Council.

2. all of the land bounded by Myers Street to the north, Swanston Street to the east, Little Myers Street to the west, being that land described in crown reserve, marked L-1 on Plan No. 6037052(B) and signed by the Chairperson, Historic Buildings Council, and held by the Director, Historic Buildings Council.)

[*Victoria Government Gazette* No. G42 28 October 1993 p.2931]

This place/object may be included in the Victorian Heritage Register pursuant to the Heritage Act 2017. Check the Victorian Heritage Database, selecting 'Heritage Victoria' as the place source.

For further details about Heritage Overlay places, contact the relevant local council or go to Planning Schemes Online <http://planningschemes.dpcd.vic.gov.au/>