

CENTRAL COOKMAN QUARTZ GOLD MINE

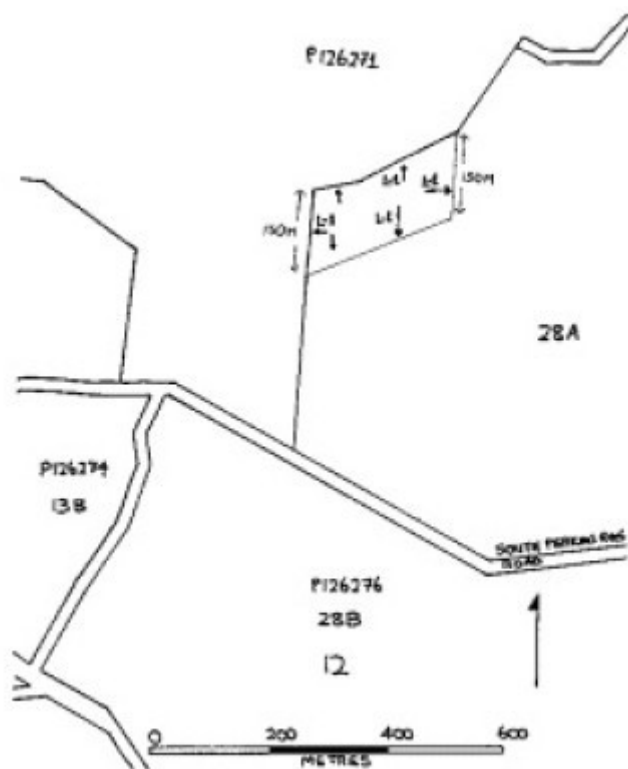

1 central cookman quartz gold mine st parkins reef road maldon landscape jun1997



central cookman quartz gold mine plan

Location

PARKINS REEF ROAD MALDON, MOUNT ALEXANDER SHIRE

Municipality

MOUNT ALEXANDER SHIRE

Level of significance

Registered

Victorian Heritage Register (VHR) Number

H1690

Heritage Overlay Numbers

HO986

VHR Registration

May 21, 1998

Heritage Listing

Victorian Heritage Register

Statement of Significance

Last updated on - May 27, 1999

The Maldon Quartz Reefing Field, although relatively small compared to others in the State, was extraordinarily rich in gold. The hardness and heavy mineralisation of the rock mined put the field's mining companies in the vanguard for the introduction of new technology. The Central Cookman Quartz Gold Mine contains a range of mining foundations and earthworks from mining operations conducted between 1903 and 1912. During this period the company installed state-of-the-art machinery described as the most sophisticated and extensive in the district.

The Central Cookman Quartz Gold Mine is of historical, archaeological and scientific importance to the State of Victoria.

The Central Cookman Quartz Gold Mine is historically and scientifically important as a characteristic example of an important form of gold mining. Gold mining sites are of crucial importance for the pivotal role they have played since 1851 in the development of Victoria. As well as being a significant producer of Victoria's nineteenth century wealth, quartz mining, with its intensive reliance on machinery, played an important role in the development of Victorian manufacturing industry. The Central Cookman Quartz Gold Mine is important as a manifestation of this aspect of gold mining.

The Central Cookman Quartz Gold Mine is scientifically important for the survival of a range of well-preserved quartz mining relics which demonstrate what was described (in 1912) as the district's most up-to-date mining plant. The site, apart from the North British mine at Maldon and the Jubilee mine near Ballarat, has the most intact and complete mining foundations in the State. The quartz roasting kiln is arguably the last of its type to have been erected in the State. The Central Cookman Quartz Gold Mine is significant because of its archaeological potential to yield artefacts and evidence which will be able to provide significant information about the technological history of gold mining.

Permit Exemptions

General Exemptions:

General exemptions apply to all places and objects included in the Victorian Heritage Register (VHR). General exemptions have been designed to allow everyday activities, maintenance and changes to your property, which don't harm its cultural heritage significance, to proceed without the need to obtain approvals under the Heritage Act 2017.

Places of worship: In some circumstances, you can alter a place of worship to accommodate religious practices without a permit, but you must **notify** the Executive Director of Heritage Victoria before you start the works or activities at least 20 business days before the works or activities are to commence.

Subdivision/consolidation: Permit exemptions exist for some subdivisions and consolidations. If the subdivision or consolidation is in accordance with a planning permit granted under Part 4 of the *Planning and Environment Act 1987* and the application for the planning permit was referred to the Executive Director of Heritage Victoria as a determining referral authority, a permit is not required.

Specific exemptions may also apply to your registered place or object. If applicable, these are listed below. Specific exemptions are tailored to the conservation and management needs of an individual registered place or object and set out works and activities that are exempt from the requirements of a permit. Specific exemptions prevail if they conflict with general exemptions.

Find out more about heritage permit exemptions [here](#).

Specific Exemptions:

EXEMPTIONS FROM PERMITS:

(Classes of works or activities which may be undertaken without a permit under Part 4 of the Heritage Act 1995)

No permits are required for the following classes of works provided they are carried out in accordance with the provisions of the Conservation Plan For Historic Mining Sites prepared by David Bannear in 1996.

- * Mineral Exploration
- * Fire suppression duties
- * Timber production
- * Weed and vermin control
- * Public safety
- * Revegetation

No permits are required for the following classes of works carried out for general farming practices, including:

1. Grazing of cattle and sheep.
2. Retaining access to the land.
3. Normal land care maintenance - weed, pest and soil erosion controls, and removal of fallen trees where necessary.
4. Firewood collection

Construction dates 1903,

Heritage Act Categories Registered place, Registered archaeological place,

Hermes Number 5490

Property Number

Extent of Registration

NOTICE OF REGISTRATION

As Executive Director for the purpose of the Heritage Act, I give notice under section 46 that the Victorian Heritage Register is amended by including the Heritage Register Number 1690 in the category described as a Heritage and Archaeological place:

Central Cookman Quartz Gold Mine, South Parkins Reef Road, Maldon, Mt Alexander Shire Council.

EXTENT

1. All the land marked L-1 including aboveground structures (concrete and brick mining machinery foundations, quartz roasting kiln, mullock heap, water ponds, tailings ponds and culverts and benched tracks), and all archaeological features and artefacts on Diagram 608141A held by the Executive Director, being part of the land included in Section 12, Allotment 28A, Parish of Maldon, County of Talbot.

Dated 7 May 1998
RAY TONKIN
Executive Director

[*Victoria Government Gazette* No. G20 21 May 1998 p.1136]

This place/object may be included in the Victorian Heritage Register pursuant to the Heritage Act 2017. Check the Victorian Heritage Database, selecting 'Heritage Victoria' as the place source.

For further details about Heritage Overlay places, contact the relevant local council or go to Planning Schemes Online <http://planningschemes.dpcd.vic.gov.au/>