

STONE COTTAGES



STONE COTTAGES SOHE
2008



STONE COTTAGES SOHE
2008



h01743 1 stone cottages
blakeley road barkers creek
cottage both she project 2004



h01743 stone cottages
blakely road barkers creek
landscape view aug1997



h01743 stone cottages
blakeley road barkers creek
cottage detached chimney
bldg one she project 2004



h01743 stone cottages
blakeley road barkers creek
cottage one chimney she
project 2004



h01743 stone cottages
blakeley road barkers creek
cottage one interior she
project 2004



h01743 stone cottages
blakeley road barkers creek
cottage one side view she
project 2004



h01743 stone cottages
blakeley road barkers creek
cottage two front she project
2004

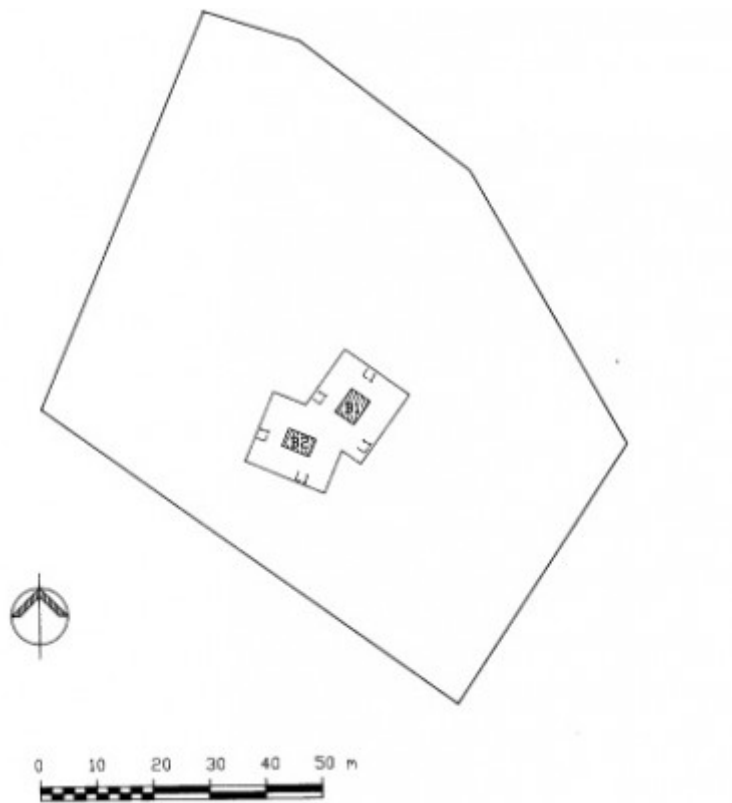

H1743 stone cottages barkers creek plan

Location

205 BLAKELEY ROAD BARKERS CREEK, MOUNT ALEXANDER SHIRE

Municipality

MOUNT ALEXANDER SHIRE

Level of significance

Registered

Victorian Heritage Register (VHR) Number

H1743

Heritage Overlay Numbers

HO679

VHR Registration

September 17, 1998

Heritage Listing

Statement of Significance

Last updated on - May 28, 1999

The two small stone cottages on 'Timber Hills' Homestead, Blakeley Road, Barkers Creek, the origins of which are not confirmed, but possibly constructed by a German, Grosse, in 1853, are derived from English or European vernacular construction practice.

The walls of both cottages are constructed of local sandstone in a mud or mud-lime mortar and the one remaining roof is clad in local large slate slabs, the fixings which are not visible but are said to be secured by a single wooden peg towards the top of each slab. The roof slabs are from 12mm to 25mm thick and up to 1350 mm square in one case and 1800mm by 1200mm in another. The rooves are/were gabled with the stone work on the ends of the cottages concluding at the underside of the apex of the rooves. There is a detached stone chimney on the side elevation of the cottage with the remaining roof. Both cottages have rudimentary door and window openings.

The Stone Cottages at Barkers Creek are architecturally important to the State of Victoria as a rare example of the use of large slate slabs as the roofing material which is derived from English or European vernacular construction practice. The extremely modest size of these vernacular Colonial cottages is also of note.

Permit Exemptions

General Exemptions:

General exemptions apply to all places and objects included in the Victorian Heritage Register (VHR). General exemptions have been designed to allow everyday activities, maintenance and changes to your property, which don't harm its cultural heritage significance, to proceed without the need to obtain approvals under the Heritage Act 2017.

Places of worship: In some circumstances, you can alter a place of worship to accommodate religious practices without a permit, but you must **notify** the Executive Director of Heritage Victoria before you start the works or activities at least 20 business days before the works or activities are to commence.

Subdivision/consolidation: Permit exemptions exist for some subdivisions and consolidations. If the subdivision or consolidation is in accordance with a planning permit granted under Part 4 of the *Planning and Environment Act 1987* and the application for the planning permit was referred to the Executive Director of Heritage Victoria as a determining referral authority, a permit is not required.

Specific exemptions may also apply to your registered place or object. If applicable, these are listed below. Specific exemptions are tailored to the conservation and management needs of an individual registered place or object and set out works and activities that are exempt from the requirements of a permit. Specific exemptions prevail if they conflict with general exemptions.

Find out more about heritage permit exemptions [here](#).

Specific Exemptions:

EXEMPTIONS FROM PERMITS:

(Classes of works or activities which may be undertaken without a permit under

Nil

General Conditions:

1. All permitted works are to be planned and carried out in a manner which prevents damage to the fabric of the registered place or object.
2. Should it become apparent during further inspection or the carrying out of alterations that original or previously hidden or inaccessible details of the place or object are revealed which relate to the significance of the place or object, then such alteration shall cease and the Executive Director shall be notified as soon as possible.
3. If there is a conservation policy and plan approved by the Executive Director, all works shall be in accordance with it.
4. Nothing in this declaration prevents the Executive Director from amending or rescinding all or any of the permit exemptions.
5. Nothing in this declaration exempts owners or their agents from the responsibility to seek relevant planning or building permits from the responsible authority where applicable.

Construction dates 1853,

Heritage Act Categories Registered place, Registered object integral to a registered place,

Hermes Number 5491

Property Number

History

Contextual History:History of Place:

History of Place:

The two stone cottages on Timber Hills Homestead, Blakely Road, Barkers Creek, between Barkers Creek and Castlemaine are two small stone dwellings, the origins of which are of an unknown construction date, possibly from the 1860's. A Malay Chinese couple are said to have been occupying them in 1898 when Timber Hills Homestead was built. This may have been the basis of the local tradition that these houses were built by Chinese. These two buildings are derived from English or European vernacular construction practice and is very rare in Victoria. It has since come to the attention of this officer, but has not been confirmed, that the cottages were built by a German, Grosser, in 1853 along with another structure over the other side of Blakeley Road and now incorporated into a currently occupied domestic dwelling. The 'Timber Hills' property apparently had grapevines early in its history and later was a pig farm until all animals had to be destroyed and burnt because of a fever amongst them.

COMPARISON:

These may be the only examples surviving of this type of roofing (large slate slabs, secured by a single wooden peg towards the top of each slab) in the State of Victoria. This officer was unable to identify other examples in Victoria.

Extent of Registration

NOTICE OF REGISTRATION

As Executive Director for the purpose of the Heritage Act, I give notice under section 46 that the Victorian Heritage Register is amended by including the Heritage Register Number 1743 in the category described as a Heritage place, Heritage objects:

Stone Cottages, Blakeley Road, Barkers Creek, Mount Alexander Shire Council.

EXTENT:

1. All of the buildings marked as follows on Diagram Number 607872 held by the Executive Director.

B-1 The Roofed Stone Cottage

B-2 The Unroofed Stone Cottage

2. All the land marked L-1, an area of land three metres from the edge of the buildings' walls, as marked on Diagram Number 607872, held by the Executive Director, being part of the land described in Certificate of Title Volume 3245, Folio 648907.

Dated: 3 September 1998.

RAY TONKIN

Executive Director

[Victoria Government Gazette G 37 17 September 1998 p.2428]

This place/object may be included in the Victorian Heritage Register pursuant to the Heritage Act 2017. Check the Victorian Heritage Database, selecting 'Heritage Victoria' as the place source.

For further details about Heritage Overlay places, contact the relevant local council or go to Planning Schemes Online <http://planningschemes.dpcd.vic.gov.au/>