

# GEODETIC SURVEY BASELINE



GEODETIC SURVEY  
BASELINE SOHE 2008



1 south base stone  
coverstone intact june01

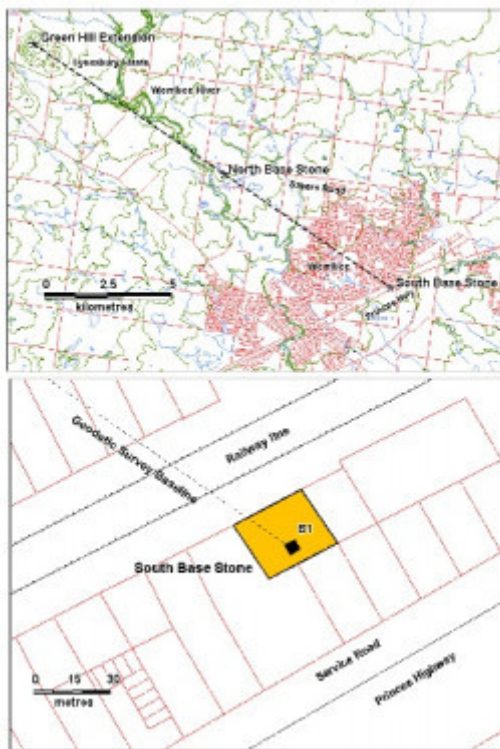
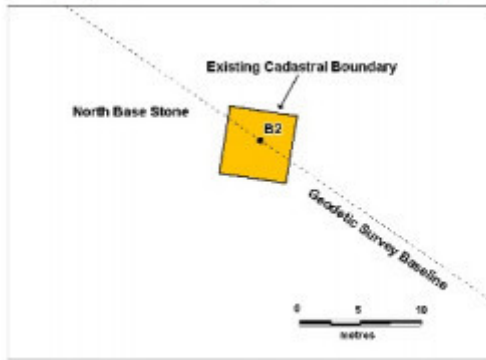
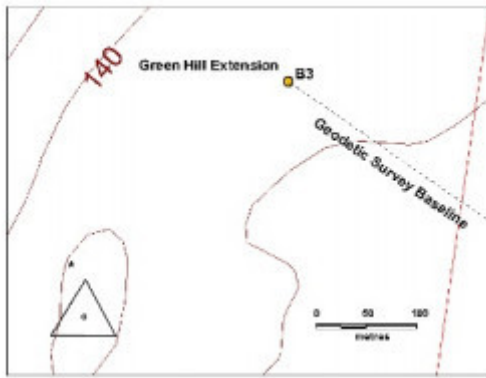

diagram south base stone plan1



north base stone green hill extension marker plan



South Base Stone Plan

REAR OF 301 PRINCES HIGHWAY HOPPERS CROSSING AND 1245 SAYERS ROAD TARNEIT AND OFF SPRINGHILL ROAD EYNESBURY, WYNDHAM CITY

## **Municipality**

WYNDHAM CITY

## **Level of significance**

Registered

## **Victorian Heritage Register (VHR) Number**

H1957

## **Heritage Overlay Numbers**

HO17

## **VHR Registration**

October 15, 2001

## **Heritage Listing**

Victorian Heritage Register

---

## **Statement of Significance**

Last updated on - November 26, 2021

### **What is significant?**

The Geodetic Survey of Victoria, established in the 1860s was a triangulated survey which took into account accurate calculations of the curvature of the earth's surface. The principles of Geodetic Surveying were first developed and applied in England in this period by A R Clarke. To initiate a geodetic survey of a large area, a line of very accurate length had to be established from which the triangulation could commence. Robert Lewis Ellery, Victorian Government Astronomer and Director of Melbourne Observatory for much of the second half of the 19th century, was responsible for task. The site on the Werribee Plains was selected because it was sufficiently flat to facilitate this measurement. The southern end of the baseline was commenced in 1860 from a site near the Werribee Railway Station. The original baseline extended to the north west for five miles to the North Base Stone. The measure of the base took 4 months commencing on 29 January 1860 and completed in 29th May. The baseline was extended northwards by triangulation for nine miles to the Green Hill extension marker on the saddle of Green Hill, completed by June the 12th 1860.

The baseline measuring apparatus consisted of three iron measuring bars made in Victoria against the NSW standard obtained from the Ordnance Survey Department of Southampton, England. The rods were mounted on heavy brass tripods called camels mounted in turn on timber trestles, and leapfrogged along the length of the line. The measuring bars were encased in wooden cases with approximately 2 inches protruding and were protected from exposure to the elements by an A-frame segmented tent structure. . Tent bearers would move the structure forward when one measurement was complete and this process was continued for the entire length of the baseline. The bars were aligned by sight with a theodolite by the two sight vanes on the bar case and the bars were levelled

The historic fabric of the baseline consists of the three base stones, named the south base, the north base and

the Green Hill Extension. There are also three measuring rods of iron and their cases which are now part of the collection of the Museum of Victoria. The South Base is marked by a large cylindrical block of basalt of approximately 500mm diameter set 5 feet (1500m) into the ground with the top flush to ground level. A raised stone torus set in the centre with a gunmetal plug indicates the termini of measure. The base stone is covered with a sculpted square cap stone with iron eyes to aid in lifting. The north end, now within a large paddock to the south of Sayers Road, bears 304 degrees, 36 min. 31 secs. and 4.9146 miles and is marked by similar stone and cap. The marker on Green Hill in the Eynesbury Estate at the end of the later extension along the same line consists of a metal rod of approximately 10mm diameter extending 100mm from ground level embedded in a basalt base stone set flush to the ground. The extension from the North Base stone to the Green Hill extension is 5.651 miles and the total length of the geodetic survey baseline is 10.593 miles (17.048km).

### **How is it significant?**

The Geodetic Survey Baseline is of historical and scientific (technical) significance to the State of Victoria.

### **Why is it significant?**

The Geodetic Survey Baseline is historically significant to the State of Victoria as the principal line of measure upon which the greater Geodetic Survey of Victoria was established. It is the key component of the wider survey, which encompassed the whole of Victoria and was integral and essential to the processes of European settlement Victoria.

The Geodetic Survey Baseline is scientifically significant to the State of Victoria, as it was the first application in Victoria of Clarke's method of triangulation taking into account the polar flattening and equatorial radius of the earth. The survey markers are the remaining physical remnants of the painstaking early practice employed in establishing such a baseline.

The Geodetic Survey Baseline is historically significant for its association with Robert Ellery, the Government Astronomer and Surveyor of the Geodetic Survey.

## **Permit Exemptions**

### **General Exemptions:**

General exemptions apply to all places and objects included in the Victorian Heritage Register (VHR). General exemptions have been designed to allow everyday activities, maintenance and changes to your property, which don't harm its cultural heritage significance, to proceed without the need to obtain approvals under the Heritage Act 2017.

Places of worship: In some circumstances, you can alter a place of worship to accommodate religious practices without a permit, but you must **notify** the Executive Director of Heritage Victoria before you start the works or activities at least 20 business days before the works or activities are to commence.

Subdivision/consolidation: Permit exemptions exist for some subdivisions and consolidations. If the subdivision or consolidation is in accordance with a planning permit granted under Part 4 of the *Planning and Environment Act 1987* and the application for the planning permit was referred to the Executive Director of Heritage Victoria as a determining referral authority, a permit is not required.

Specific exemptions may also apply to your registered place or object. If applicable, these are listed below. Specific exemptions are tailored to the conservation and management needs of an individual registered place or object and set out works and activities that are exempt from the requirements of a permit. Specific exemptions prevail if they conflict with general exemptions.

Find out more about heritage permit exemptions [here](#).

Construction dates	1860,
Heritage Act Categories	Registered place,
Other Names	South Base Stone, SURVEY BASELINE, SURVEY STONE,
Hermes Number	6068
Property Number	

---

## **Extent of Registration**

1. All of the objects known as the geodetic survey baseline marked B1 (South Base stone), B2 (North Base stone) and B3 (Green Hill Extension) on diagram number 1957 held by the Executive Director.
2. All of the land shown on Diagram 1957 held by the Executive Director.  
(explanatory note: registered land consists of the cadastral parcels containing the North and South Base Stones and a 5 metre diameter circle around the Green Hill extension marker)

*This place/object may be included in the Victorian Heritage Register pursuant to the Heritage Act 2017. Check the Victorian Heritage Database, selecting 'Heritage Victoria' as the place source.*

*For further details about Heritage Overlay places, contact the relevant local council or go to Planning Schemes Online <http://planningschemes.dpcd.vic.gov.au/>*