

# BANOOL



BANOOL SOHE 2008



1 banool fitzroy street kilmore  
front view may1980

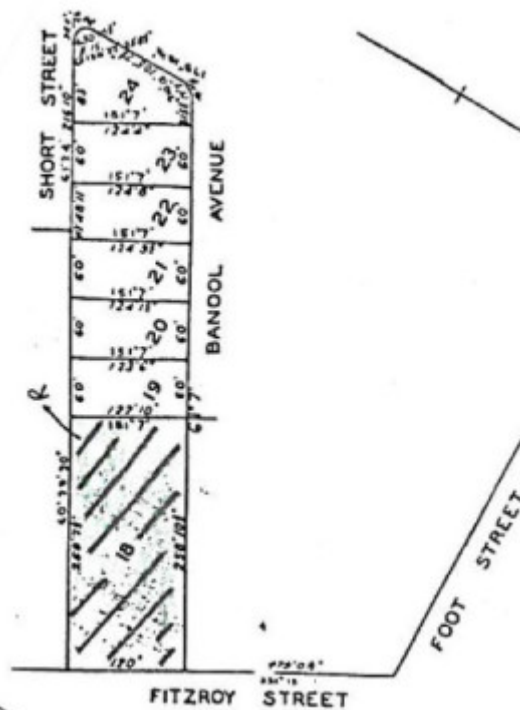

H0752 H0752 plan

## Location

18-20 FITZROY STREET KILMORE, MITCHELL SHIRE

## Municipality

MITCHELL SHIRE

## Level of significance

Registered

## Victorian Heritage Register (VHR) Number

H0752

## Heritage Overlay Numbers

HO56

## VHR Registration

November 15, 1989

## Heritage Listing

Victorian Heritage Register

---

## Statement of Significance

Last updated on - June 28, 1999

HISTORIC BUILDINGS COUNCIL - STATEMENT OF SIGNIFICANCE:

Banool was constructed in 1926 by George Hudson, a partner in the real estate firm of Osborn and Hudson. The architect was Harry A Burt. Burt was from Queensland - this is reflected in the styling - but was then practising from temple court, Melbourne. Duplex timber posts on clinker brick piers carry the oversailing verandah which continues the main hip roof shape on three sides.

The furniture which is original was also designed by Burt.

A half timbered gable rests within a huge expanse of terracotta Marseille-pattern tiles and tall chimney pots, made taller by tall brick shafts, provide the picturesque element to the skyline. The dark stained finish to the ship-lap wall boarding with the terracotta- shade finish to the joinery and the contrasting white trim and bracket capitals extenuate the close resemblance of the house to fourteenth century Japanese structures such as the saimo-ji main hall.

The cypress hedges are all accessories to the period. This house is the best of three similar examples in Kilmore and is one of the better examples of its type in Victoria. Banool is an important and near to original example of the influence of the Californian and Indian bungalow styles in Australia.

## Permit Exemptions

### General Exemptions:

General exemptions apply to all places and objects included in the Victorian Heritage Register (VHR). General exemptions have been designed to allow everyday activities, maintenance and changes to your property, which don't harm its cultural heritage significance, to proceed without the need to obtain approvals under the Heritage Act 2017.

Places of worship: In some circumstances, you can alter a place of worship to accommodate religious practices without a permit, but you must [notify](#) the Executive Director of Heritage Victoria before you start the works or

activities at least 20 business days before the works or activities are to commence.

Subdivision/consolidation: Permit exemptions exist for some subdivisions and consolidations. If the subdivision or consolidation is in accordance with a planning permit granted under Part 4 of the *Planning and Environment Act 1987* and the application for the planning permit was referred to the Executive Director of Heritage Victoria as a determining referral authority, a permit is not required.

Specific exemptions may also apply to your registered place or object. If applicable, these are listed below. Specific exemptions are tailored to the conservation and management needs of an individual registered place or object and set out works and activities that are exempt from the requirements of a permit. Specific exemptions prevail if they conflict with general exemptions.

Find out more about heritage permit exemptions [here](#).

Construction dates	1926,
Architect/Designer	Burt, Harry A,
Heritage Act Categories	Registered place,
Hermes Number	625
Property Number	

---

## Extent of Registration

### AMENDMENT OF REGISTER OF HISTORIC BUILDINGS

Historic Building No. 752.

Banool, 18 Fitzroy Street, Kilmore.

To the extent of: All of the buildings and the land hatched which is included in the Register Book Certificate of Title Volume 8791, Folio 086.

[*Victoria Government Gazette* No. G45 15 November 1989 p. 2950]

*This place/object may be included in the Victorian Heritage Register pursuant to the Heritage Act 2017. Check the Victorian Heritage Database, selecting 'Heritage Victoria' as the place source.*

*For further details about Heritage Overlay places, contact the relevant local council or go to Planning Schemes Online <http://planningschemes.dpcd.vic.gov.au/>*